

103 Lloyd Street South, Fallowfield, Manchester, M14 7LF



**JP & Brimelow**  
ESTATE AGENTS

# Offers Over £240,000



\*\*\*VIDEO TOUR AVAILABLE\*\*\* A spacious and well-presented, THREE BEDROOM, mid-terrace property. Located on a quiet residential road here in Fallowfield. Situated a short drive from Manchester city centre, with good transport links on Princess parkway, close to Alexandra Park with a selection of sports activities, Hough End leisure centre in the direction of West Didsbury and Divine Mercy Primary School nearby. In brief this well-planned property consists of; an entrance hall a good-sized lounge to the front aspect benefitting from a bay-window, a dining room, and a fitted kitchen which has access out into the rear enclosed garden. Stairs leading to the first-floor landing reveal three good sized bedrooms, and a white three-piece bathroom suite. The property benefits from gas fired central heating, high ceilings, and a rear enclosed garden. OFFERED WITH NO VENDOR CHAIN.





## EPC Chart

Energy Efficiency Rating		Current	Potential
<i>Very energy efficient - lower running costs</i>			
(92 plus) <b>A</b>			
(81-91) <b>B</b>			<b>85</b>
(69-80) <b>C</b>			
(55-68) <b>D</b>		<b>59</b>	
(39-54) <b>E</b>			
(21-38) <b>F</b>			
(1-20) <b>G</b>			
<i>Not energy efficient - higher running costs</i>			
<b>England &amp; Wales</b>		EU Directive 2002/91/EC 	



Tenure: **Freehold** Council Tax Band: **A**

## Ground Floor

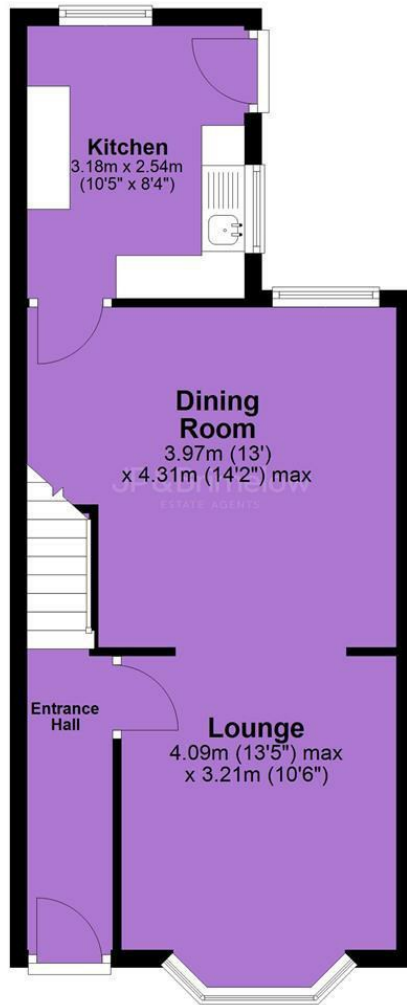

## First Floor

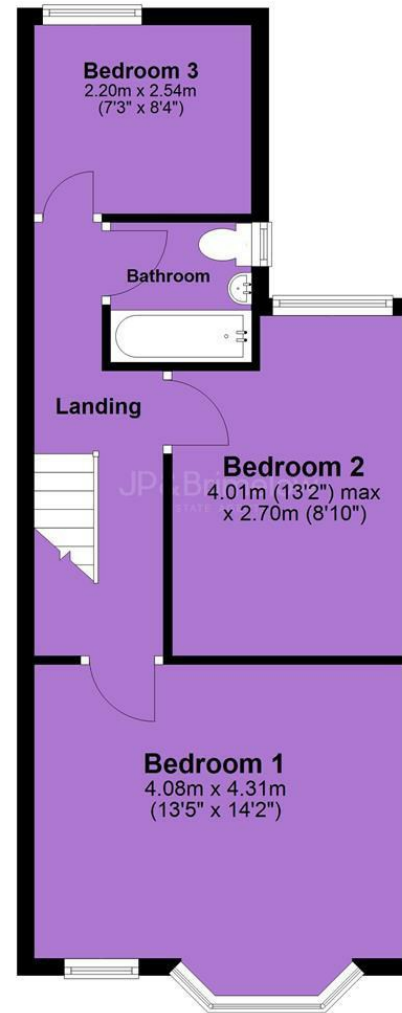

JP & Brimelow Estate Agents Ltd  
430 Barlow Moor Road, Manchester, M21 8AD  
Tel: 0161 8822233  
E: sales@jpbbrimelow.co.uk www.jpandbrimelow.co.uk



**JP & Brimelow**  
ESTATE AGENTS

NOTICE: JP & Brimelow Estate Agents Ltd for themselves and for the vendors or lessors of this property whose agents they are give notice that:

- (i) the particulars are set out as a general outline only for the guidance of intending purchasers or lessees, and do not constitute, nor constitute part of, an offer or contract;
- (ii) all descriptions, dimensions, references to the condition and necessary permissions for use and occupation, and other details are given in good faith and are believed to be correct but any intending purchasers or tenants should not rely on them as statements or representations of fact but must satisfy themselves by inspection or otherwise as to the correctness of each of them;
- (iii) no person in the employment of JP & Brimelow Estate Agents Ltd has any authority to make or give any representation or warranty whatever in relation to this property.

jpbbrimelowestateagents

@jpbbrimelow