



Priolo Road, SE7

£410,000

This beautifully designed, two bedroom garden maisonette of over 800 square feet occupies the ground floor of a terraced Victorian house. Approached via a small front garden, this charming early-Victorian property has bright and spacious accommodation with a generous reception to the rear, ideal for entertaining. A long entrance hall leads to the two double bedrooms, a well-equipped kitchen which features classic white shaker kitchen. This in turn leads to the stylish bathroom/WC and out to a superb, very well established and sunny garden, with a large annex to the rear perfect for a home office.

Priolo Road is a quiet residential street located within the

Features

- Victorian Conversion
- Annex
- Two Good-Size Bedrooms
- Private Garden
- Desirable Road
- Excellent Condition



Priolo Road, SE7



Priolo Road,
London, SE7

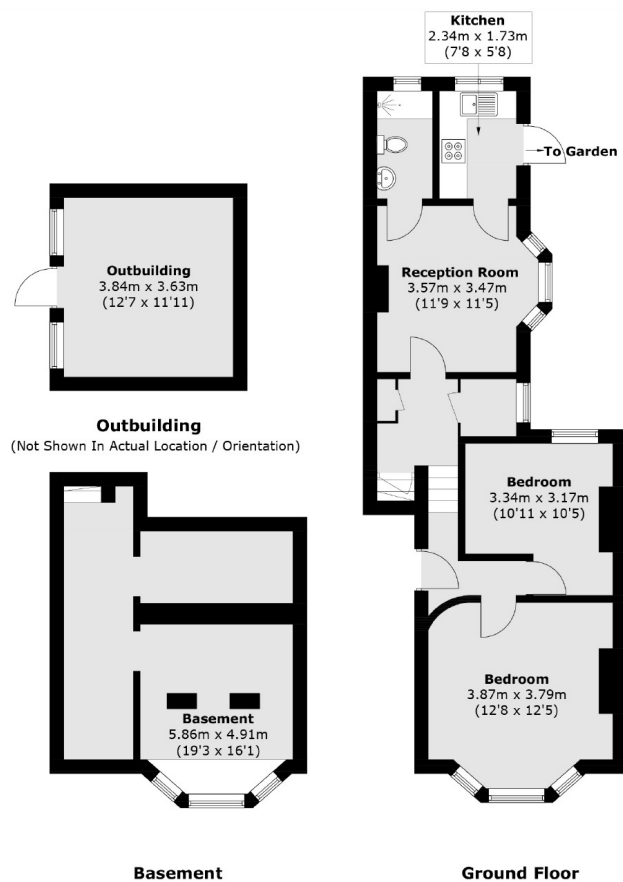

Total area (approx.): 79.8 sq. m (858.9 sq. ft)
Outbuilding : 14.1 sq. m (151.8 sq. ft)