



ROKEBY ROAD, SE4

£450,000

One bedroom
Private entrance
21' lounge
Bi-fold doors
West facing garden
Energy rating: d

@marshandparsons
marshandparsons.co.uk

MARSH &
PARSONS



ABOUT THE PROPERTY

A gorgeous one bedroom share of freehold conversion apartment with private entrance in a beautiful Victorian terrace. This beautifully presented home features a huge open plan living area with bi-fold doors onto the private west facing garden.

Luxmore Gardens is 100 yards at the back of the property with a tennis table, playground for kids and a perfect spot for a picnic close to home.

Rokeby Road is found in the Brockley Conservation Area with and equidistant to Brockley & New Cross Overground Stations and St Johns Station.



STEP INSIDE ROKEBY ROAD

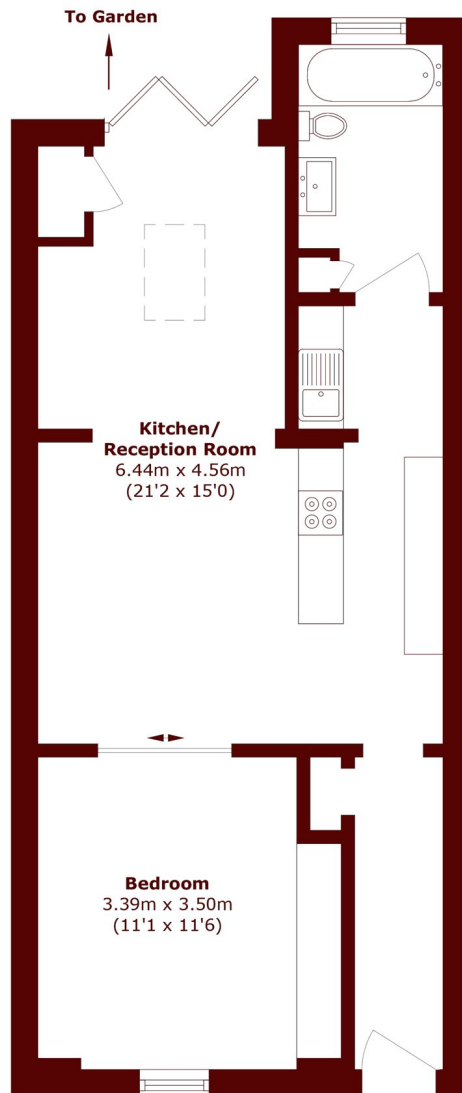

Total area (approx.): 48.8 sq. m (525.2 sq. ft)

Brockley
020 8629 8164

Energy Rating: D We aim to make our particulars both accurate and reliable. However, they are not guaranteed; nor do they form part of an offer or contract. If you require clarification on any points then please contact us, especially if you're traveling some distance to view. Please note that appliances and heating systems have not been tested and therefore no warranties can be given as to their good working order

**MARSH &
PARSONS**