



9 Greenview Drive  
Northampton, NN2 7LA



Derran Dooley  
Partnered With  
**Simpsons**  
Property Experts

A spacious two bedroom ground floor flat situated in the Links View area of NN2, offering convenient access to local amenities and transport links.

The property features two generous double bedrooms, providing excellent space for professional tenants, couples or small families. There is a bright and practical living space, fitted kitchen, and bathroom, with the added benefit of electric heating throughout.

Externally, the property enjoys access to both a private garden area as well as a communal garden, ideal for outdoor space and relaxation. There is also parking available to the front of the property for added convenience.

Perfectly positioned with a row of local shops directly adjacent, everyday essentials are right on your doorstep, making this a highly practical location.

Available immediately – early viewing highly recommended.



£950 Per month



GROUND FLOOR

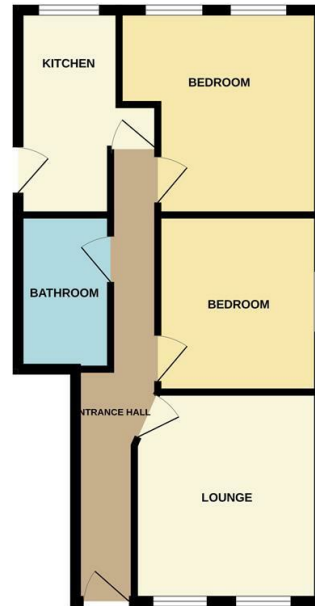

Whilst every attempt has been made to ensure the accuracy of the floor plan contained here, measurements of levels, windows, doors and any other items are approximate and no responsibility is taken for any error, omission, or mis-statement. The plan is copyright to Simpson and Partners and is for illustrative purposes and should only be used as such by any prospective purchaser. The services, systems and appliances shown have not been tested and no guarantee as to their operability can be given. Made with Heliplan 12/09.

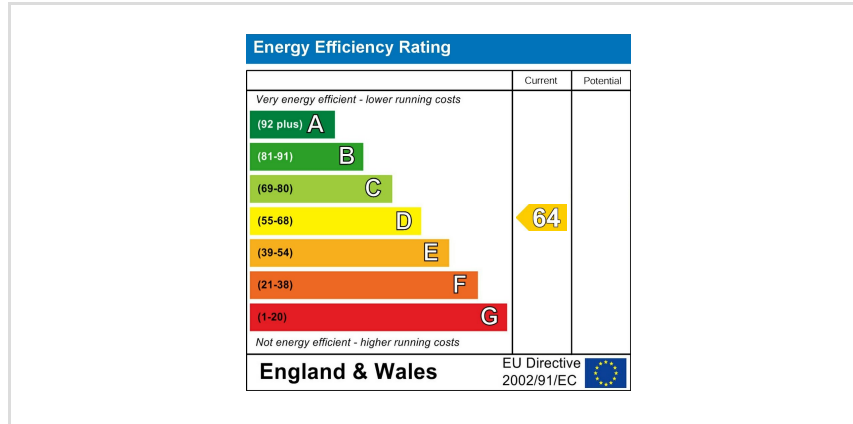



Derran Dooley  
Partnered With

**Simpsons**  
Property Experts



Tel: 01604 969706

Email: [northampton@simpsonspropertyexperts.co.uk](mailto:northampton@simpsonspropertyexperts.co.uk)

Web: [simpsonspropertyexperts.co.uk/our-locations/northampton](http://simpsonspropertyexperts.co.uk/our-locations/northampton)

