



## HIGHBANK High Street

Twyford, Winchester, SO21 1RF

**Offers over £500,000**

\*\* PLEASE NOTE THERE IS NO PARKING , NO POTENTIAL FOR PARKING AND ACCESS IS ONLY VIA THE STEPS AT THIS PROPERTY SO PLEASE TAKE THIS INTO CONSIDERATION BEFORE MAKING AN ENQUIRY \*\*

\* THERE IS AN OPTION TO RENT PARKING/GARAGE WITHIN CLOSE PROXIMITY TO THE PROPERTY \*

Located in central Twyford and elevated with attractive surroundings I am delighted to market this stunning character home.

Recently reduced and competitively priced this property has so much to offer any buyer who wants a secluded family home with many original features and beautifully presented through out.

Internally the property comprises of entrance hall, lounge to the front with log burner, dining room again with log burner and open plan kitchen/dining room overlooking the garden.

Upon the first floor the property has three well proportioned bedrooms en suite to master and family bathroom.

Outside the garden is truly wonderful with both seating and patio areas and mainly laid to lawn

- STUNNING 3 BEDROOM DETACHED HOME
- LOUNGE WITH LOG BURNER
- DINING AREA WITH LOG BURNER
- KITCHEN/BREAKFAST ROOM
- FAMILY BATHROOM AND EN SUITE TO MASTER
- ATTRACTIVE PRIVATE GARDEN
- CENTRAL VILLAGE LOCATION
- APPROX 0.2 ACRE
- COUNCIL TAX BAND E
- OFFERS OVER

### Viewing

Please contact our Luci Morgan Estate Agency Office on 07841976860 if you wish to arrange a viewing appointment for this property or require further information



## Floor Plan

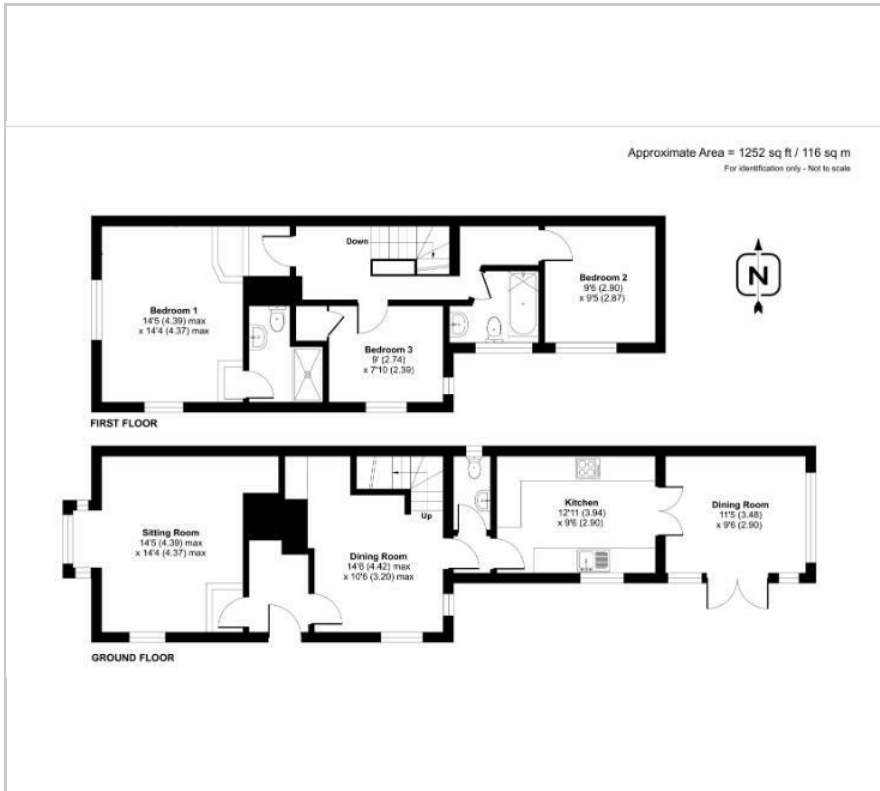

## Area Map



## Energy Efficiency Graph

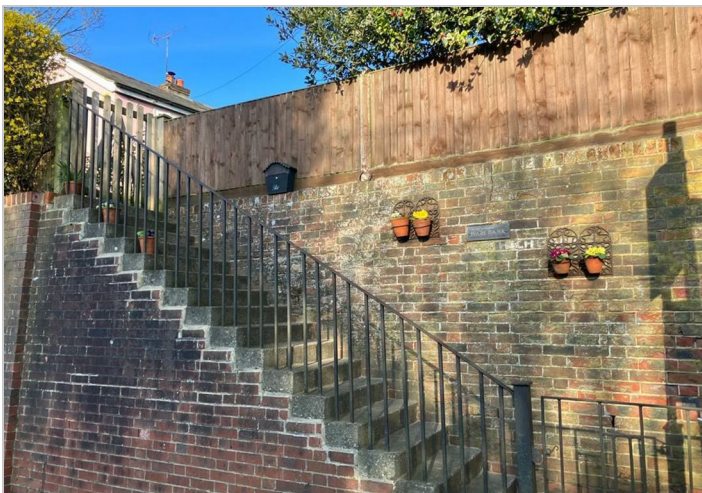
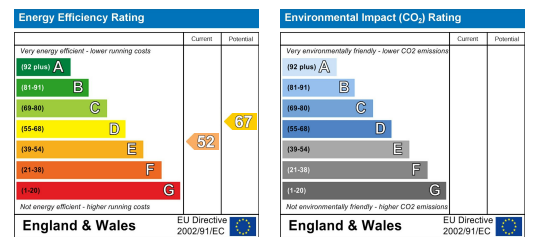

These particulars, whilst believed to be accurate are set out as a general outline only for guidance and do not constitute any part of an offer or contract. Intending purchasers should not rely on them as statements of representation of fact, but must satisfy themselves by inspection or otherwise as to their accuracy. No person in this firm's employment has the authority to make or give any representation or warranty in respect of the property.

Riverbank House 65a Bishopstoke Road, Eastleigh, Hampshire, SO50 6BF

Tel: 07841976860 Email: [luci@lucimorganestateagency.com](mailto:luci@lucimorganestateagency.com) <https://www.lucimorganestateagency.com>