



Watermans Quay  
William Morris Way, SW6

CHESTERTONS







A fantastic river facing apartment in this popular riverside development. Comprising master bedroom with an en-suite bathroom, second double bedroom with a family bathroom, fully fitted kitchen and a separate reception leading to a private balcony.

Watermans Quay is situated beside the renowned Harbour Club and is also close to Imperial Wharf which provides a number of shops, restaurants, Imperial Park green space, and Imperial Wharf over ground station which gives access to Clapham Junction (1 stop) and West Brompton (District Line, 1 stop)

- 2 bedroom river facing apartment
- Newly redecorated throughout
- Modern interior and wooden flooring throughout
- Kitchen and separate reception area
- 24 hour concierge
- Secure underground parking space

Guide Price £775,000

Energy Efficiency Rating		Current	Potential
92-100	A		
81-91	B		
69-80	C	78	79
55-68	D		
39-54	E		
21-38	F		
1-20	G		

Not energy efficient - higher running costs

England, Scotland & Wales EU Directive 2002/91/EC

**Tenure:** Share of Freehold 963 years  
**Service Charge:** £6000 P/A approx.  
**Ground Rent:** £50 P/A approx.  
**Local Authority:** Hammersmith & Fulham  
**Council Tax Band:** G

**Chestertons Fulham Road Sales**

654 Fulham Road  
 Fulham  
 London  
 SW6 5RU

fulham@chestertons.co.uk  
 020 7384 9898



## Watermans Quay, SW6

Approximate gross internal area  
73.76 sq m / 794 sq ft

Key :  
CH - Ceiling Height

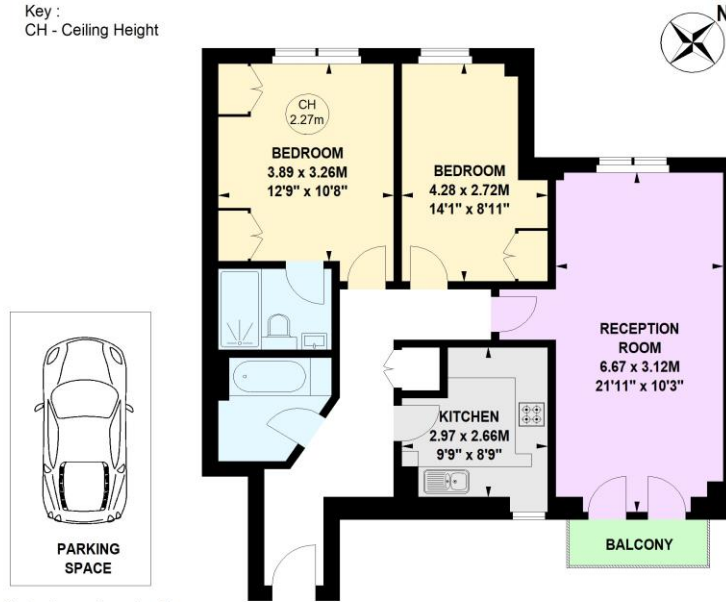

(Not shown in actual  
location / orientation)

### Fourth Floor

The floor plan is not to scale and measurements and areas shown are approximate and therefore should be used for illustrative purposes only. The plan has been prepared in accordance with the RICS code of Measuring Practice and whilst we have confidence in the information produced, it must not be relied on. If there is any aspect of particular importance, you should carry out or commission your own inspection of the property.