



WESTMORLAND HOUSE DURDHAM PARK,
BRISTOL, BS6 6XH

GOODMAN
& LILLEY



A PARTICULARLY SPACIOUS AND LIGHT 3 DOUBLE BEDROOM SEVENTH FLOOR APARTMENT IN WESTMORLAND HOUSE, DURDHAM PARK, WITH BREATH-TAKING VIEWS OVER THE DURDHAM DOWNS AND AS FAR AS BATH.

Accommodation

The entrance hall has built in storage and leads to 3 double bedrooms, each with built-in wardrobes and stunning views.

The family bathroom is tiled throughout with a white suite with shower over bath.

The 25ft 6 x 12ft 8 triple aspect lounge/diner has sliding doors leading to the private sun terrace.

There is a 17ft 2 x 6ft 6 separate kitchen with scope to update and/or open up to the living room.

Gardens

The generously proportioned communal lawned gardens are well-maintained and easily accessible.

Parking

The apartment has a secure allocated parking space, visitor parking and is set within the Residents Parking Zone.

-
- Westmorland House, Durdham Park
 - 3 double bedrooms
 - Private Sun Terrace
 - Well-maintained Communal Gardens
 - 2 lifts
 - Seventh Floor Apartment
 - Large Lounge/Diner
 - Secure Allocated Parking Space
 - Visitor Parking And Residents Parking Zone
 - No Chain



OFFERS IN EXCESS OF £325,000



Seventh Floor

Approx. 105.7 sq. metres (1137.6 sq. feet)

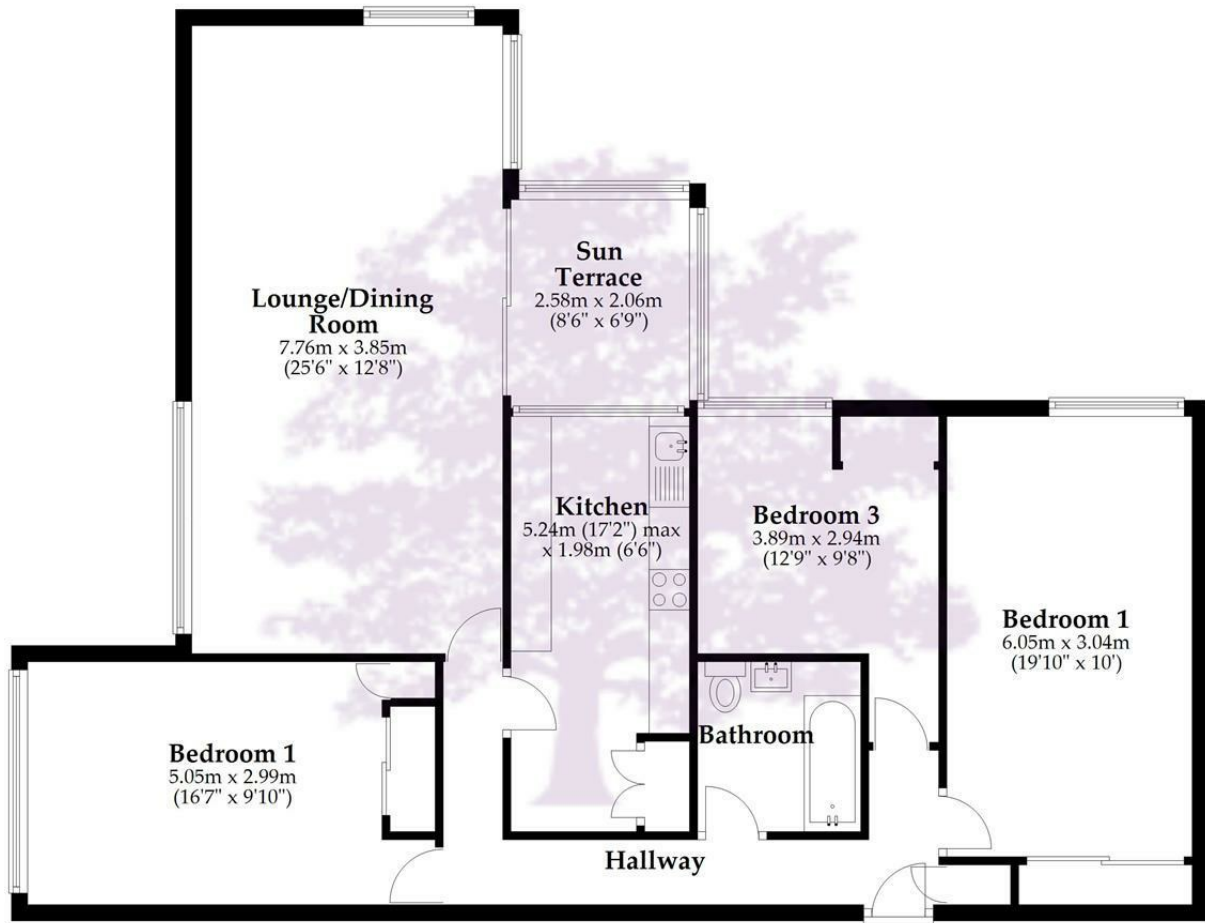

Total area: approx. 105.7 sq. metres (1137.6 sq. feet)

Whilst every attempt has been made to ensure accuracy of the floor plan all measurements are approximate and no responsibility is taken for any error, omission or measurement.

Plan produced using PlanUp.

HENLEAZE - 0117 2130777
henleaze@goodmanlilley.co.uk

PORTISHEAD - 01275 430440
sales@goodmanlilley.co.uk

SHIREHAMPTON - 0117 2130333
shire@goodmanlilley.co.uk

Zoopla.co.uk

rightmove



WWW.GOODMANLILLEY.CO.UK

These particulars are for general guidance only. They do not form or constitute any part of an offer or contract. Goodman & Lilley has not carried out structural surveys of the property. The services, appliances or specific fittings mentioned in these details have not been tested. Every attempt is made to ensure accuracy, however all photographs, measurements, floor plans and distances are for illustrative purposes only. They must not be relied upon when purchasing carpets and or other fixtures & fittings. Lease details, service charges and ground rents are given as a guide only. They should be checked and confirmed by a licensed solicitor prior to exchange of contracts. The copyright of all details, photographs and floor plans remain exclusive to Goodman & Lilley.