



Westbourne House
Richmond Road, TW1





We are delighted to present this charming ground floor flat situated in a period building in a sought-after location. This property boasts two bedrooms, a spacious living area, a fully equipped kitchen, and a stylish bathroom. The flat also benefits from a communal garden, perfect for enjoying outdoor space in the heart of town. The property's layout is ideal for those seeking a lateral living arrangement, providing a comfortable and convenient living experience. With its purpose-built design and well-maintained features, this flat offers a blend of classic elegance and contemporary convenience. Don't miss the opportunity to make this property your new home. Contact us today to arrange a viewing and experience the charm of this period yet modern flat for yourself.

- Two Bedrooms
- Separate Kitchen
- Garage
- Close to Twickenham Station

£2,600 pcm

Additional tenant charges apply (fees apply to non-AST tenancies only)
 Tenancy Agreement Fee: £300
 References per Tenant/Guarantor: £60
 Inventory check (approx. £100 – £250 inc. VAT)
chestertons.co.uk/property-to-rent/applicable-fees

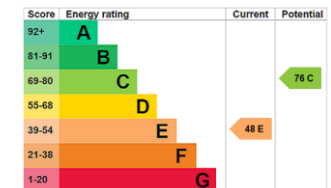

Minimum Term: 12 months
Deposit Required: £3,000.00
Local Authority: Richmond upon Thames
Council Tax Band: D
EPC Rating: E

Chestertons Richmond Lettings

23a Friars Stile Road
 Richmond
 Surrey
 TW10 6NH

richmondlettingsusers@chestertons.co.uk
 02037583333

Westbourne House, TW1

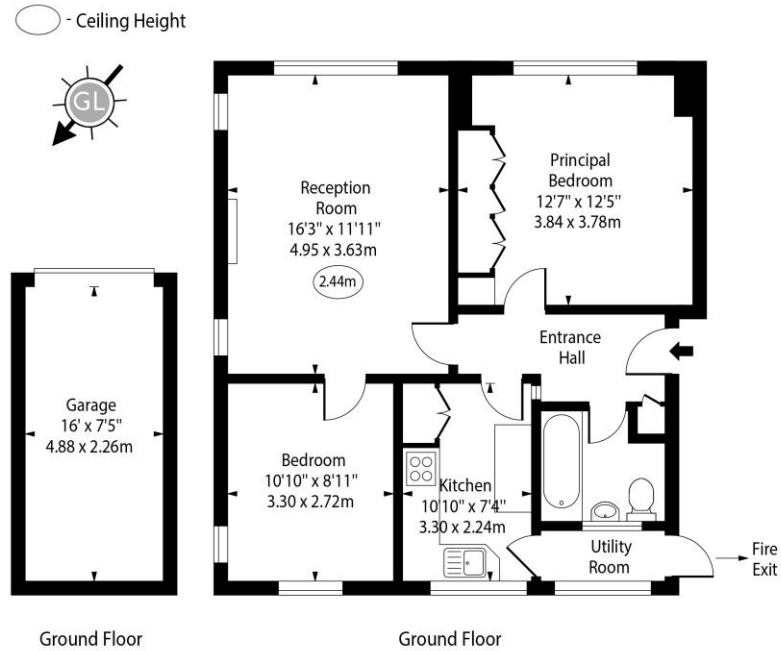

Approx Gross Internal Area 670 Sq Ft - 62.24 Sq M
(Excluding Garage)

Every attempt has been made to ensure the accuracy of the floor plan shown.
However, all measurements, fixtures, fittings, and data shown are approximate interpretations and
for illustrative purposes only. Measured according to the RICS. Not To Scale.
www.goldlens.co.uk
Ref. No. 031871E

