



Bloomfield Road, N6

£550,000

A light filled two bedroom, first floor flat in a small purpose built block, with a separate kitchen and reception room. Ideal as a first time buy or pied-a-terre. Viewings are advised.

Close to Highgate Woods and the local underground station, there is easy access to Highgate Village and a range of local stores along Archway Road.

Features

- Two Double Bedrooms
- Reception Room
- Kitchen
- Bathroom
- Premium Location
- Small Communal Garden

Bloomfield Road, London, N6

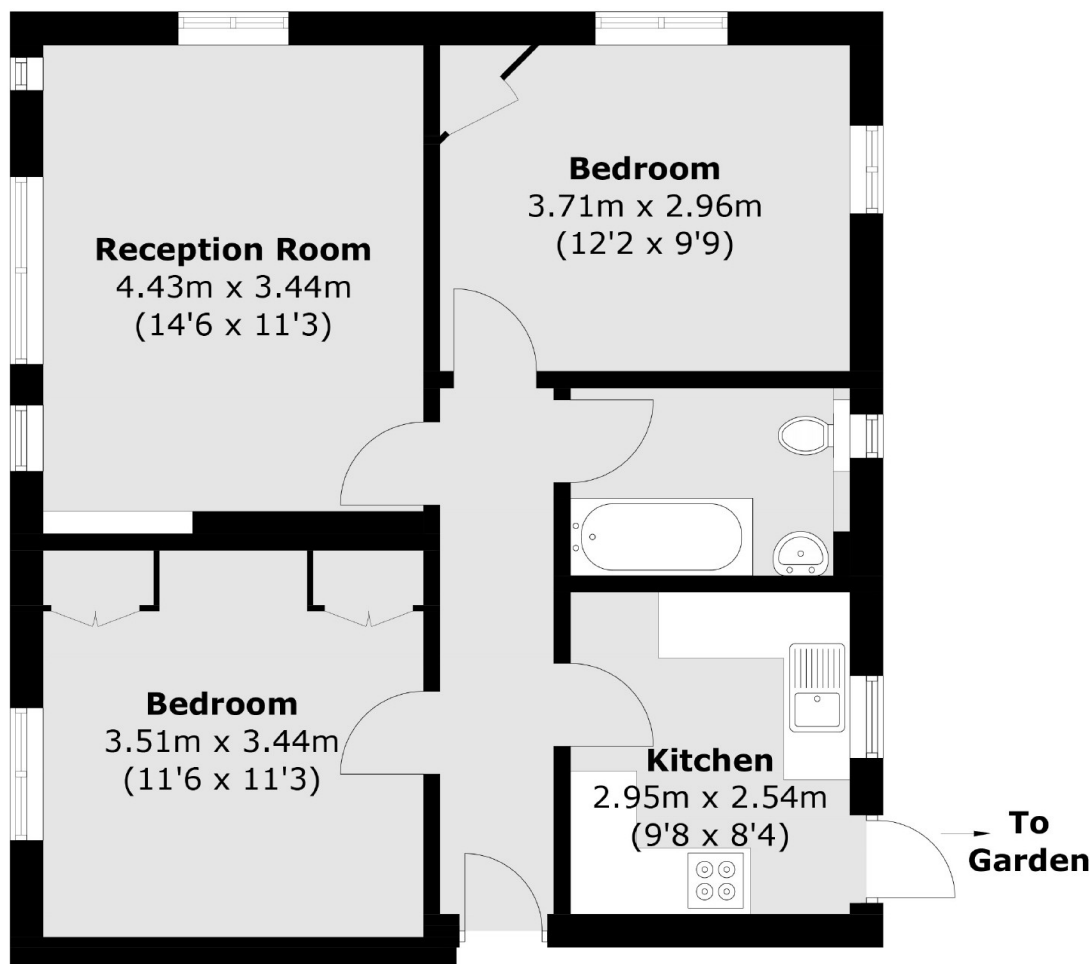

Total area (approx.): 60.2 sq. m (648.0 sq. ft)