



Oxley Square, E3

£2,300 Per week

A split level two double bedroom apartment set within a modern development offering 24 hour concierge, communal roof terrace and residents' only gymnasium with a patio area.

With on-site Sainsbury's, Pharmacy and Gym this development is across the road from a great gastro restaurant and Bromley by Bow underground station.

Features

- Two Double Bedroom
- Split Level
- Open Plan
- Gated Complex
- On-site Gym
- Concierge

Oxley Square, London, E3

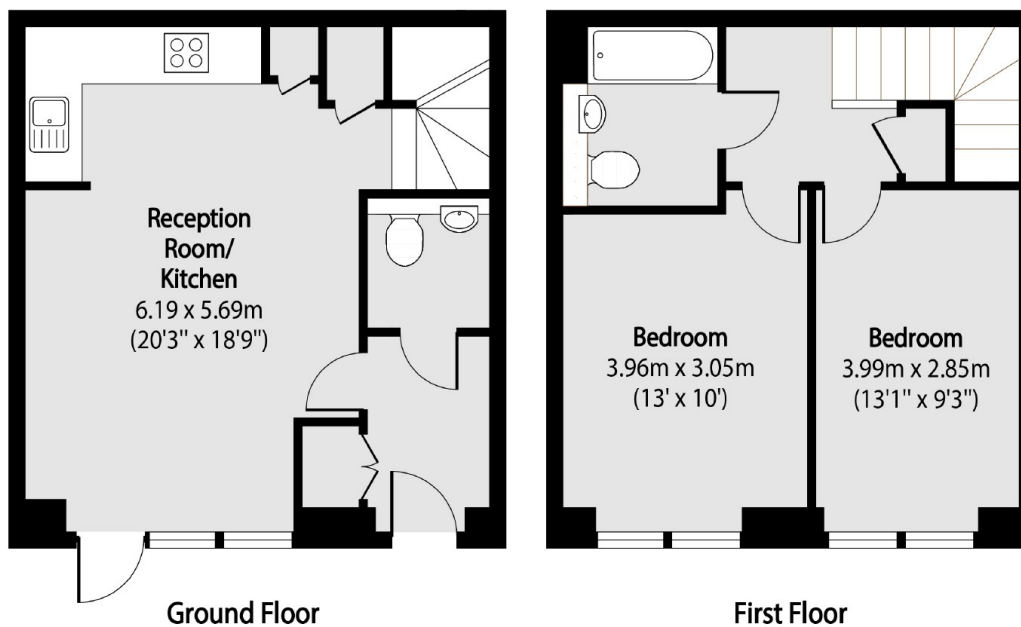

Total area (approx): 69.29 sq m (745 sq. ft)