

Westmount Estates



Chalkstone Close, Welling, DA16 3DJ

£1,100 Per Month

Westmount Estates are delighted to present this recently decorated one-bedroom ground floor apartment, ideally positioned for commuters seeking modern, low-maintenance living.

The property offers bright and spacious accommodation throughout, benefiting from excellent natural light. It comprises a generous living room opening into a modern fitted kitchen, a well-proportioned double bedroom, and a contemporary bathroom suite.

Further benefits include designated parking, ground floor access, and excellent transport links providing convenient access to surrounding areas and Central London.

The property is available for immediate occupation.

ENTRANCE



BATHROOM



LIVING ROOM



KITCHEN



DESIGNATED PARKING



BEDROOM



Floor Plan

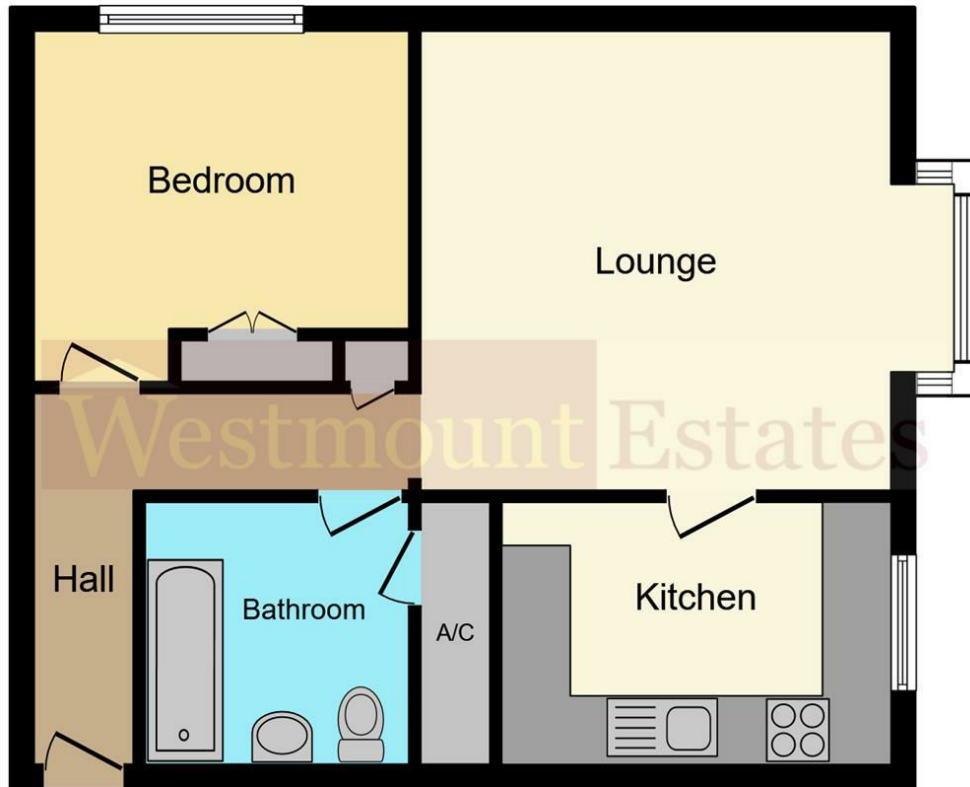

Floor Plan

This floor plan is for illustrative purposes only. It is not drawn to scale. Any measurements, floor areas (including any total floor area), openings and orientations are approximate. No details are guaranteed, they cannot be relied upon for any purpose and do not form any part of any agreement. No liability is taken for any error, omission or misstatement. A party must rely upon its own inspection(s). Powered by www.Propertybox.io

Area Map

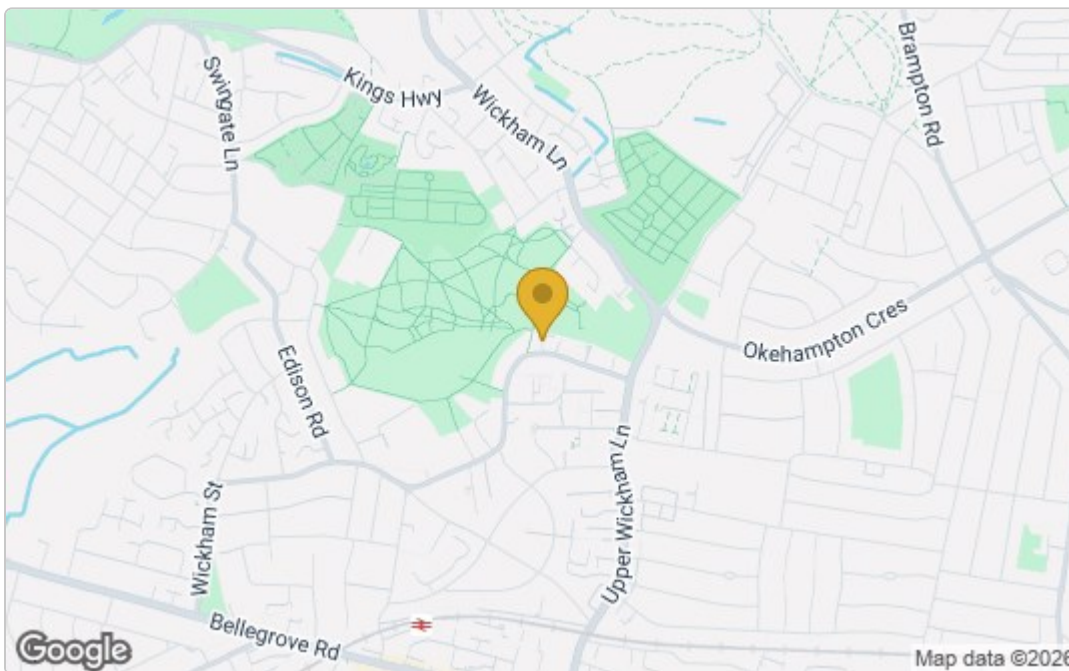

Energy Efficiency Graph

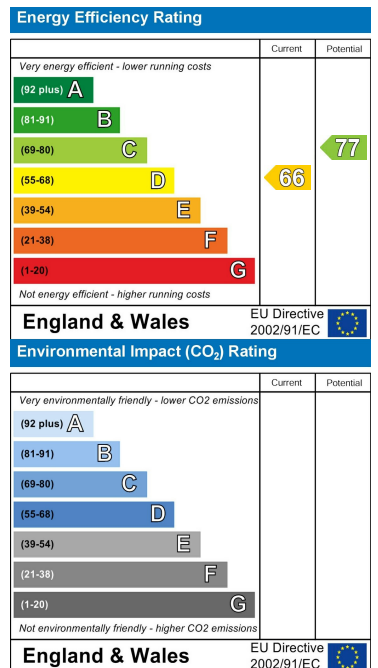

These particulars, whilst believed to be accurate are set out as a general outline only for guidance and do not constitute any part of an offer or contract. Intending purchasers should not rely on them as statements of representation of fact, but must satisfy themselves by inspection or otherwise as to their accuracy. No person in this firm's employment has the authority to make or give any representation or warranty in respect of the property.