



## **5 Eden Street, Oswestry, Shropshire, SY11 1QY**

### **Monthly Rental Of £700**

A 2 bedroom mid terrace property with accommodation including Living Room, Kitchen/Dining Room, Bedroom and Bathroom on the 1st Floor, 2nd Bedroom and Store on the 2nd Floor. Courtyard Garden, CGH & DG. ZJ&B TENANT INFORMATION: Tenancies granted subject to contract following satisfactory credit, referencing and right to rent checks. 1 weeks holding fee applicable to successful applicants.

Deposit: 5 weeks rent and first month's rent payable in advance.

Rent EXCLUDES utilities and council tax. Smoking is prohibited in the Property.



5 Eden Street, Oswestry, Shropshire, SY11 1QY



Council Tax Band A

Monthly Rental Of £700  
per calendar month

Deposit - £807.00  
5 weeks rent

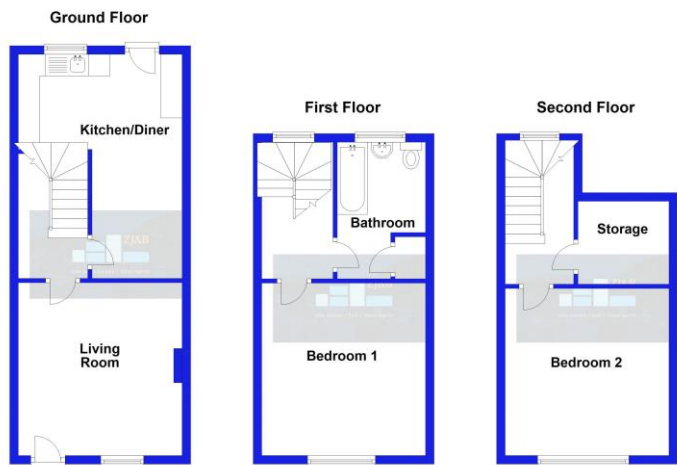

We accept no responsibility for any mistake or inaccuracy contained within the floorplan. The floorplan is provided as a guide only and should be taken as an illustration only. The measurements, contents and positioning are approximations only and provided as a guide only and not an exact replication of the property. Plan produced using PlanUp.

Find an energy certificate (f) English | Cymraeg

**Energy performance certificate (EPC)**

5, Eden Street  
OSWESTRY, SY11 1QY

Energy rating: D

Valid until: 21 May 2030

Property type: Mid-terrace house

Total floor area: 96 square metres

**Rules on letting this property**

Properties can be let if they have an energy rating from A to E.

You can read [guidance for landlords on the regulations and exemptions](#) [here](#) [or](#) [visit the Energy Performance Certificate \(EPC\) website](#)

**Energy rating and score**

This property's energy rating is D. It has the potential to be B.

[See how to improve this property's energy efficiency](#)

<https://www.energy-certificates.gov.uk/energy-certificates/00017436-0122-0006-0003>

FLOOR PLANS FOR GUIDANCE ONLY