



Fernleigh Court

REDLAND

APPROXIMATE FLOOR AREA
83 SQM / 888 SQFT



SECOND FLOOR

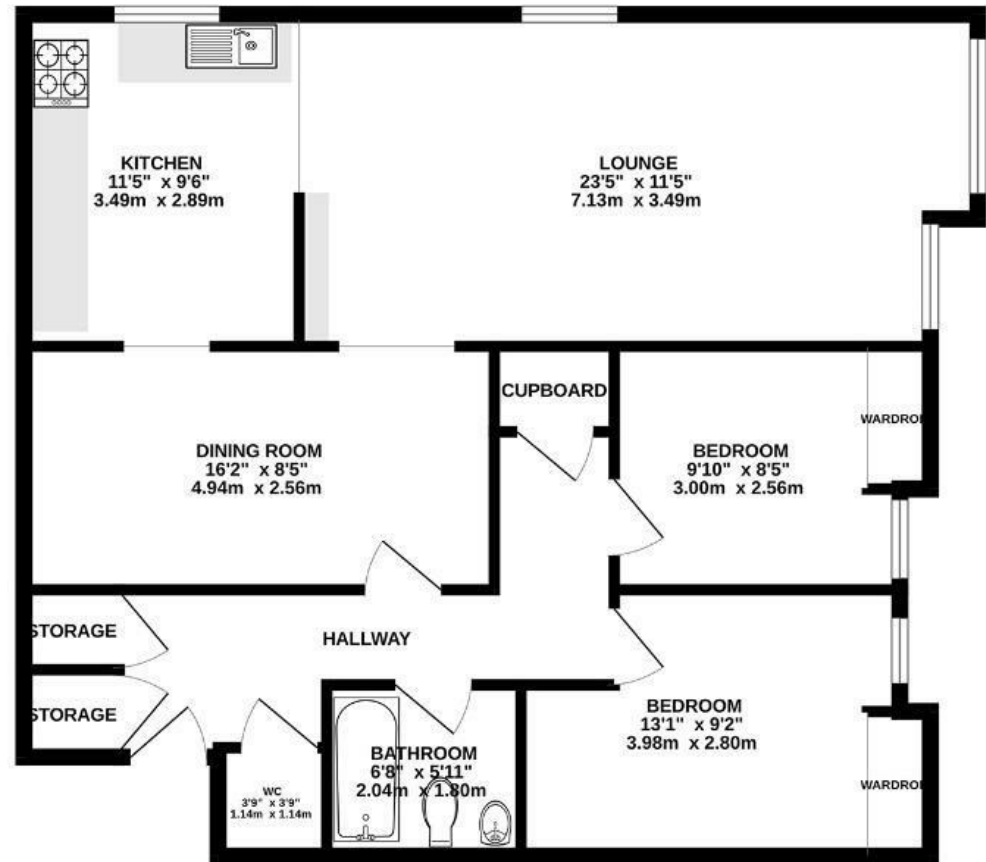

Boardwalk

Fernleigh Court

, BRISTOL



£400,000



2 Bedrooms



BS6 6YE



1 Bathrooms

"Our home has been such a special place to us over the past six years. We moved here during lockdown, and one of our favourite memories is sitting on the bay window seat with a drink, watching the sun set over Bristol; it's a view that never gets old. It feels wonderfully secluded, calm and quiet, yet you still have everything Bristol has to offer right on your doorstep. We do not doubt that whoever comes next will fall in love with it just as we did."

