



Connells

Robert Street
Dudley



Property Description

The property features an entrance porch that leads into a spacious hallway, complemented by a convenient downstairs cloakroom. The lounge boasts a striking bay window, while the standout open-plan kitchen, dining, and family room showcases modern gloss-fitted kitchen units and integrated appliances, enhanced by bi-fold doors that open to the garden. On the first floor, there are two double bedrooms equipped with fitted wardrobes and one single bedroom, along with a stylish family bathroom. Accessed through iron gates, the exterior offers secure off-road parking on the driveway, and the rear of the property presents a low-maintenance private garden.

Entrance Porch

Double glazed entrance door to the front elevation, door to

Hallway

Stairs to first floor accommodation, double glazed window to side elevation, herringbone flooring.

Cloakroom

Suite to comprise wash hand basin, low level w.c., double glazed window to the side.

Lounge

Double glazed bay window to the front elevation, t.v point radiator.

Open Plan Kitchen /Family Room

The kitchen and dining area features a well-equipped fitted kitchen that includes an extensive selection of gloss wall and base units complemented by durable work surfaces. It is equipped with a stainless steel sink and drainer, an electric oven and hob with an extractor fan, and showcases elegant herringbone flooring. The space is enhanced by downlights and is illuminated by double-glazed windows on the side and rear, as well as double-glazed skylights. Additionally, the area opens up to the patio through double-glazed bi fold doors, creating a seamless transition between indoor and outdoor spaces.

Lounge area with feature media wall

First Floor

Landing

Double glazed window to side elevation, loft access.

Bedroom One

Double glazed bay window to the front elevation, built in wardrobes, radiator.

Bedroom Two

Double glazed window to the rear, fitted wardrobes, radiator.

Bedroom Three

Double glazed window to the front, radiator.

Bathroom

Suite to comprise paneled bath, wash hand basin, low level w.c., separate shower cubicle, double glazed window to the rear, airing cupboard, tiling, tiled floor, airing cupboard and down lights.

Outside

Front Elevation

The property is accessed through double iron gates, ensuring secure off-road parking on a tarmac driveway.

Rear Elevation

The rear garden features a low-maintenance design, incorporating a paved patio area and artificial lawn, summer house, outdoor lighting, and a gate that provides side access.







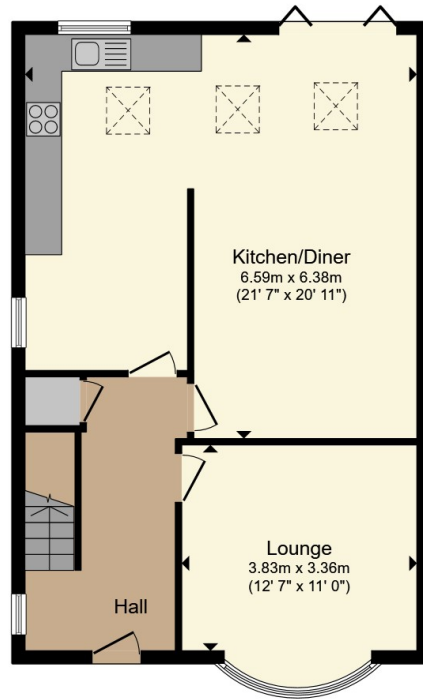

Ground Floor

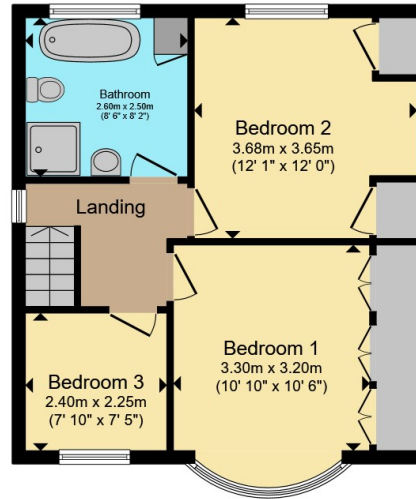

First Floor

Total floor area 111.4 m² (1,199 sq.ft.) approx

This floor plan is for illustrative purposes only. It is not drawn to scale. Any measurements, floor areas (including any total floor area), openings and orientation are approximate. No details are guaranteed, they cannot be relied upon for any purpose and they do not form part of any agreement. No liability is taken for any error, omission or misstatement. A party must rely upon its own inspection(s). Powered by www.propertybox.io



To view this property please contact Connells on

T 01384 214 770
E dudley@connells.co.uk

4 & 5 Stone Street
 DUDLEY DY1 1NS

EPC Rating: Council Tax
 Awaited Band: D

Tenure: Freehold

view this property online connells.co.uk/Property/DUD314853



1. MONEY LAUNDERING REGULATIONS Intending purchasers will be asked to produce identification documentation at a later stage and we would ask for your co-operation in order that there will be no delay in agreeing the sale. 2. These particulars do not constitute part or all of an offer or contract. 3. The measurements indicated are supplied for guidance only and as such must be considered incorrect. Potential buyers are advised to recheck measurements before committing to any expense. 4. We have not tested any apparatus, equipment, fixtures, fittings or services and it is in the buyers interest to check the working condition of any appliances.

Connells Residential is registered in England and Wales under company number 1489613, Registered Office is Cumbria House, 16-20 Hockliffe Street, Leighton Buzzard, Bedfordshire, LU7 1GN. VAT Registration Number is 500 2481 05.

See all our properties at www.connells.co.uk | www.rightmove.co.uk | www.zoopla.co.uk

Property Ref: DUD314853 - 0005