



Stowe Road, W12

£550,000



- Three Bedrooms
- Private Garden
- No Onwards Chain
- Lower Ground Floor
- Potential To Modernise
- Quiet Location

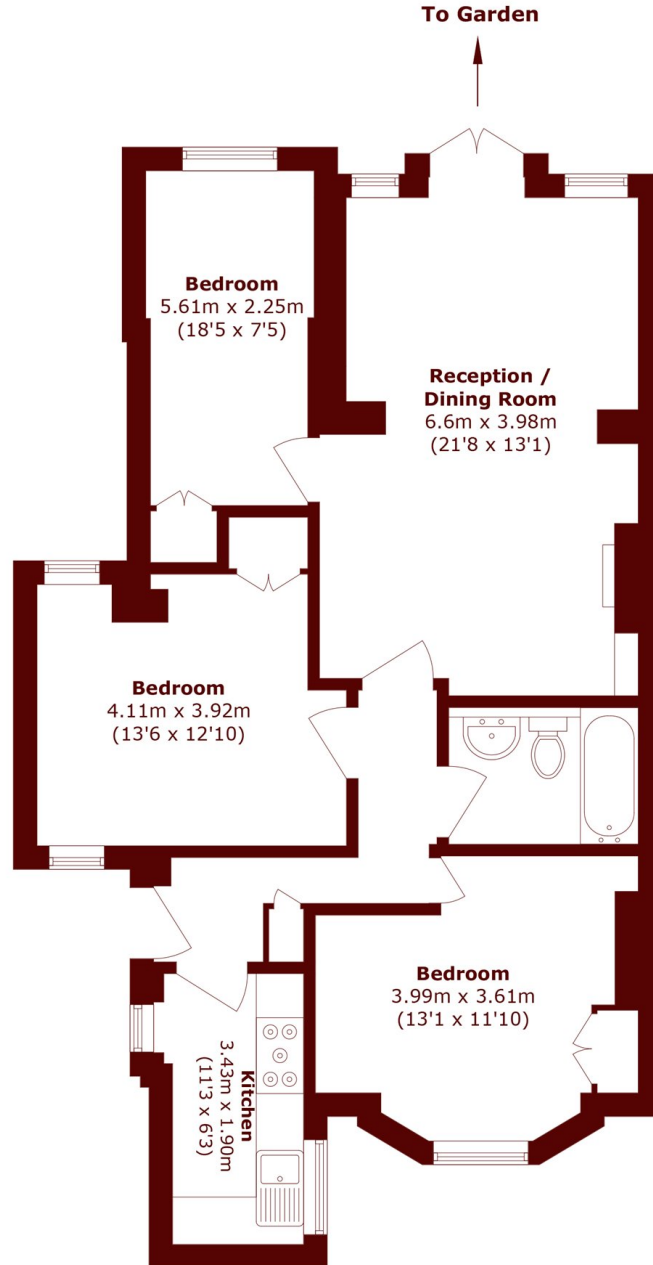

Total area (approx.): 80.2 sq. m (863.2 sq. ft)

Marsh & Parsons Brook Green

107-109 Shepherds Bush
Road, London, W6 7LP
020 7605 7765