

# ROYSTON & LUND



## 6 Kilwardby House, Kilwardby Street, Ashby De La Zouch

Guide Price £305,000

- GUIDE PRICE £305,000
- En Suite and Family Shower Room
- Original Feature Throughout
- Annual Management Fee will apply - to be Confirmed
- Grade II Listed Two Bedroom Second Floor Apartment
- Lounge with Original Fireplace
- 999 Year Leasehold
- Access Via an Original Spiral Staircase with Lantern Window
- Large Kitchen/Diner/Utility with Large Original Bay Window
- EPC and Council Tax TBC

4 Bath Street, Corner, LE65 2FH  
01530 443 443

ashbysales@royston-lund.co.uk  
<https://www.royston-lund.co.uk/>

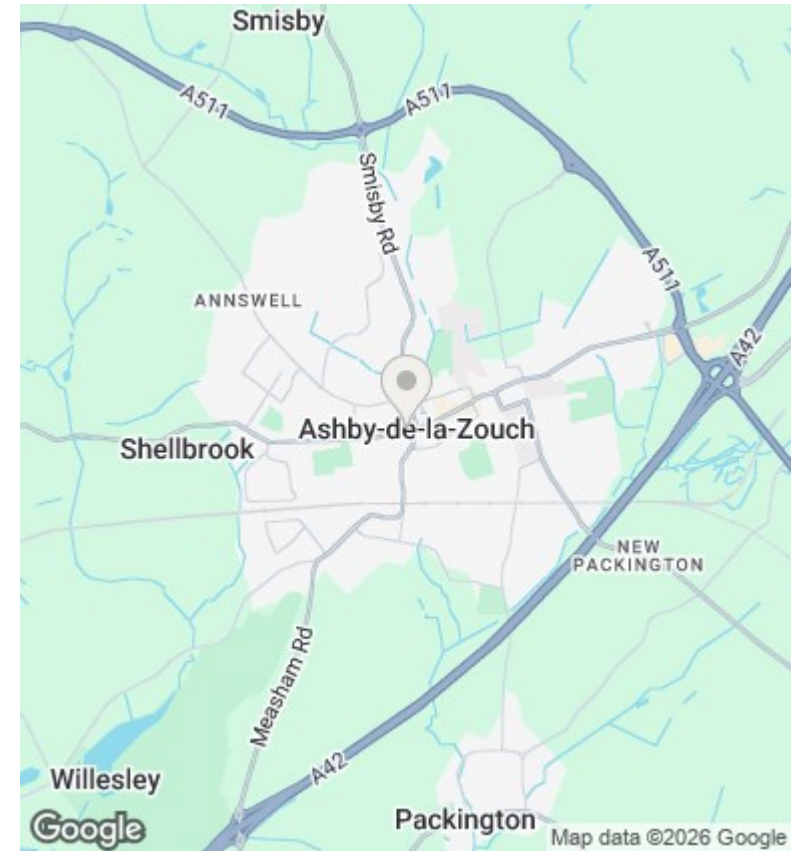
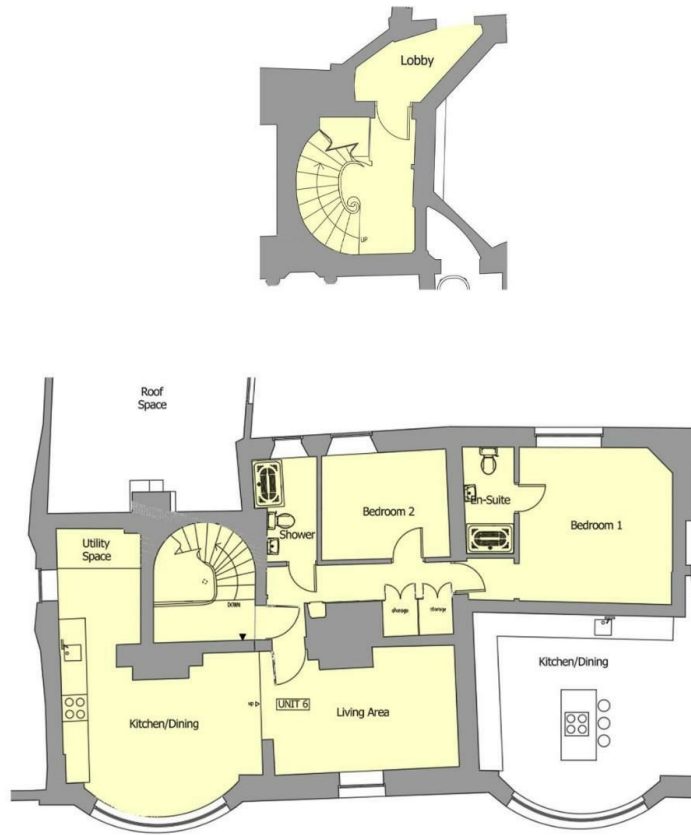

## Directions

## Viewings

Viewings by arrangement only. Call 01530 443 443 to make an appointment.

## Council Tax Band

## EPC Rating:

C

Energy Efficiency Rating		
	Current	Potential
<i>Very energy efficient - lower running costs</i>		
(92 plus) <b>A</b>		
(81-91) <b>B</b>		
(69-80) <b>C</b>	80	80
(55-68) <b>D</b>		
(39-54) <b>E</b>		
(21-38) <b>F</b>		
(1-20) <b>G</b>		
<i>Not energy efficient - higher running costs</i>		
<b>England &amp; Wales</b>	EU Directive 2002/91/EC	