



Connells

Monks Way  
Bournemouth



## Property Description

Welcome to Monks Way, Bearwood, BH11.

Starting with a practical entrance porch, the ground floor opens into a bright and inviting living area featuring a charming alcove, perfect for a custom media unit or integrated shelving. Leading to the kitchen with integrated oven and facing the southerly aspect rear garden.

The first floor boasts two bedrooms with build in wardrobe to the master and the family bathroom. The property is beautifully maintained throughout, ensuring a move-in-ready experience for first-time buyers or young families. The highlight of the home is the attractive rear garden. Boasting a southerly aspect, the outdoor space enjoys sun throughout the day and has been thoughtfully landscaped.

### Entrance Hall

Gated entrance with storage cupboard and door to front.

### Lounge

Laminated flooring with double glazed front aspect window, Tv point and radiator.

### Kitchen

Rear aspect double glazed window, range of wall and base units, stainless steel sink with mixer tap and drainer, 4 ring induction hob with extractor hood and fan over and cooker below, tiled splashback and space for dishwasher, fridge freezer and washing machine.

### Bedroom 1

Front aspect double glazed window, carpeted with freestanding wardrobe and mirrored doors and radiator.

## Bedroom 2

Rear aspect double glazed window, carpeted and radiator.

## Bathroom

Double glazed rear aspect window, part tiled walls, low level WC and radiator.

## Front Garden

Gated with patio and storage cupboard.

## Rear Garden

Enclosed rear garden, part patio and part stones with rear gated access.







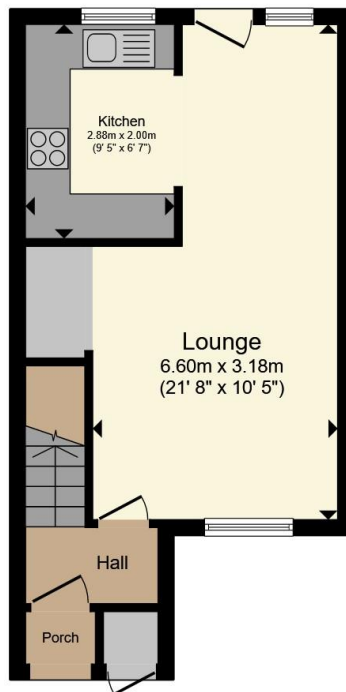

**Ground Floor**

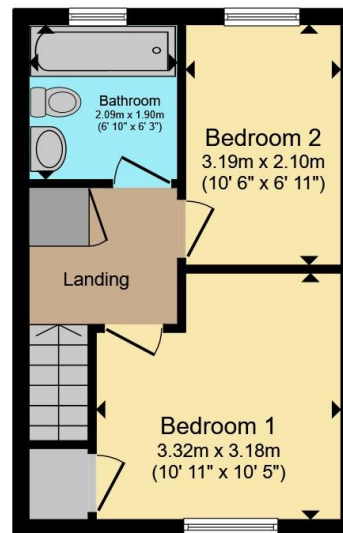

**First Floor**

Total floor area 59.3 m<sup>2</sup> (638 sq.ft.) approx

This floor plan is for illustrative purposes only. It is not drawn to scale. Any measurements, floor areas (including any total floor area), openings and orientation are approximate. No details are guaranteed, they cannot be relied upon for any purpose and they do not form part of any agreement. No liability is taken for any error, omission or misstatement. A party must rely upon its own inspection(s). Powered by [www.propertybox.io](http://www.propertybox.io)



To view this property please contact Connells on

**T 01202 525 411**  
**E [winton@connells.co.uk](mailto:winton@connells.co.uk)**

689 Wimborne Road  
 BOURNEMOUTH BH9 2AT

EPC Rating: C Council Tax Band: B

Tenure: Freehold

**view this property online [connells.co.uk/Property/WIN307728](http://connells.co.uk/Property/WIN307728)**



1. MONEY LAUNDERING REGULATIONS Intending purchasers will be asked to produce identification documentation at a later stage and we would ask for your co-operation in order that there will be no delay in agreeing the sale. 2. These particulars do not constitute part or all of an offer or contract. 3. The measurements indicated are supplied for guidance only and as such must be considered incorrect. Potential buyers are advised to recheck measurements before committing to any expense. 4. We have not tested any apparatus, equipment, fixtures, fittings or services and it is in the buyers interest to check the working condition of any appliances.

Connells Residential is registered in England and Wales under company number 1489613, Registered Office is Cumbria House, 16-20 Hockliffe Street, Leighton Buzzard, Bedfordshire, LU7 1GN. VAT Registration Number is 500 2481 05.

**See all our properties at [www.connells.co.uk](http://www.connells.co.uk) | [www.rightmove.co.uk](http://www.rightmove.co.uk) | [www.zoopla.co.uk](http://www.zoopla.co.uk)**

Property Ref: WIN307728 - 0003