



GRAFTON ROAD, W3

£425,000

Poets Corner
Private Garden
Long Lease
Period Property
Ground Floor

@marshandparsons
marshandparsons.co.uk

MARSH &
PARSONS

ABOUT THE PROPERTY

This well-presented one-bedroom property offers a high-quality finish throughout, featuring a spacious open-plan kitchen and living area with a wood burner, a generous bedroom with a tiled shower room, excellent storage, and a private garden. Double-height ceilings and large windows bring plenty of natural light into the space, creating a bright and open feel.









STEP INSIDE GRAFTON ROAD

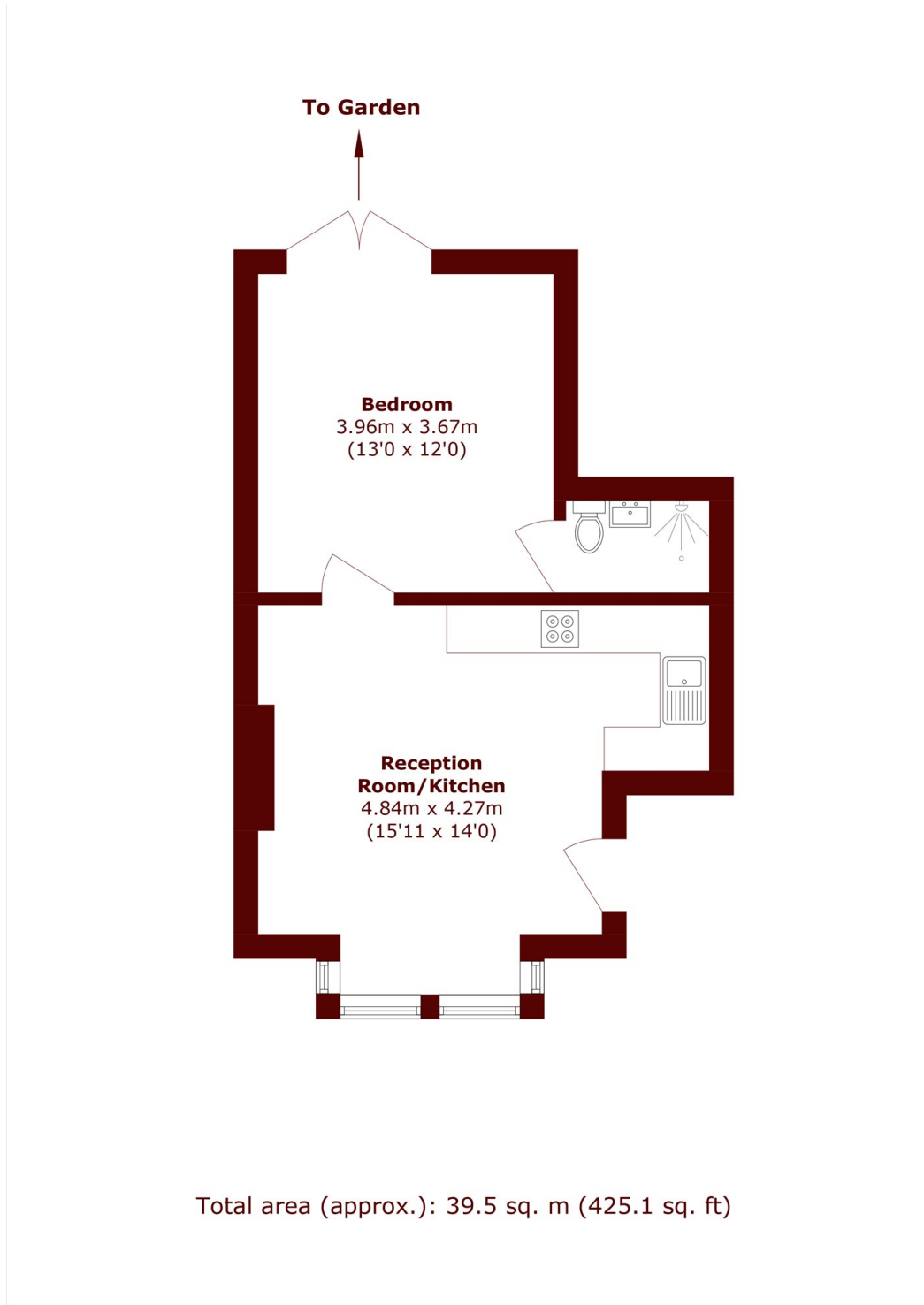

Askew Road
020 8102 0123

Energy Rating: We aim to make our particulars both accurate and reliable. However, they are not guaranteed; nor do they form part of an offer or contract. If you require clarification on any points then please contact us, especially if you're traveling some distance to view. Please note that appliances and heating systems have not been tested and therefore no warranties can be given as to their good working order

**MARSH &
PARSONS**