





7 Thomas Hardy Drive, Shaftesbury, Dorset, SP7 8SP

What 3 Words: ///crescendo.star.wildfires



Key Features

- Two Bedroom Terraced Home
- Sitting Room with Conservatory
- Two Good Sized Bedrooms with Fitted Wardrobes
- Enclosed Rear Garden
- Ample On Road Parking
- Close to Shops & Schools

Tenure: Freehold | EPC Rating: C | Council Tax Band: C |

Services: Mains Services are connected

Location

The North Dorset Saxon hilltop market town of Shaftesbury is famed for the iconic cobbled street of Gold Hill and rich history going back to the times of King Alfred. Shaftesbury is a delightful community orientated town with an attractive and bustling High Street that provides most everyday requirements including a farmer's market, cafés, charity shops, various retail shops and a cottage hospital. Families are drawn to this area by the quality of life and excellent choice of state and independent schools including Port Regis, Clayesmore, Sandroyd and Bryanston amongst many others. Shaftesbury also offers several ways to explore the stunning countryside and traditional English villages of the Blackmore Vale, Cranborne Chase and Wiltshire Downs with their many miles of public footpaths and bridleways.

Inside the Home

A well presented two bedroom terraced house, situated in a quiet and popular cul-de-sac in Shaftesbury. The property is located only a short walk from shops, schools and a park.

The property is entered into a hallway with a cloakroom, and the kitchen on the right with space for appliances and plenty of fitted cupboards. At the rear of the property is the spacious sitting/dining room, with a door opening into the conservatory which overlooks the rear garden.

Upstairs, there are two good sized bedrooms which both benefit from a fitted wardrobe, as well as a modern shower room. The landing also has a walk-in cupboard providing plenty of storage space.

Outside Space

The property enjoys a private and low maintenance rear garden, which is laid out gravel. It benefits from a storage shed as well as a rear access gate leading to the neighbouring road.

Shall We Book You in For a Viewing?

Strictly by appointment only via Boatwrights Estate Agents.

12 High Street, Shaftesbury, Dorset, SP7 8JG | 01747 213106

High Street, Tisbury, Wiltshire, SP3 6LD | 01747 859359

sales@boatwrights.co.uk | www.boatwrights.co.uk

Scan to
read more
on the
property





GROUND FLOOR
34.8 sq.m. (374 sq.ft.) approx.

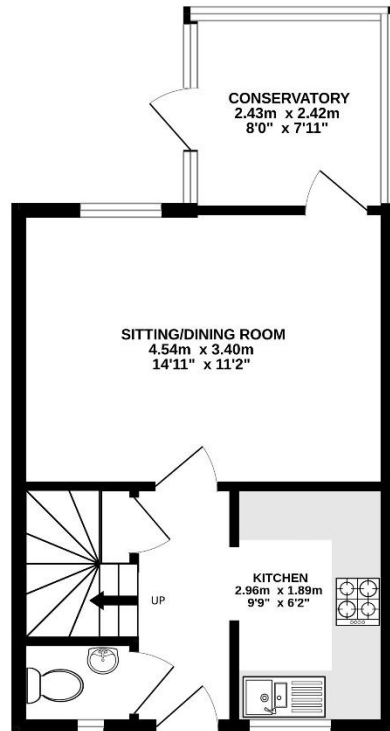

1ST FLOOR
28.9 sq.m. (311 sq.ft.) approx.

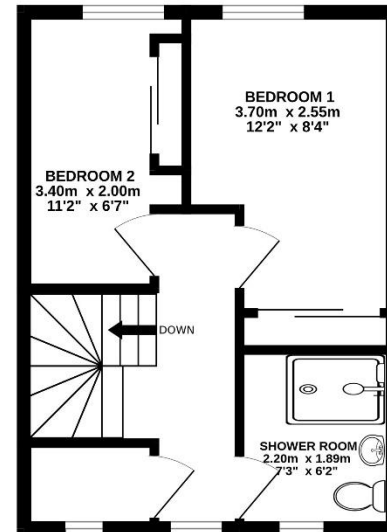

TOTAL FLOOR AREA : 63.6 sq.m. (685 sq.ft.) approx.

Whilst every attempt has been made to ensure the accuracy of the floorplan contained here, measurements of doors, windows, rooms and any other items are approximate and no responsibility is taken for any error, omission or mis-statement. This plan is for illustrative purposes only and should be used as such by any prospective purchaser. The services, systems and appliances shown have not been tested and no guarantee as to their operability or efficiency can be given.
Made with Metropix ©2026



Looking to buy or sell in North Dorset?

At Boatwrights Estate Agents, selling your home starts with trust. As your local, independent experts, we understand the value of your property and your time. Our dedicated team offers tailored marketing, expert guidance, and a personal touch to help you achieve the best possible result.

Scan here to Learn more On Boatwrights?



Important Notice

These particulars do not constitute or form part of an offer or contract, nor may they be regarded as representations. All interested parties must themselves verify their accuracy. All measurements and the proportions of the floor plans provided are approximate.

16 January 2026