





{ WARWICK GARDENS LONDON W14
£650 PER WEEK AVAILABLE 13/02/2026

Hamptons
THE HOME EXPERTS

{ THE PARTICULARS

Warwick Gardens London W14

£650 Per Week
Furnished

 2 Bedrooms
 1 Bathroom
 1 Reception

Features

- Two Bedrooms, - Family Bathroom, -
Furnished, - Fully Fitted Kitchen, - Heating
& Hot Water Included

Council Tax

Council Tax Band E

Hamptons
8 Hornton Street
Kensington, London, W8 4NW
020 7937 9372
KensingtonLettings@hamptons.co.uk
www.hamptons.co.uk

{ A DELIGHTFUL TWO BEDROOM APARTMENT WITH HIGH CEILINGS

The Property

A delightful raised ground floor two bedroom flat presented in excellent condition with good ceiling height. The flat is located on the raised ground floor of this pretty Victorian conversion, with high ceilings and stunning cornicing. The flat offers a spacious reception room, separate modern kitchen, two double bedrooms and good size bathroom. Heating & hot water are included in the rent. Well located close to Kensington High Street and offered furnished.

Location

Warwick Gardens is situated south of Kensington High Street on a beautiful residential road. A short walk from Holland Park and amenities.



WARWICK GARDENS

Approximate Gross Internal Area

688 sq. ft. (63.9 sq. m.)

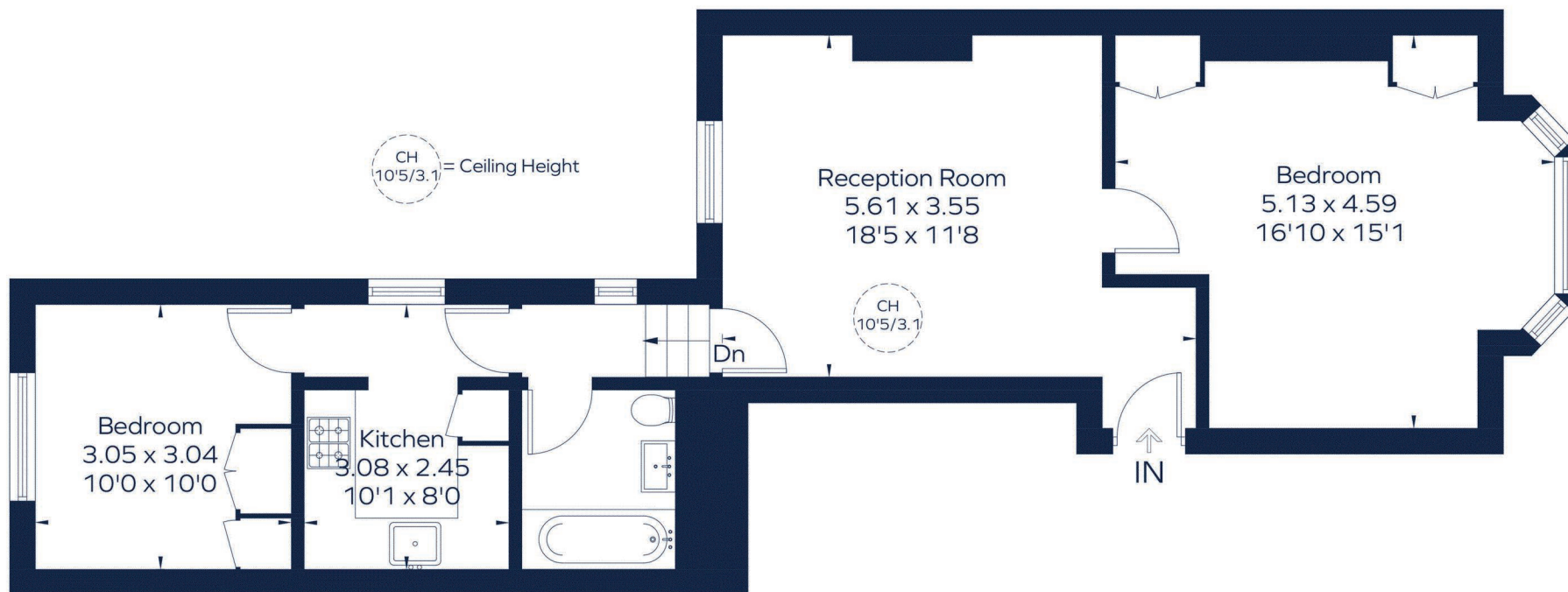

Ground Floor

This plan is for layout guidance only. Not drawn to scale unless stated. Windows and door openings are approximate. Whilst every care is taken in the preparation of this plan, please check all dimensions, shapes and compass bearings before making any decisions reliant upon them.
ID 1160094

For Clarification

We wish to inform prospective tenants that we have prepared these particulars as a general guide and they have been confirmed as accurate by the landlord. We have not verified permissions, nor carried out a survey, tested the services, appliances and specific fittings. Room sizes are approximate and measurement figures rounded: they are taken between internal wall surfaces and therefore include cupboards/shelves, etc. Accordingly, they should not be relied upon for

carpets and furnishings. It should also be noted that all fixtures and fittings, carpeted, curtains/blinds, kitchen equipment and garden statuary, whether fitted or not, are deemed removable by the landlord unless specifically itemised with these particulars. Please enquire in office or on our website for details on holding deposit and tenancy deposit figures.

