



Chepstow Road, W2

£475,000

A third floor (with lift) apartment in a Victorian conversion. With an open plan reception room and kitchen, double bedroom and a separate study, this is an ideal property for a first time buyer or investment purchase.

Chepstow Road is a tree lined residential road in Notting Hill, off Westbourne Grove with plenty of chic restaurants, shops and cafés, within close proximity to the green open spaces of Hyde Park. This property benefits from convenient transport links via Westbourne Park, Holland Park and Notting Hill Gate.

Features

- One Double Bedroom
- Separate Study
- Lift
- Victorian Conversion
- Open Plan
- Low Service Charge
- Notting Hill

Chepstow Road, London, W2

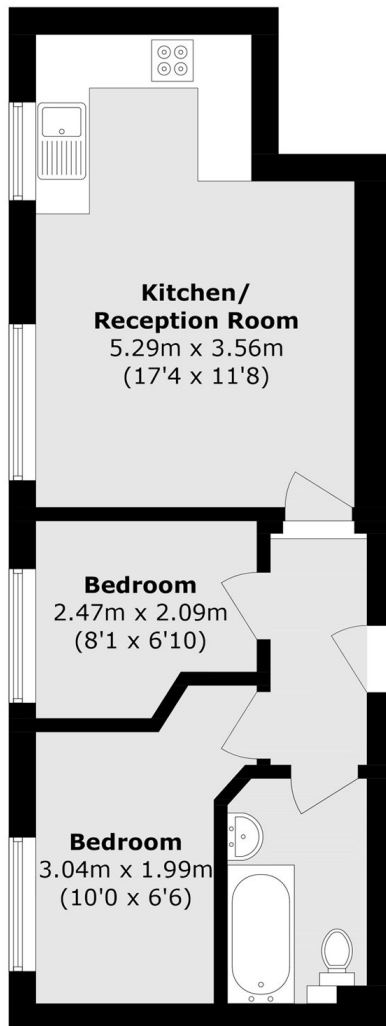

Third Floor

Total Area (approx.): 37.9 sq. m (407.9 sq. ft)