



## CHISWICK VILLAGE, W4

£428,000

Positioned in one of Chiswick's popular residential developments, this two-bedroom apartment comes with a long lease, lift access, communal grounds, and is being sold with no onward chain.

Two bedrooms  
Long lease  
No onward chain

Close to the River Thames  
Lift access  
Energy rating: c

# STEP INSIDE CHISWICK VILLAGE

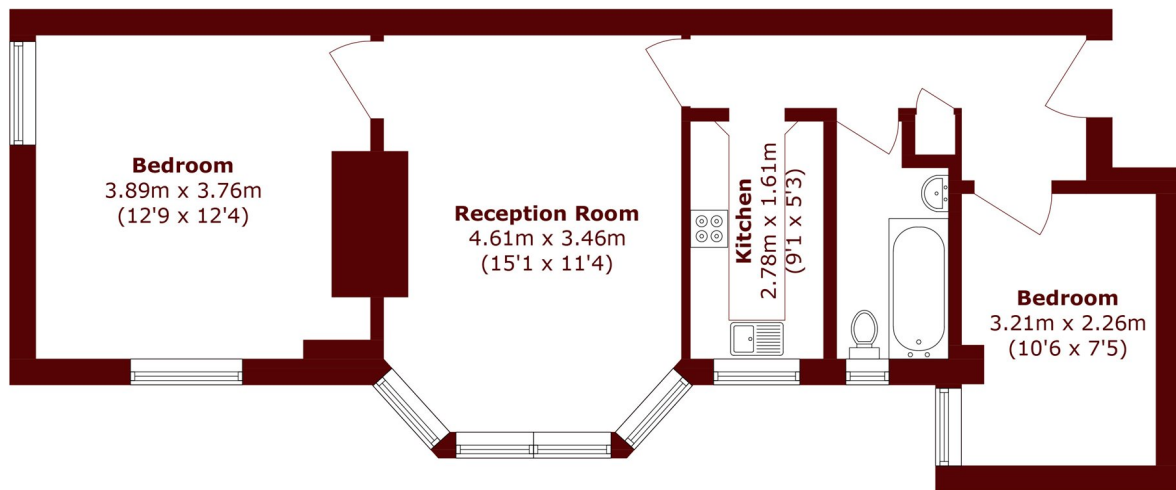

Total area (approx.): 52.5 sq. m (565.1 sq. ft)

Chiswick  
020 8994 2556

Energy Rating: C We aim to make our particulars both accurate and reliable. However, they are not guaranteed; nor do they form part of an offer or contract. If you require clarification on any points then please contact us, especially if you're traveling some distance to view. Please note that appliances and heating systems have not been tested and therefore no warranties can be given as to their good working order

MARSH &  
PARSONS