

HENDERSON CONNELLAN

ESTATE AGENTS

Thorn Close. Kettering NN16

"Designed For Living"

"Designed For Living"

Occupying a lovely corner plot, with wrap around gardens this exceptional extended home offers impressive dimensions both inside and out. The stunning, greatly improved interior features an entrance hall, generous living room with bay window and feature fireplace with working fire. The extensive kitchen/dining/family room is the perfect family and social space with designer units, Oak worksurfaces and central island with dining and family areas, bi-folding doors open to the garden, there is a utility room and guest cloakroom. Upstairs the principal bathroom has a white suite, there are four good size bedrooms, the main bedroom with built-in wardrobes and bay window amplifying the scale. Gas central heating and UPVC double glazing complete the inside. Outside the private double width driveway offers parking for two/three cars, the fore garden is laid to lawn and the wrap-around garden to the back is a great size and very private. Schools, shops, pubs and restaurants, the town centre and woodland walks are all within easy reach.

Living Room - 4.55m x 4.34m (14'11" x 14'3")

Kitchen/Dining/Family Room - 6.53m x 5.84m (21'5" x 19'2")

Utility Room - 3.02m x 2.26m (9'11" x 7'5")

WC

Bedroom One - 3.68m x 3.43m (12'1" x 11'3")

Bedroom Two - 3.4m x 3.38m (11'2" x 11'1")

Bedroom Three - 2.77m x 2.51m (9'1" x 8'3")

Bedroom Four - 2.59m x 2.49m (8'6" x 8'2")

- Gas Central Heating and UPVC Double glazing
- Corner Plot with wrap around garden
- Living Room with working fire
- Extended - fabulous Kitchen/Dining/Family Room
- Four Bedrooms
- Principal Bathroom
- EPC RATING: PENDING
- COUNCIL TAX: D
- Tenure: Freehold
- UPVC windows and rear door and composite front door installed June 2025 with 10 year Warranty





Ground Floor

Approx. 70.6 sq. metres (759.5 sq. feet)

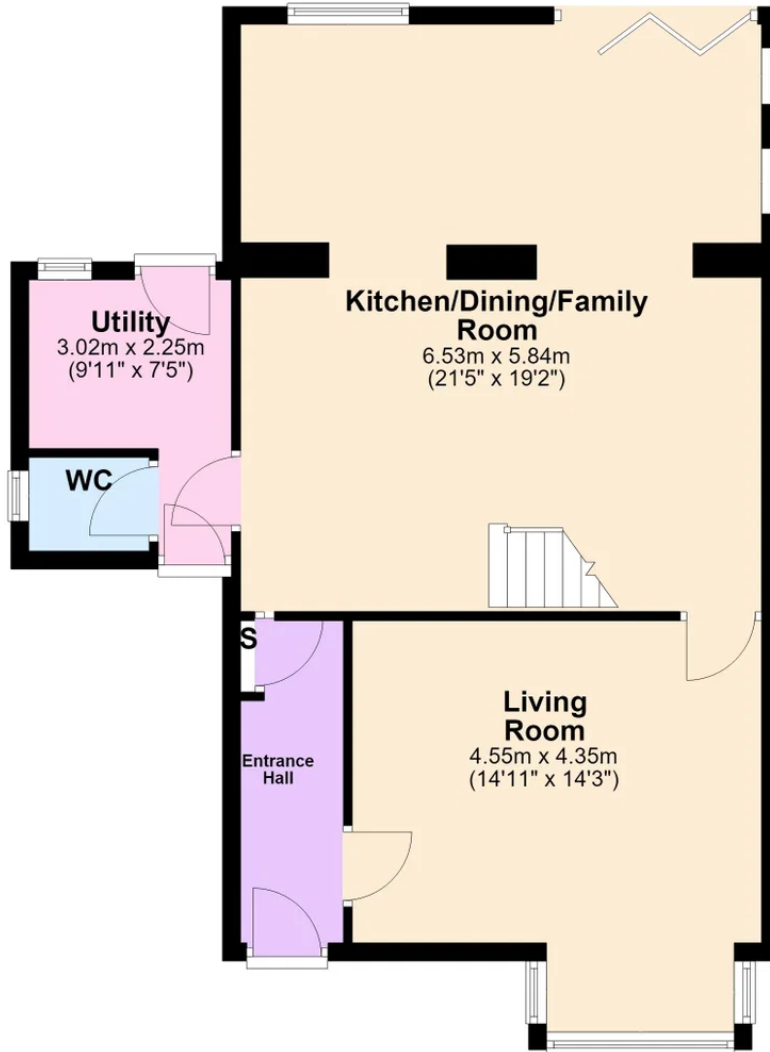

First Floor

Approx. 45.0 sq. metres (484.7 sq. feet)

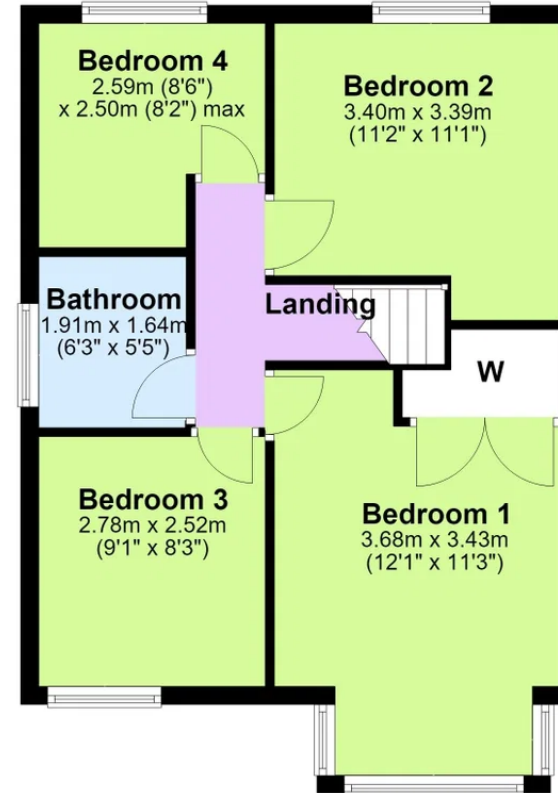

Total area: approx. 115.6 sq. metres (1244.2 sq. feet)