

abbotFox



Anchor Street, Norwich
Guide Price £170,000

“

We are a team of genuine individuals who hold a deep passion for both property and marketing. Collectively, we bring over 70 years of experience in the property market of Norfolk and Suffolk. Our affection for both counties runs deep, and we are enthusiastic about sharing our passion with you.

Colin McKenzie | **Branch Partner**







THE DETAIL_____

abbotFox presents this exceptional, ground floor garden flat. Situated within NR3, with a wealth of amenities on the doorstep and within walking distance of Norwich City Centre, this home has been meticulously improved and well maintained by the current owner.

The internal accommodation comprises; inviting entrance hall, lounge diner, modern fitted kitchen with built-in fridge freezer and dishwasher, generous double bedroom with a fitted wardrobe with grey sliding doors, and a family bathroom. Externally, this home offers a spacious, enclosed private garden with patio seating area and access to a private secure storage shed. Residents permit car parking is also available.

An internal viewing comes highly recommended to appreciate this home.

Guide Price £170,000 - £180,000







THE HIGHLIGHTS__

- Stylish ground floor apartment
- Generous, private gardens
- Spacious living accommodation
- Bright and stylish finish throughout
- Easy access to local amenities
- Internal viewing advised
- Guide price £170,000 - £180,000

Approx Gross Internal Area
47 sq m / 511 sq ft

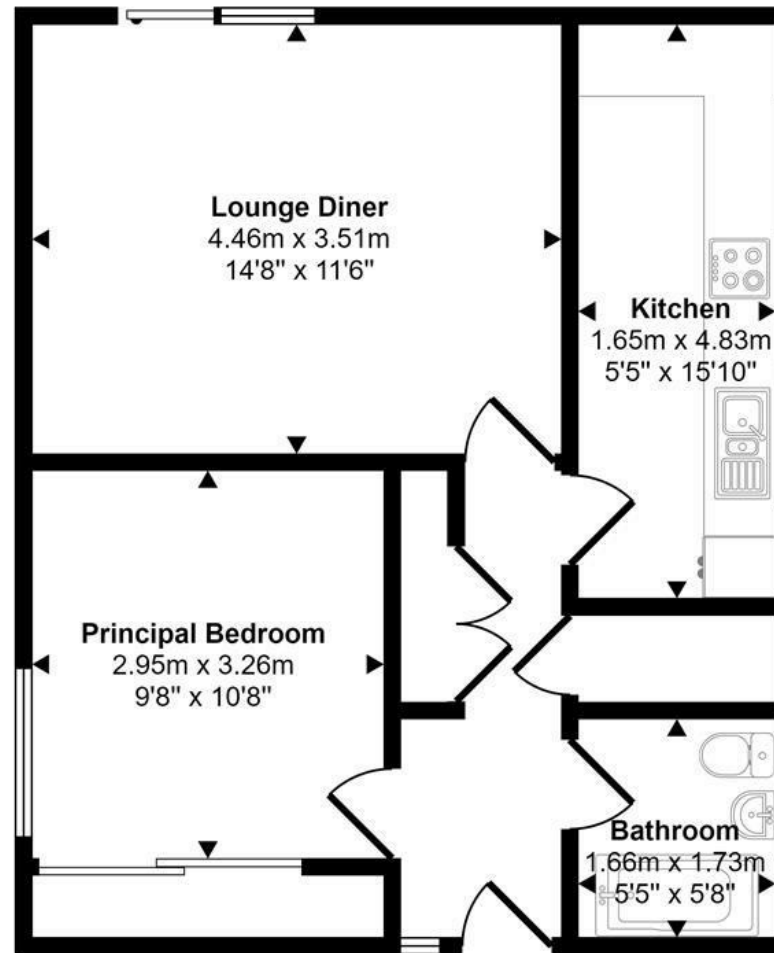

Floorplan

Let's talk

01603 660000

sales@abbotfox.co.uk

@abbotfox

This floorplan is only for illustrative purposes and is not to scale. Measurements of rooms, doors, windows, and any items are approximate and no responsibility is taken for any error, omission or mis-statement. Icons of items such as bathroom suites are representations only and

EPC RATING -

Disclaimer – In accordance with the Property Misdescriptions Act, the company abbotFox gives notice that all descriptions, references to condition, necessary permissions for use and other details are given in good faith and believed to be correct, but any purchaser should not rely on them as statements of fact, and must satisfy themselves by inspection or other means, as to their accuracy.