



Bentall Close, Halstead, Essex, CO9 1RA

Rent - £1,075 PCM

Deposit - £1,240

Welcome to this mid terrace house located on Bentall Close in the town of Halstead. This property offers a perfect blend of comfort and convenience, making it an ideal choice for those seeking a new home to rent. One of the standout features of this property is the inclusion of a garage, providing secure parking and additional storage options. Furthermore, there is a designated parking space, making it easy for you and your guests to come and go with ease. Situated in a friendly neighbourhood, this home is conveniently located near local amenities, schools, and parks, making it an excellent choice for families and professionals alike. The surrounding area offers a pleasant community atmosphere, perfect for those who appreciate a peaceful lifestyle while still being close to essential services. This mid-terrace house on Bentall Close is not just a place to live; it is a place to create lasting memories. If you are looking for a comfortable and well-located home to rent, this property is certainly worth considering. Don't miss the opportunity to make it your own.

- MID TERRACE HOUSE
- TWO BEDROOMS
- CLOSE TO LOCAL AMENITIES
- CLOAKROOM AND FAMILY BATHROOM
- SINGLE GARAGE AND ONE PARKING SPACE
- LOUNGE/ DINER
- GAS HEATING AND ENERGY RATING C
- APPROXIMATE SIZE - 645 SQ FT
- SORRY NO PETS/ COUNCIL TAX BAND C
- AVAILABLE JANUARY



Council Tax Band: C - EPC Rating: C 73

GROUND FLOOR
29.2 sq.m. (314 sq.ft.) approx.

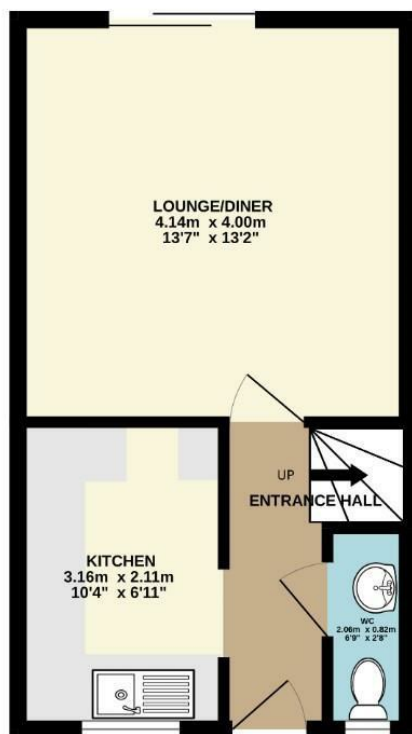

1ST FLOOR
29.2 sq.m. (314 sq.ft.) approx.

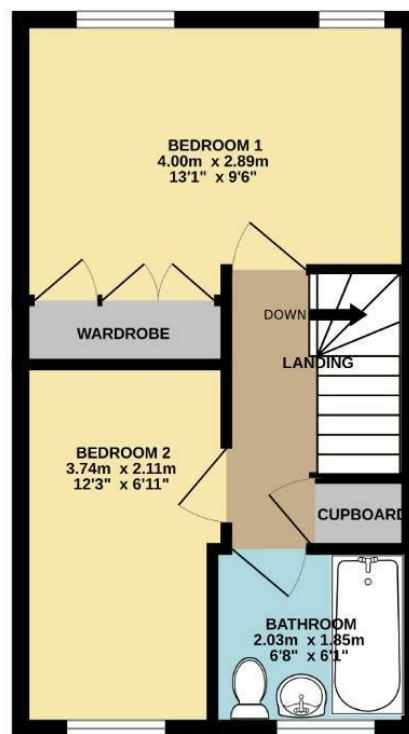

TOTAL FLOOR AREA : 58.3 sq.m. (628 sq.ft.) approx.

Whilst every attempt has been made to ensure the accuracy of the floorplan contained here, measurements of doors, windows, rooms and any other items are approximate and no responsibility is taken for any error, omission or mis-statement. This plan is for illustrative purposes only and should be used as such by any prospective purchaser. The services, systems and appliances shown have not been tested and no guarantee as to their operability or efficiency can be given.
Made with Metropix ©2025.

