

GROUND FLOOR
 APPROX. FLOOR
 AREA 484 SQ.FT.
 (45.0 SQ.M.)

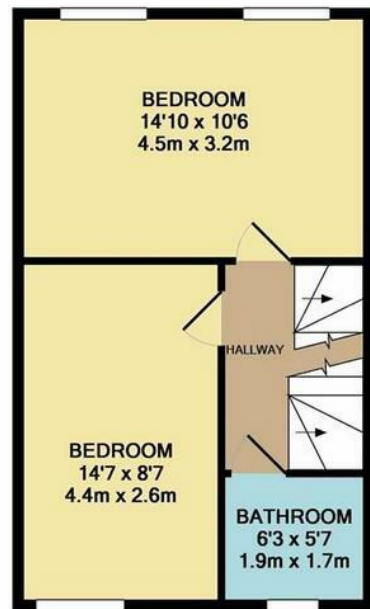

1ST FLOOR
 APPROX. FLOOR
 AREA 371 SQ.FT.
 (34.5 SQ.M.)

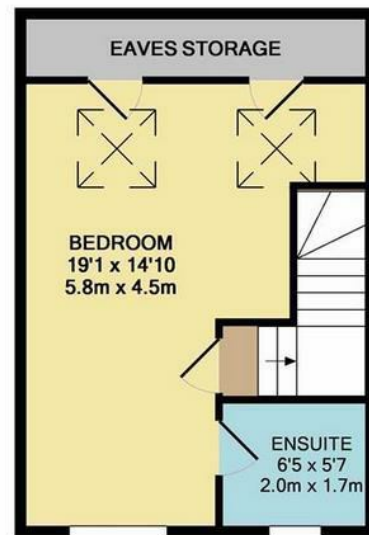

2ND FLOOR
 APPROX. FLOOR
 AREA 325 SQ.FT.
 (30.2 SQ.M.)

TOTAL APPROX. FLOOR AREA 1180 SQ.FT. (109.6 SQ.M.)

Whilst every attempt has been made to ensure the accuracy of the floor plan contained here, measurements of doors, windows, rooms and any other items are approximate and no responsibility is taken for any error, omission, or mis-statement. This plan is for illustrative purposes only and should be used as such by any prospective purchaser. The services, systems and appliances shown have not been tested and no guarantee as to their operability or efficiency can be given.
 Made with Metropix ©2017



Century Road, Walthamstow
£3,000 Per Calendar Month
3 bed, House - Terraced

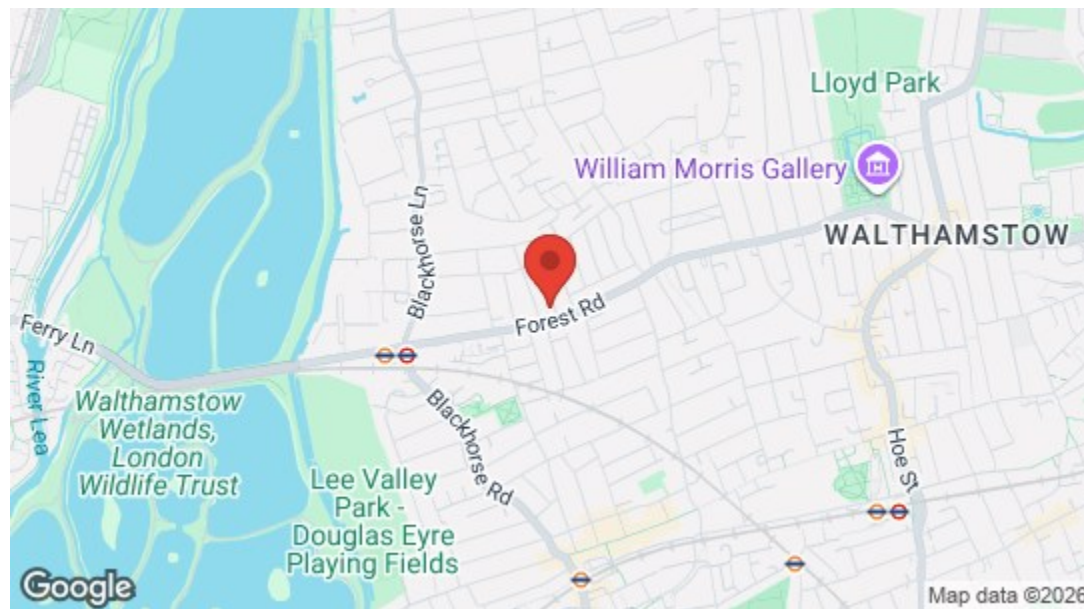

Energy Efficiency Rating	
	Potential
Very energy efficient - lower running costs	
(92 plus) A	
(81-91) B	86
(69-80) C	
(55-68) D	68
(39-54) E	
(21-38) F	
(1-20) G	
Not energy efficient - higher running costs	
England & Wales	EU Directive 2002/91/EC



Features

- Available July
- Victorian Terraced House
- Three Double Bedrooms
- Two Receptions
- Private Garden
- Renovated To High Specification
- Moments From Public Transport
- Unfurnished
- Bright and Airy
- Close To Amenities

A lovingly renovated, expertly extended three bedroom family home laid out across three floors. The bedrooms range in size from ample to huge, you have three bathrooms and a truly enormous kitchen/diner. Blackhorse Road train station is just a third of a mile away on foot.

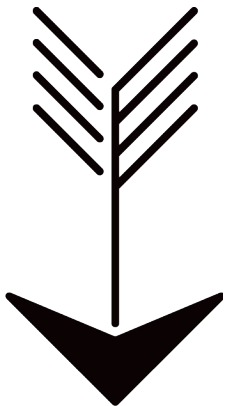
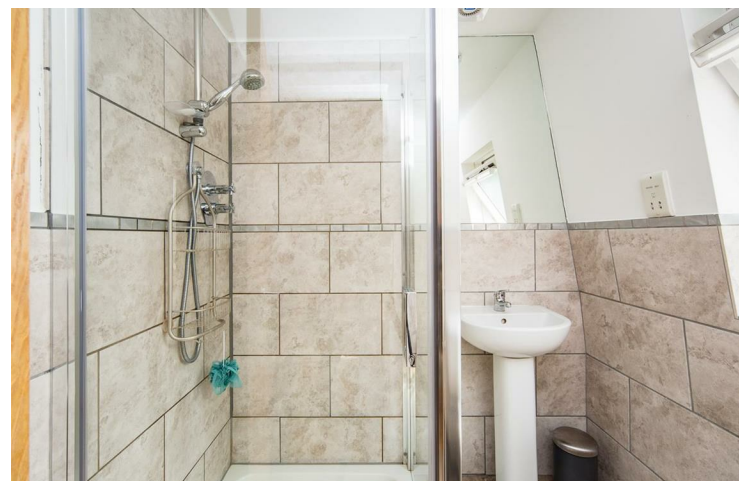

WHAT ELSE?

- You have six primary/secondary schools within walking distance, all rated 'Good' or better by Ofsted.
- As well as the en suite on the second floor and the family bathroom on the first, the ground floor has a separate WC, a lifesaver on busy mornings.
- Walthamstow Marshes, a Green Flag award-winning nature reserve, are just a short Sunday stroll away.





➤➤ IF YOU LIVED HERE...

You'll be falling in love with the 330 square foot kitchen diner, a dream space for both chefs and dinner party hosts alike there's a double width oven, slate grey floor tiling and mosaic splashbacks, plus chrome fittings and a full range of fitted appliances.

Design & Decor throughout the rest of the place is just as stylish; original floorboards - stripped, sanded and varnished - are underfoot throughout, all the bathrooms are decked out with sandstone tiles and brand new fittings, and there are a host of period features from the original mantelpiece in the lounge to the stained glass in the front door.

Even the smallest bedroom comes in at 130 square feet, while the master in the loft is an impressive 280, with twin skylights and an en suite shower room. Outside, the private garden is a low maintenance mix of decking and beds.

Blackhorse Road train station is a third of a mile away on foot, and will get you into Oxford Circus in just 20 minutes. One stop in the other direction is Walthamstow Central, for a huge range of shops, bars and restaurants as well as the Empire Cinema.

