



OLIVE ROAD, NW2

£500,000

This charming, two-bedroom garden flat is arranged over 801sqft and comprises a spacious, semi open-plan kitchen/reception room with ample dining space, direct access to a private, south-facing garden.

Two Bedrooms

Share Of Freehold

Arranged Over 801 sq ft

South Facing Garden

Period Conversion

Sought After Road

STEP INSIDE OLIVE ROAD

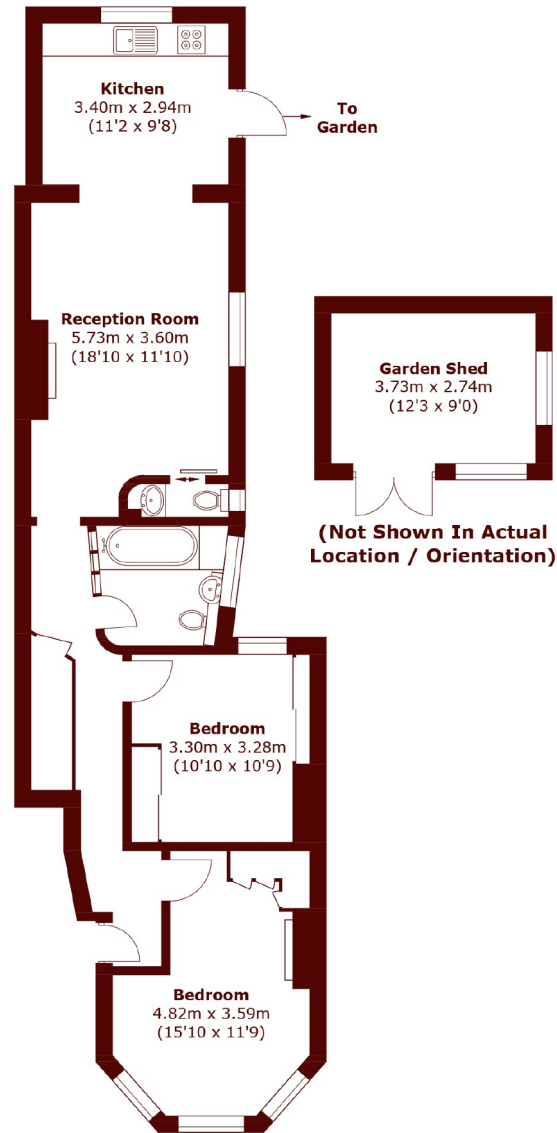

Total area (approx.): 74.5 sq. m (801.9 sq. ft)
Garden Shed : 10.4 sq. m (111.9 sq. ft)

Willesden Green
020 8451 0420

Energy Rating: C We aim to make our particulars both accurate and reliable. However, they are not guaranteed; nor do they form part of an offer or contract. If you require clarification on any points then please contact us, especially if you're traveling some distance to view. Please note that appliances and heating systems have not been tested and therefore no warranties can be given as to their good working order

**MARSH &
PARSONS**