



Hale Close, Ipswich, IP2 9QP

welcome to

Hale Close, Ipswich

This well-presented, two bedroom flat is situated in a popular IP2 location, benefiting from a spacious lounge, a separate kitchen, a bathroom with shower and bath and a garage en bloc.

Entrance Hall

Carpet flooring and a storage cupboard.

Lounge

14' 10" x 9' 9" (4.52m x 2.97m)

Carpet flooring, double glazed window to the side and one electric radiator.

Kitchen

9' 8" x 8' 7" (2.95m x 2.62m)

Grey tiled effect flooring, eye and base level units in wood with black marble effect worktop surfaces, space for a fridge/freezer and washing machine, a stainless steel sink plus drainer and chrome mixer tap, tiled splashback, an integrated oven with electric hob and extractor hood and double glazed window to the side.

Bedroom One

12' 4" x 9' 9" (3.76m x 2.97m)

Carpet flooring, one electric radiator and double glazed window to the front.

Bedroom Two

9' 8" x 9' 5" (2.95m x 2.87m)

Carpet flooring, one electric radiator and double glazed window to the front.

Bathroom

6' 3" x 6' 1" (1.91m x 1.85m)

Grey marble effect flooring, low level WC, pedestal wash hand basin, a bath with overhead shower and glass screen, a fitted mirror, chrome heated towel rail and an internal window above the door.

Garage En Bloc

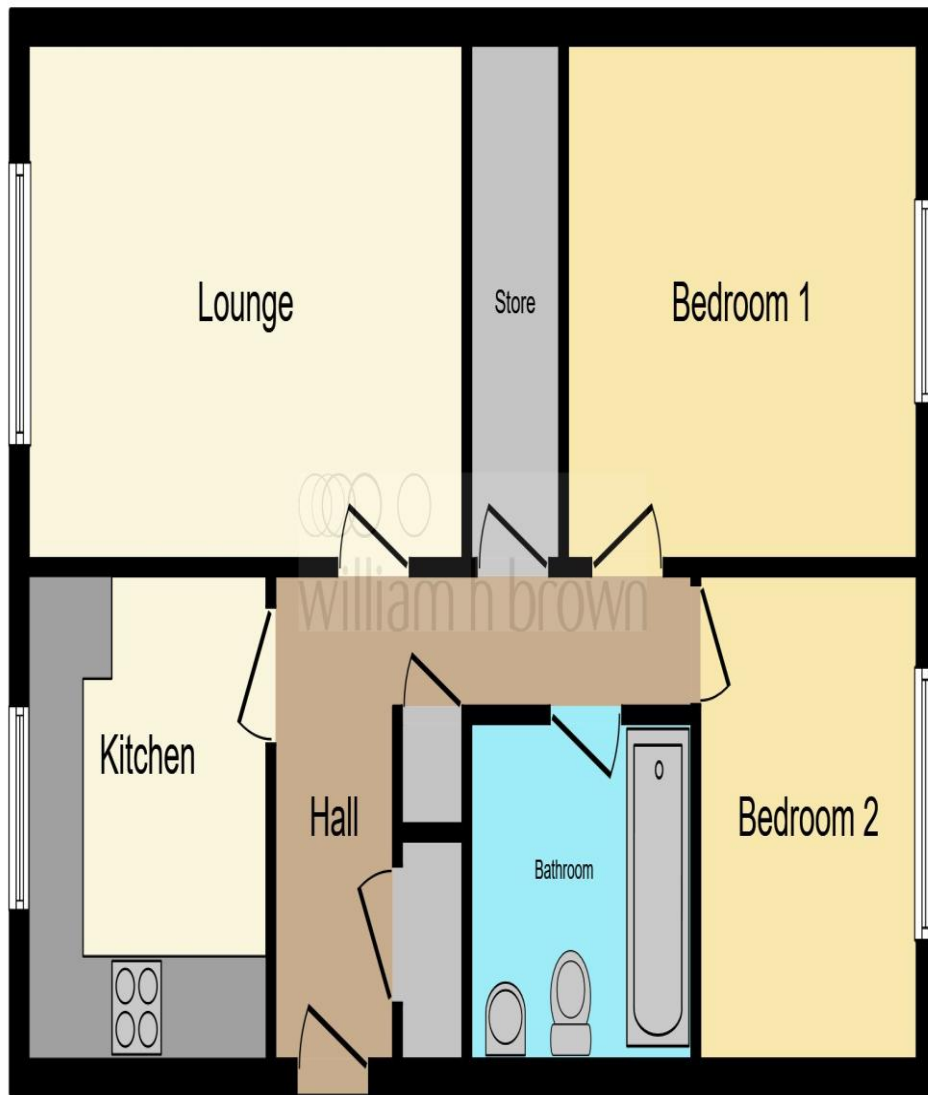

This floor plan is for illustrative purposes only. It is not drawn to scale. Any measurements, floor areas (including any total floor area), openings and orientation are approximate. No details are guaranteed, they cannot be relied upon for any purpose and they do not form part of any agreement. No liability is taken for any error, omission or misstatement. A party must rely upon its own inspection(s). Powered by www.focalagent.com



welcome to
Hale Close,
Ipswich

- INVESTORS ONLY
- Tenant in situ
- Two bedrooms
- Spacious lounge
- Bathroom with shower & bath

Tenure: Leasehold EPC Rating: F

Council Tax Band: A Service Charge: 960.00

Ground Rent: 256.00

This is a Leasehold property with details as follows; Term of Lease 99 years from 29 Sep 2014. Should you require further information please contact the branch. Please Note additional fees could be incurred for items such as Leasehold packs.

£125,000



view this property online williamhbrown.co.uk/Property/IPS121346



Property Ref:
IPS121346 - 0004

1. MONEY LAUNDERING REGULATIONS Intending purchasers will be asked to produce identification documentation at a later stage and we would ask for your co-operation in order that there is no delay in agreeing the sale. 2. These particulars do not constitute part or all of an offer or contract. 3. The measurements indicated are supplied for guidance only and as such must be considered incorrect. Potential buyers are advised to recheck measurements before committing to any expense. 4. We have not tested any apparatus, equipment, fixtures or services and it is in the buyers interest to check the working condition of any appliances. 5. Where an EPC, or a Home Report (Scotland only) is held for this property, it is available for inspection at the branch by appointment. If you require a printed version of a Home Report, you will need to pay a reasonable production charge reflecting printing and other costs. 6. We are not able to offer an opinion either written or verbal on the content of these reports and this must be obtained from your legal representative. 7. Whilst we take care in preparing these reports, a buyer should ensure that his/her legal representative confirms as soon as possible all matters relating to title including the extent and boundaries of the property and other important matters before exchange of contracts.

William H Brown is a trading name of Sequence (UK) Limited which is registered in England and Wales under company number 4268443, Registered Office is Cumbria House, 16-20 Hockliffe Street, Leighton Buzzard, Bedfordshire, LU7 1GN. VAT Registration Number is 500 2481 05.



william h brown



01473 226101



ipswich@williamhbrown.co.uk



16-18 Wolsey House, Princes Street, IPSWICH,
Suffolk, IP1 1QT



williamhbrown.co.uk