



ALASTAIR SAVILLE  
ESTATE AGENTS

Ormonde Drive, Maghull, L31 7AP

Offers Over £300,000

3 1 2



- Extended Three Bedroom Semi Detached
- Modern Bathroom
- Generous Rear Garden
- Garage
- Council Tax Band C
- Open Plan Family Room/ Kitchen
- Stunning Throughout
- Off Road Parking
- EPC Pending



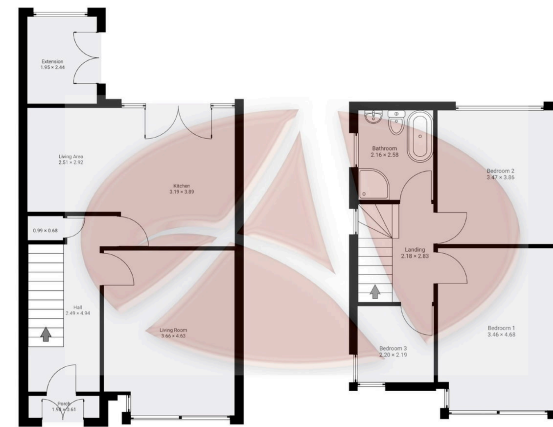

Ground Floor area 52.27m<sup>2</sup>

1st Floor area 45.90m<sup>2</sup>

10 Ormonde Drive, L31 7AP

Whilst every effort is made to accurately reproduce these floor plans, measurements are approximate, not to scale and for illustrative purposes only. Measurements, floor-areas, openings and orientations are approximate. They should be used as a guide only and do not form any part of an agreement. No liability is taken for any error or mis-statement. All parties must rely on their own inspections.

ABSOLUTELY STUNNING EXTENDED FAMILY HOME, BEAUTIFULLY PRESENTED THROUGHOUT, STUNNING OPEN PLAN FAMILY ROOM OVERLOOKING A GENEROUS GARDEN NOT OVERLOOKED, LOUNGE, MODERN BATHROOM, THREE BEDROOMS, DRIVEWAY PROVIDING PARKING, GARAGE, REAR GARDEN SECURE AND PRIVATE, A PERFECT FAMILY HOME-VIEWING ESSENTIAL, DO NOT MISS THIS OPPORTUNITY!

This really is a WOW property and one that has to be viewed to be fully appreciated. Being a credit to the current owners who have over time modernised and renovated the property to adapt to family life, the property offers absolutely stunning, spacious accommodation throughout.

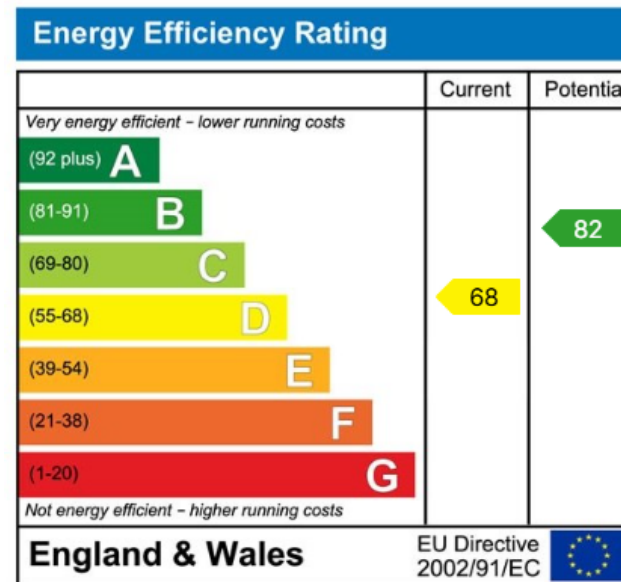

**Alastair Saville Estate Agents**  
 25 Central Square • Maghull • Liverpool • L31 0AE  
 138 Ormskirk Road • Old Roan • Liverpool • L10 3JG  
 Tel: 0151 520 0001 • Website: [www.alastairsaville.com](http://www.alastairsaville.com)  
 Email: [sales@alastairsaville.com](mailto:sales@alastairsaville.com) • [lettings@alastairsaville.com](mailto:lettings@alastairsaville.com)

