



1 Bed  
Flat  
located in

£1,150



TAYLOR  
MICHAEL

## Goldstone Road, Hove, BN3 3RP

Approximate Gross Internal Area = 44.0 sq m / 474 sq ft

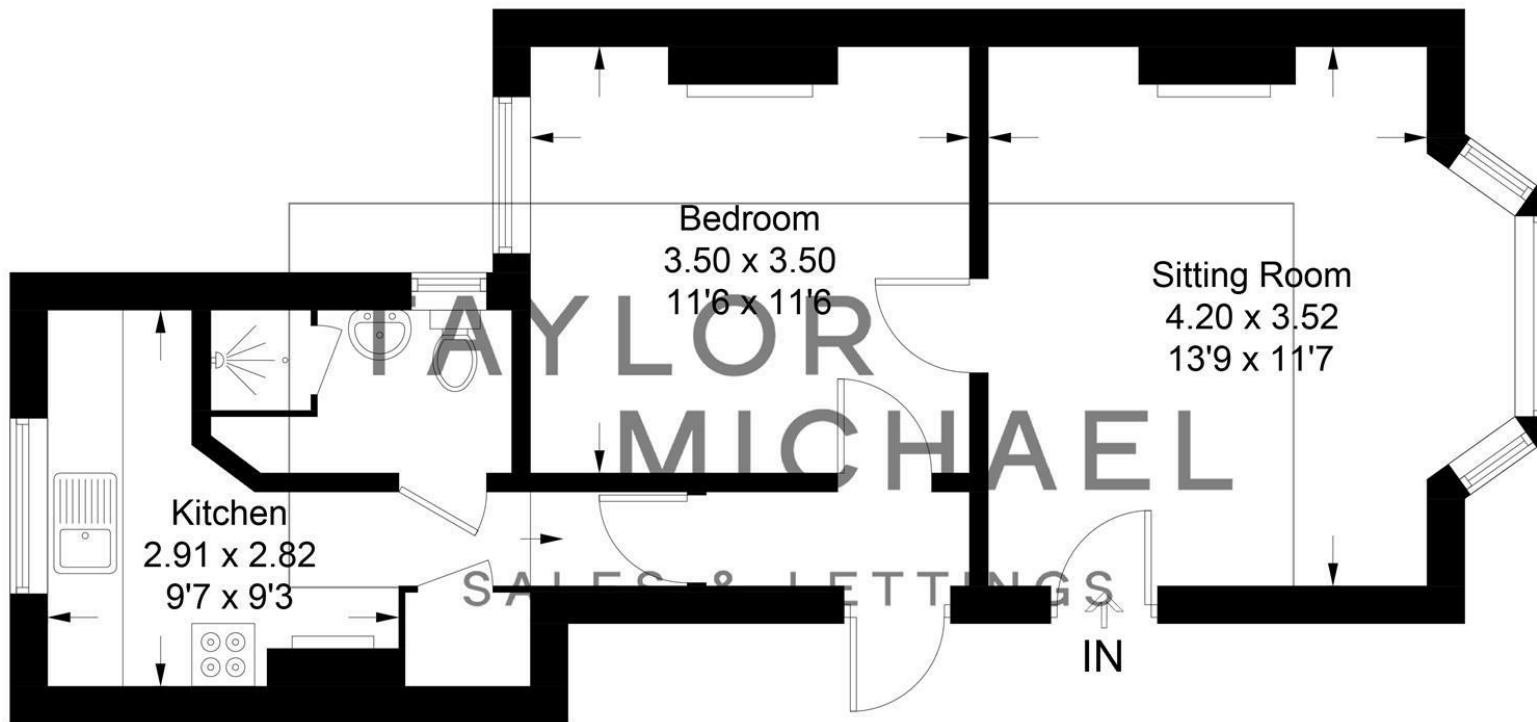

### Raised Ground Floor

Illustration for identification purposes only, measurements are approximate, not to scale.  
Imageplansurveys @ 2025

#### DIRECTIONS

#### CONTACT

62 Church Road  
Hove  
East Sussex  
BN3 2FP

E: [lettings@taylormichael.agency](mailto:lettings@taylormichael.agency)  
T: 01273 600100  
<https://taylormichael.agency/>

| Energy Efficiency Rating                    |  | Current                 | Potential |
|---|--|-------------------------|-----------|
| Very energy efficient - lower running costs |  |                         |           |
| (92 plus) A                                 |  |                         | 85        |
| (81-91) B                                   |  |                         |           |
| (69-80) C                                   |  |                         | 57        |
| (55-68) D                                   |  |                         |           |
| (39-54) E                                   |  |                         |           |
| (21-38) F                                   |  |                         |           |
| (1-20) G                                    |  |                         |           |
| Not energy efficient - higher running costs |  |                         |           |
| England & Wales                             |  | EU Directive 2002/91/EC |           |

TAYLOR  
MICHAEL