

18 Old Bakery Close  
Pimperne  
Dorset DT11 8BS

# Chaffers

INDEPENDENT ESTATE & LETTING AGENTS



A 2 bedroom mid terrace house with enclosed rear garden and parking - offered with no forward chain.

£260,000

**FREEHOLD**



# 18 OLD BAKERY CLOSE, PIMPERNE, DORSET DT11 8BS

## Directions

what3words///retrial.scrolled.gazed

## Viewing

Only by appointment with **Chaffers (Blandford) Ltd**, 18 Salisbury Street, Blandford Forum, Dorset DT11 7AR  
Tel. 01258 456044 Email. [post@chaffers.co.uk](mailto:post@chaffers.co.uk)

## Accommodation

### Ground Floor:

**Porch** Front door to the

### Hallway

Staircase to the first floor, smoke detector, inset ceiling lights.

### Cloakroom

WC and wash hand basin, tiled floor, window.

### Kitchen

Wall and floor units, worktops with tiled splashbacks, built-in Zanussi oven, hob and hood, fridge/freezer, AEG washer/dryer, Belling dishwasher, inset sink with mixer tap, wall mounted gas boiler for hot water and central heating (not tested).

### Sitting/Dining Room

French doors leading out to the rear garden, understairs cupboard.

### First Floor:

### Landing

Access to loft, smoke detector, inset ceiling lights.

### Bedroom 1

Rear aspect.

### Bedroom 2

Front aspect. Airing cupboard.

### Bathroom

White suite comprising panelled bath with screen and shower over, WC and wash hand basin. Part tiled walls and tiled floor, extractor fan.

**Outside:** Front garden with lawn, borders and path leading to the front door, adjacent driveway parking. Low maintenance rear garden with large timber decked seating area, gravelled section. Timber outbuilding ideal hobby/gym/office.

## Additional Information

**Services** Mains water, electricity, drainage and gas connected. Telephone subject to BT transfer regulations.

### Council Tax Band C

### Caution

All services and fittings mentioned in these particulars have not been tested, and hence we cannot confirm they are in working order.

Please note all prospective purchasers will need to be verified for 'Anti Money Laundering' purposes prior to issuing memorandum of agreed terms of sale.

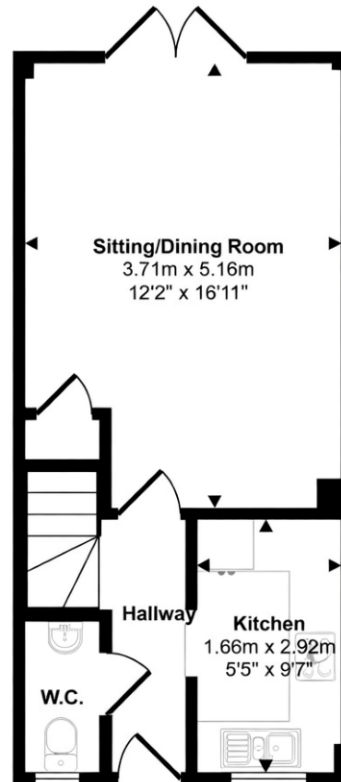

Ground Floor

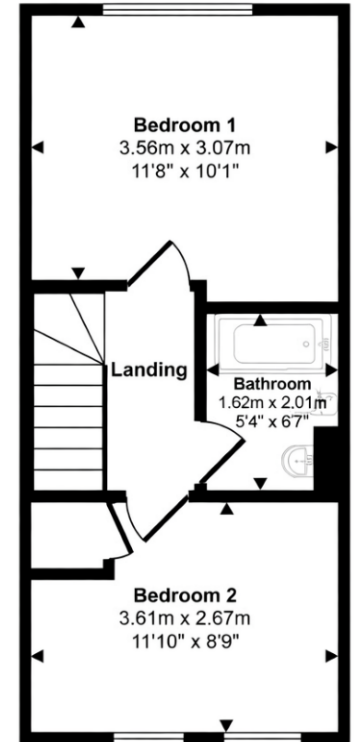

First Floor

**Mortgage Advice:** "We would be happy to introduce you to Bloomfield & Associates Ltd, an appointed representative of CAERUS Financial Limited for any mortgage requirements."

"Your home may be repossessed if you do not keep up repayments on your mortgage."

While we endeavour to make our sales particulars accurate and reliable, if there is any point which is of particular importance to you, please contact Steven Thornewill who will be pleased to check the information for you. Do so, particularly if contemplating travelling some distance to view the property.