



Connells

Far End
Hatfield



Property Description

Located in a popular residential area, this beautifully presented two-bedroom end-of-terrace cluster home has been fully renovated to an exceptional standard, offering stylish, modern living throughout.

The property has been thoughtfully redesigned to maximise both space and light, now featuring a loft conversion that creates two well-proportioned double bedrooms, ideal for professionals, small families, or those looking for flexible living arrangements.

At the heart of the home is a stunning open-plan kitchen, living and dining area, finished to a high specification with a range of sleek units and fully integrated appliances. This contemporary space is perfect for both everyday living and entertaining, enhanced further by underfloor heating which runs throughout the ground floor, providing comfort and efficiency. The accommodation is completed by a modern shower room, finished with high-quality fittings and a clean, contemporary design. Externally, the property benefits from off-road parking for two vehicles, along with an outside space to the side of the property.

Far End is located close by to the University of Hertfordshire, David Lloyd's leisure centre and the Galleria shopping centre which has an array of shops, restaurants and a cinema. It is also close by to the A1 (M) motorway and Hatfield train station giving direct access into Kings Cross.



Hall

Kitchen

17' 2" max x 12' 6" max (5.23m max x 3.81m max)

Bedroom One

12' 6" max x 8' 7" max (3.81m max x 2.62m max)

Landing

Shower Room

6' max x 6' max (1.83m max x 1.83m max)

Bedroom Two

9' 3" max x 8' 7" max (2.82m max x 2.62m max)



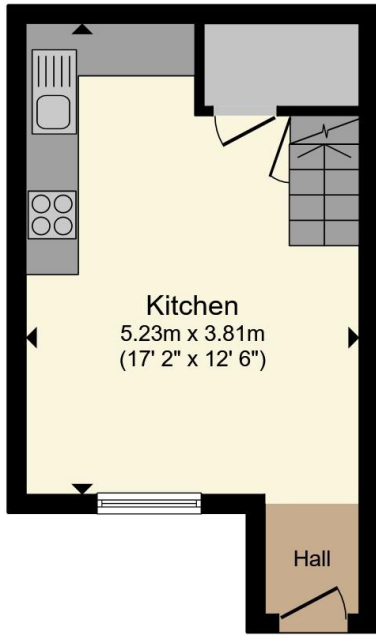

Ground Floor

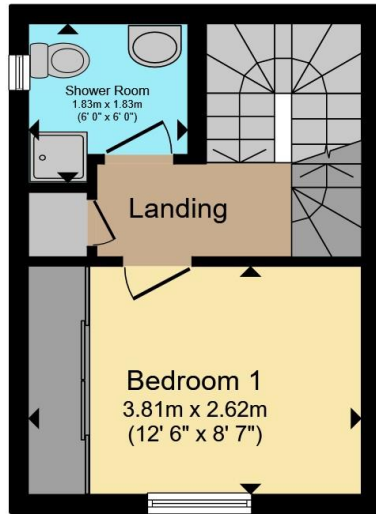

First Floor

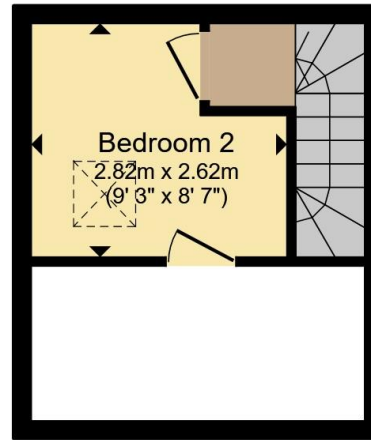

Second Floor



Total floor area 53.1 m² (572 sq.ft.) approx

This floor plan is for illustrative purposes only. It is not drawn to scale. Any measurements, floor areas (including any total floor area), openings and orientation are approximate. No details are guaranteed, they cannot be relied upon for any purpose and they do not form part of any agreement. No liability is taken for any error, omission or misstatement. A party must rely upon its own inspection(s). Powered by www.propertybox.io



To view this property please contact Connells on

T 01727 851 100
E marshalswick@connells.co.uk

5 Wycombe Place The Quadrant Marshalswick
 ST ALBANS AL4 9RH

EPC Rating: Council Tax
 Awaited Band: C

view this property online connells.co.uk/Property/MWK306278

Tenure: Freehold



1. MONEY LAUNDERING REGULATIONS Intending purchasers will be asked to produce identification documentation at a later stage and we would ask for your co-operation in order that there will be no delay in agreeing the sale. 2. These particulars do not constitute part or all of an offer or contract. 3. The measurements indicated are supplied for guidance only and as such must be considered incorrect. Potential buyers are advised to recheck measurements before committing to any expense. 4. We have not tested any apparatus, equipment, fixtures, fittings or services and it is in the buyers interest to check the working condition of any appliances.

Connells Residential is registered in England and Wales under company number 1489613, Registered Office is Cumbria House, 16-20 Hockliffe Street, Leighton Buzzard, Bedfordshire, LU7 1GN. VAT Registration Number is 500 2481 05.

See all our properties at www.connells.co.uk | www.rightmove.co.uk | www.zoopla.co.uk

Property Ref: MWK306278 - 0004