



## 29 Maidenhead Road, Bristol, BS13 0PS

**£240,000**

This three-bedroom terraced house is offered for sale and represents an opportunity for buyers seeking a property that needs renovation. Located in Bristol, the home features a separate sitting room and a kitchen/diner with direct access to the rear garden. Upstairs, there are two double bedrooms and one single bedroom, together with a family bathroom. To the front, there is a driveway providing off-street parking. The property has an EPC rating of C and falls within Council Tax Band B. It is available with no onward chain, which may appeal to first-time buyers and investors.

The property is situated within reach of a range of local amenities, including everyday shops, supermarkets and services found in the surrounding BS13 area. Several primary and secondary schools are accessible locally, making the location practical for households requiring education options.

Public transport links connect the area to central Bristol and beyond, with regular bus services providing access into the city centre, Harbourside and Temple Meads for national rail connections, including routes to Bath, Cardiff and London. Road links from this part of Bristol offer routes towards the A38 and the ring road for access to wider destinations.

### Entrance Porch

### Entrance Hall



### Bedroom One

15'7" x 8'5" (4.76 x 2.58)



### Bedroom Two

13'7" x 11'5" (4.16 x 3.48)



### Sitting Room

14'4" x 11'3" (4.37 x 3.45)



### Kitchen / Dining Room

19'9" x 8'5" (6.03 x 2.58)



### Bedroom Three

8'2" x 7'11" (2.51 x 2.42)



### First Floor Landing

## Bathroom

7'5" x 5'6" (2.27 x 1.69)



## Outside



## Floor Plan

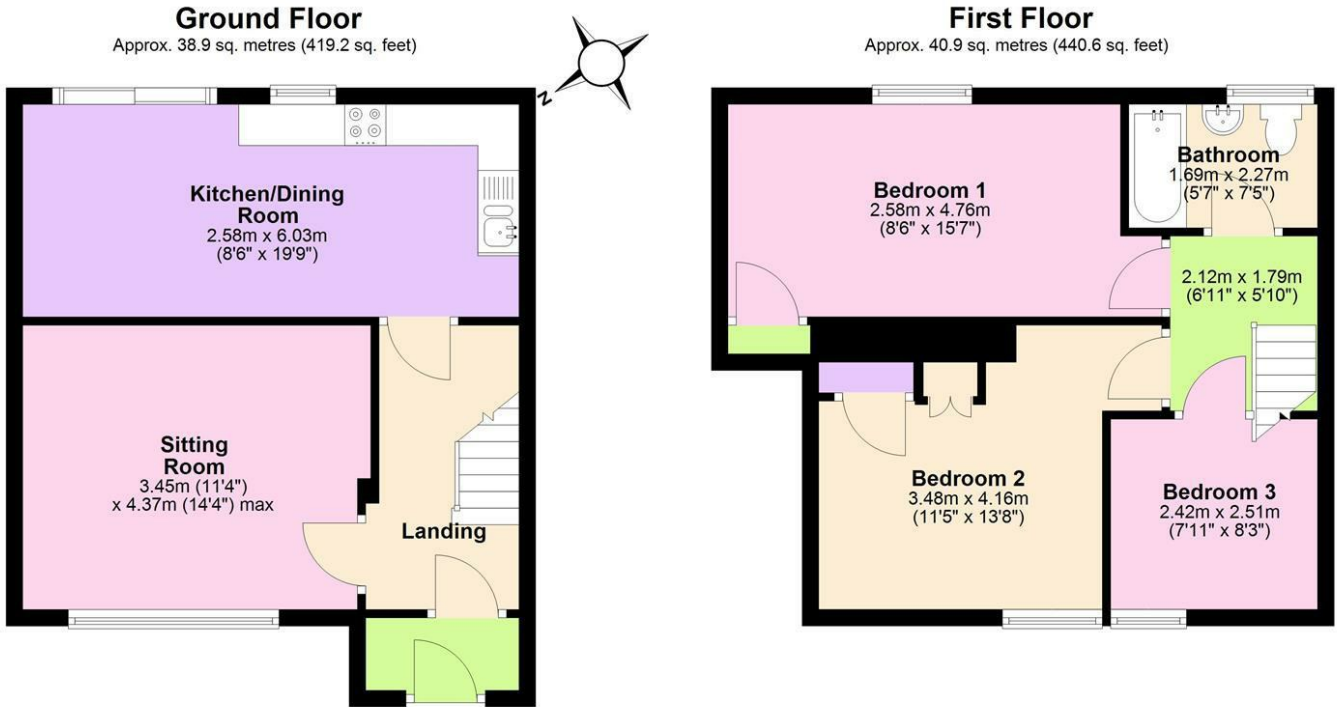

Total area: approx. 79.9 sq. metres (859.7 sq. feet)  
**29 Maidenhead Road, Bristol**

## Area Map

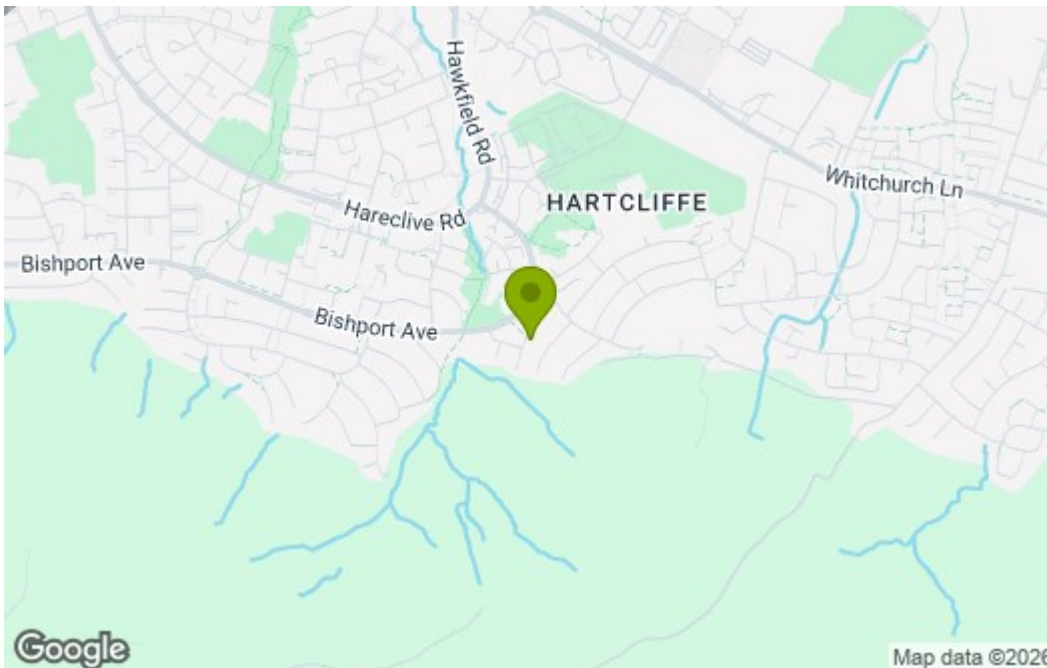

## Energy Efficiency Graph

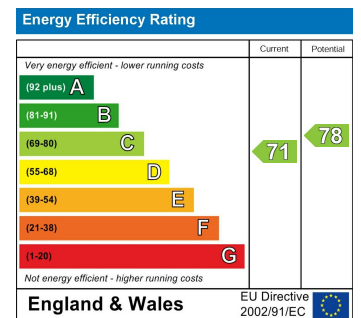

These particulars, whilst believed to be accurate are set out as a general outline only for guidance and do not constitute any part of an offer or contract. Intending purchasers should not rely on them as statements of representation of fact, but must satisfy themselves by inspection or otherwise as to their accuracy. No person in this firm's employment has the authority to make or give any representation or warranty in respect of the property.