

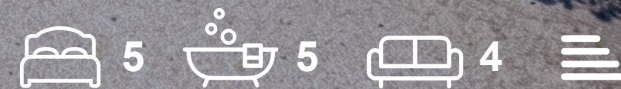

CHATTERTON | REES



Bix Manor Barn Broadplat Lane., Henley-On-Thames, RG9 4RS
Guide price £1,500,000





Bix Manor Barn Broadplat Lane,

Henley-On-Thames, RG9 4RS

- Planning to convert in to full residential
- Five Bedrooms
- Five Bathrooms
- Circa 4300sqft
- Prime location
- Rare to the market

Bix Manor Barn presents a rare opportunity to acquire an exceptional Grade II listed 17th Century barn with planning permission granted for conversion into a remarkable home extending to over 4,200 sq. ft. Rich in history and character, the property has previously operated as a function and entertainment venue, showcasing spectacular vaulted ceilings and an array of original architectural features synonymous with a building of this calibre.

The approved design thoughtfully combines historic charm with contemporary living, creating expansive light filled interiors centred around an impressive open plan kitchen and living space. The result is a seamless blend of period character and modern lifestyle design.

Offering further flexibility, the incoming purchaser will have the opportunity, subject to planning, to influence the final internal layout and specification of this outstanding barn conversion, making it perfectly suited to a wide range of buyers.

Guide price £1,500,000







Chlorroom

Building

Sunroom

Main entrance

Rear porch

Bedroom 3

Bedroom 4

Bedroom 5

Floor Plans

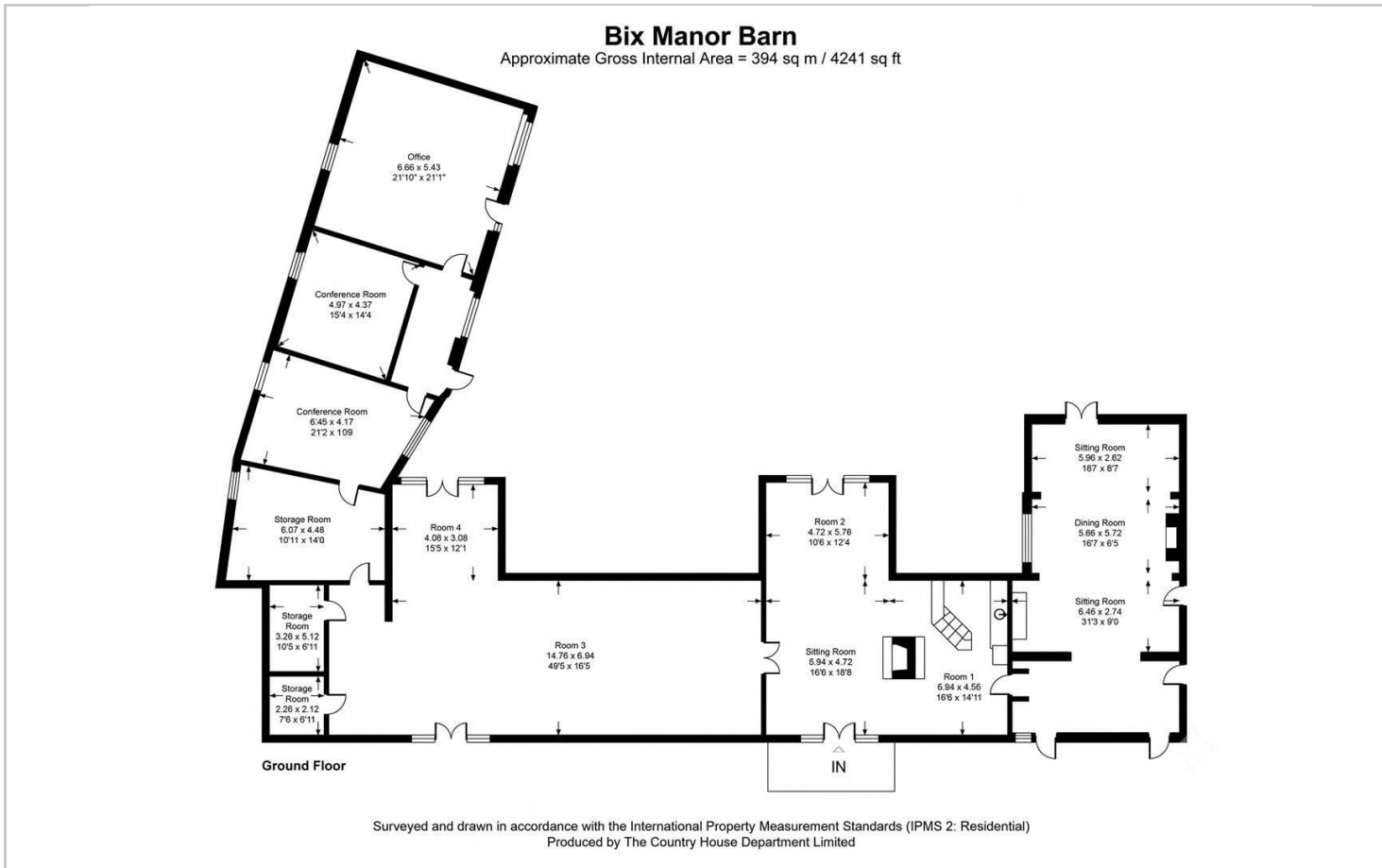

Location Map

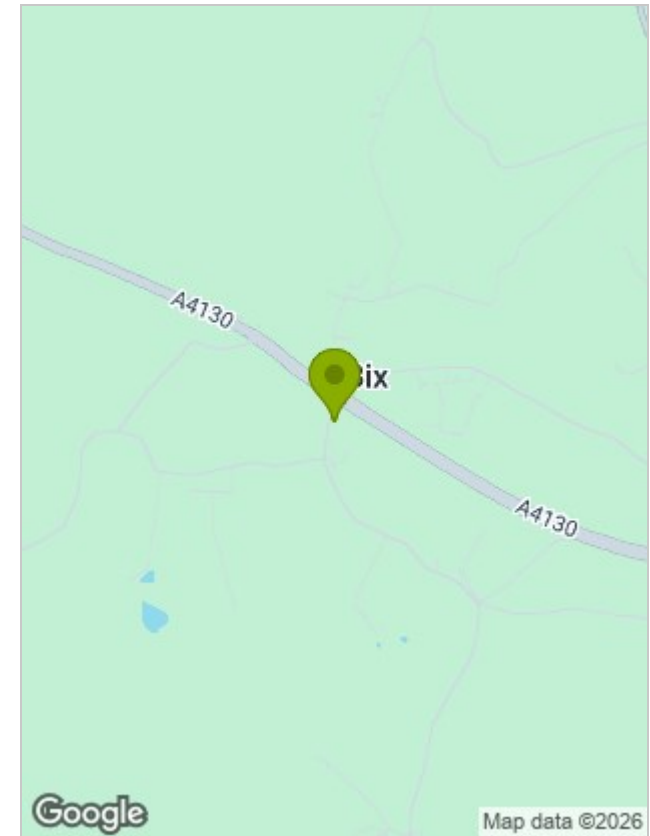

Viewing

Please contact our Sunningdale Country Homes Office on 020 3780 0580 if you wish to arrange a viewing appointment for this property or require further information.

The particulars are set out as a general outline only for the guidance of intended purchasers or lessees, and do not constitute, any part of a contract. Nothing in these particulars shall be deemed to be a statement that the property is in good structural condition or otherwise nor that any of the services, appliances, equipment or facilities are in good working order. Purchasers should satisfy themselves of this prior to purchasing.

Energy Performance Graph

