



226 Randolph Avenue | London | W9

£1,800 Per month |



ADN
RESIDENTIAL

A modern second-floor conversion set within a period building, ideally located opposite Paddington Recreation Ground and just 0.1 miles from Maida Vale Underground Station (Bakerloo Line), as well as the cafés and shops of Elgin Avenue. The property features wooden flooring throughout and offers an open-plan kitchen/reception room, a double bedroom, and a fully tiled shower room.

- Modern Apartment
- Open Plan Kitchen/Reception Room
- Wooden Flooring
- One Bedroom
- Shower Room
- Permit Parking

Council Tax Band: C
EPC: D





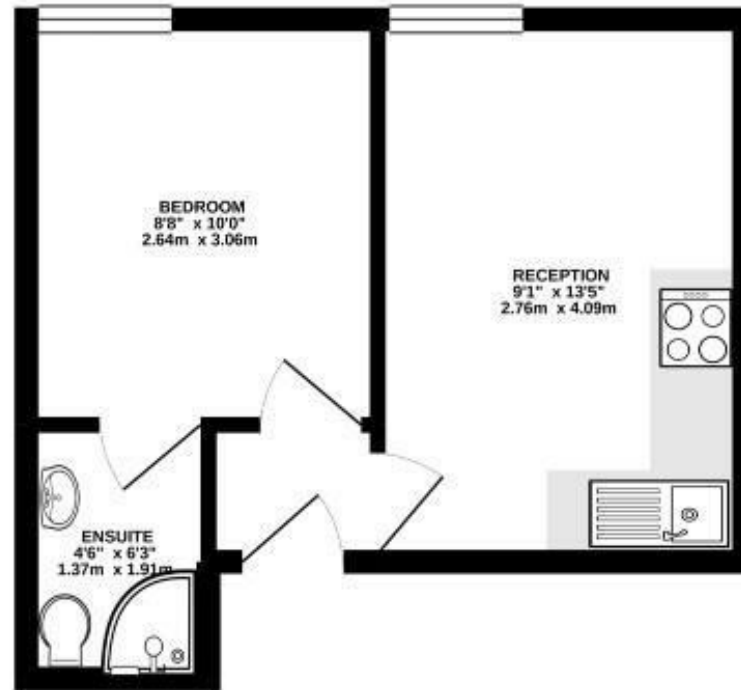

RANDOLPH AVENUE, MAIDA VALE, W9
 TOTAL FLOOR AREA: 272 sq ft (25.3 sq m) approx.
 Floor plans are for identification and guideline purposes only, not to scale.
 Compliant with RICS code of measuring practice.

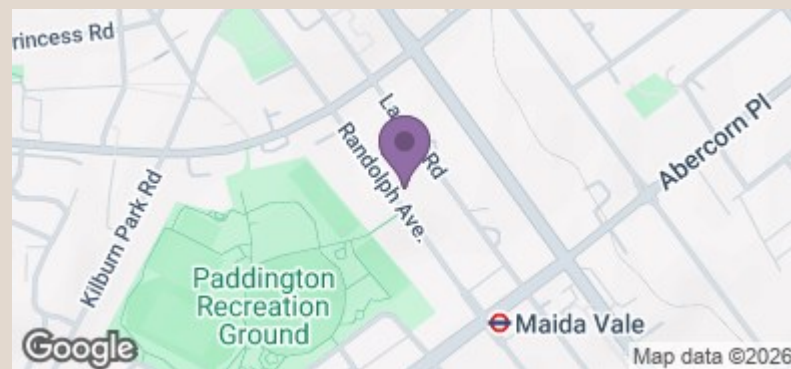

Energy Efficiency Rating		Current	Potential
Very energy efficient - lower running costs			
(92 plus) A			
(81-91) B			
(69-80) C			
(55-68) D		61	64
(39-54) E			
(21-38) F			
(1-20) G			
Not energy efficient - higher running costs			

England & Wales EU Directive 2002/91/EC