



TAYLOR GIBBS

Residential Sales, Lettings & Management Agents

Archway Road, Highgate, N6
Price £1,750 pcm - To Let

A one bedroom first floor purpose built apartment situated at the rear of the building with views over Highgate Woods from every window. Moments away from Highgate Underground Station, the accommodation comprises a spacious reception room, fitted kitchen with space for dining, double bedroom and bathroom. Further benefits include double glazed windows and off street parking on a first come first served basis. The property is located within walking distance to the restaurants, cafes and bars in Highgate Village and only moments away from the entrance to Highgate Woods.

Material Information:

The property has gas central heating and ofcom confirms that Ultrafast broadband is available. The building is serviced by electricity, mains water and sewerage, and mobile phone coverage is available.

Please note that £1,750 per calendar month is the equivalent of £403.84 per week

Council Tax: Haringey Band C

Approx. Floor Area: 452 sqft (42 sqm)



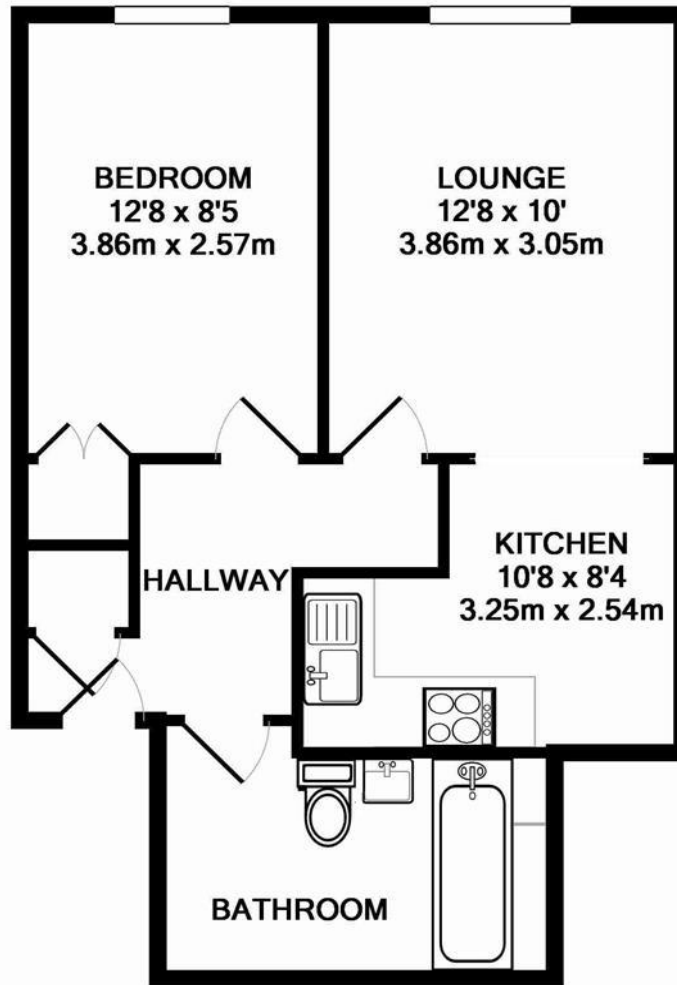

Energy Efficiency Rating		Current	Potential
<i>Very energy efficient - lower running costs</i>			
(92 Plus) A			
(81-91) B			
(69-80) C			
(55-68) D		70	76
(39-54) E			
(21-38) F			
(1-20) G			
<i>Not energy efficient - higher running costs</i>			
England & Wales	EU Directive 2002/91/EC		

TOTAL APPROX. FLOOR AREA 42.2 SQ.M. (454 SQ.FT.)

Pro Floor Plans accept no responsibility for the accuracy of these floor plans. Plans provided by Pro Floor Plans are not intended to be scale drawings. Measurements and areas quoted are approximate. Plans provided by Pro Floor Plans are intended for illustration only. Pro Floor Plans accept no responsibility of ensuring the floor plans comply with any and all relevant legislation. www.profloorplans.co.uk



TAYLOR GIBBS

Residential Sales, Lettings & Management Agents

33 Highgate High Street, Highgate, London, N6 5JT
 Tel: 020 8341 0123
 enquiries@taylorgibbs.co.uk
 www.taylorgibbs.co.uk

