



Sunnyhurst Close, Sutton SM1 2PT



welcome to
Sunnyhurst Close, Sutton

.Accessed via a private entrance on the ground floor, stairs lead to a central landing that provides access to all principal rooms. The property features a spacious reception room with ample space for both living and entertaining, along with a separate, well proportioned kitchen. There are two good sized bedrooms, including a particularly generous main bedroom, alongside a modern bathroom arranged off the landing. The layout offers excellent natural light throughout and a practical flow, making it well suited to both owner occupiers and investors. Externally, the property enjoys the rare benefit of a private rear garden, complemented by a useful outbuilding, ideal for storage, a home office, or hobby space. This first floor maisonette combines space, independence, and outdoor amenities in a highly appealing package.





Ground Floor

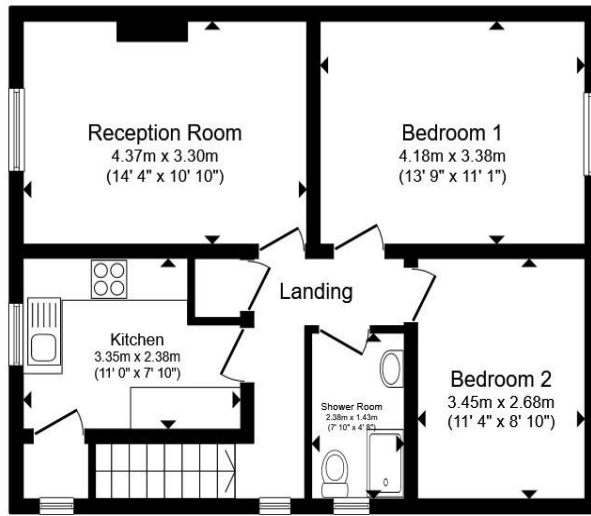

First Floor

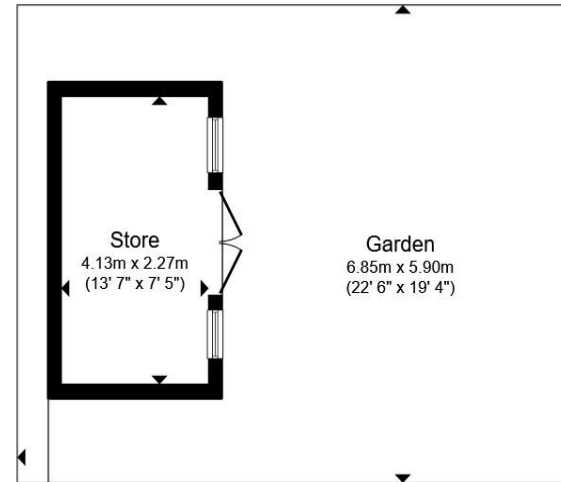

Outbuilding

Total floor area 71.3 m² (767 sq.ft.) approx

This floor plan is for illustrative purposes only. It is not drawn to scale. Any measurements, floor areas (including any total floor area), openings and orientation are approximate. No details are guaranteed, they cannot be relied upon for any purpose and they do not form part of any agreement. No liability is taken for any error, omission or misstatement. A party must rely upon its own inspection(s). Powered by www.propertybox.io

welcome to

Sunnyhurst Close, Sutton

- Garage and private driveway
- Potential to buy also the ground floor
- Spacious reception room
- Loft space and potential to convert (STPP)
- Two well proportioned bedrooms

Tenure: Leasehold EPC Rating: C

Council Tax Band: C Service Charge: Ask Agent

Ground Rent: Ask Agent

This is a Leasehold property. We are awaiting further details about the Term of the lease. For further information please contact the branch. Please note additional fees could be incurred for items such as Leasehold packs.

£350,000



Please note the marker reflects the postcode not the actual property

view this property online barnardmarcus.co.uk/Property/SUT111059



Property Ref:
SUT111059 - 0003

1. MONEY LAUNDERING REGULATIONS Intending purchasers will be asked to produce identification documentation at a later stage and we would ask for your co-operation in order that there is no delay in agreeing the sale. 2. These particulars do not constitute part or all of an offer or contract. 3. The measurements indicated are supplied for guidance only and as such must be considered incorrect. Potential buyers are advised to recheck measurements before committing to any expense. 4. We have not tested any apparatus, equipment, fixtures or services and it is in the buyers interest to check the working condition of any appliances. 5. Where an EPC, or a Home Report (Scotland only) is held for this property, it is available for inspection at the branch by appointment. If you require a printed version of a Home Report, you will need to pay a reasonable production charge reflecting printing and other costs. 6. We are not able to offer an opinion either written or verbal on the content of these reports and this must be obtained from your legal representative. 7. Whilst we take care in preparing these reports, a buyer should ensure that his/her legal representative confirms as soon as possible all matters relating to title including the extent and boundaries of the property and other important matters before exchange of contracts.

Barnard Marcus is a trading name of Sequence (UK) Limited which is registered in England and Wales under company number 4268443, Registered Office is Cumbria House, 16-20 Hockliffe Street, Leighton Buzzard, Bedfordshire, LU7 1GN. VAT Registration Number is 500 2481 05.



barnard marcus



020 8643 8245



Sutton@barnardmarcus.co.uk



2&3 Regent Parade, Brighton Road, SUTTON,
Surrey, SM2 5BL



barnardmarcus.co.uk