



Charles Square, N1

£2,318 Per calendar month

A recently refurbished one bedroom apartment located in the heart of Shoreditch. The apartment features an open plan reception and kitchen, a good-sized bedroom, a main bathroom, and is situated on the top floor.

Located in the heart of Shoreditch, the apartment is within easy reach of both Old Street and Liverpool Street stations, with a wide selection of bars, cafés and restaurants nearby.

Features

- Newly Refurbished
- One Bedroom
- Great Location
- Furnished
- Open Plan Reception
- Top Floor

Charles Square, LONDON, N1

Second Floor

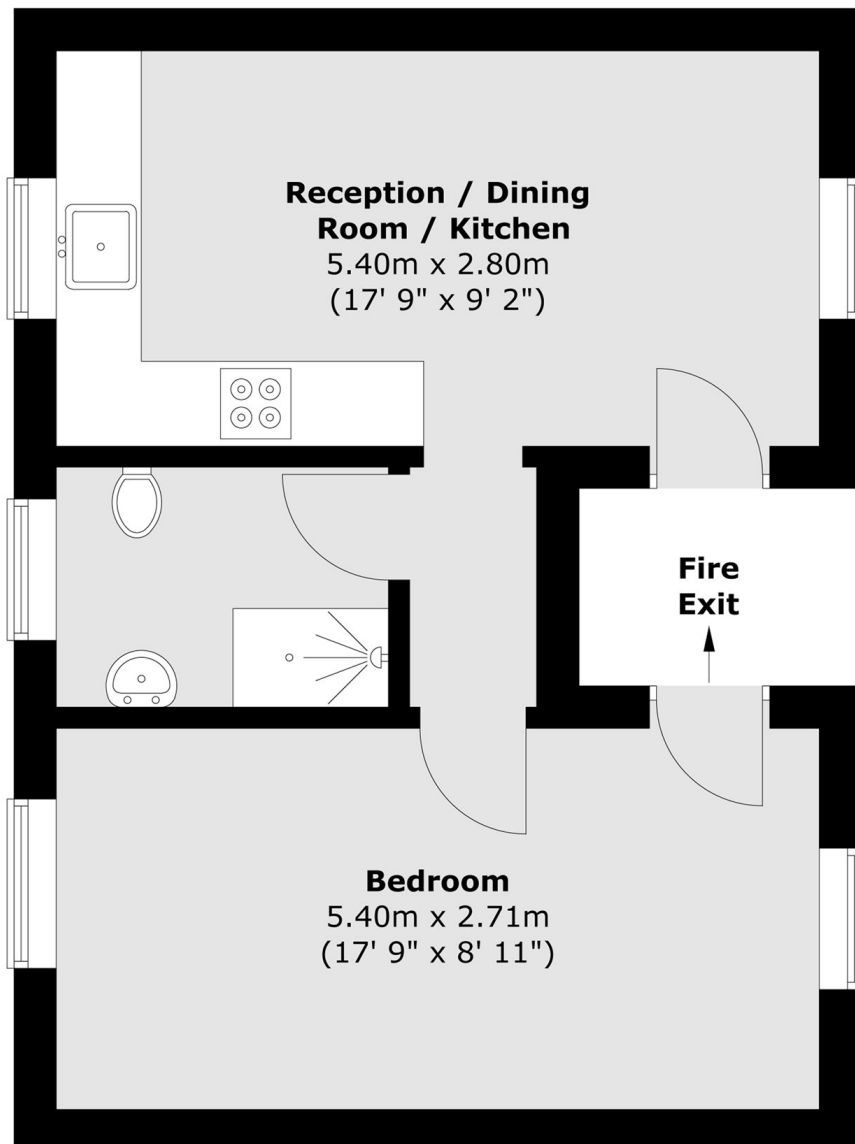

Total area (approx.) : 36.8 sq. m (396 sq. ft)