



## 15 BREARY LANE EAST

LEEDS, LS16 9BH

£1,195,000  
FREEHOLD

Monroe is proud to present this magnificent, expansive family home situated in the highly desirable and prestigious village of Bramhope. Offering a perfect blend of architectural character, modern luxury, and vast living space, this substantial property is designed to meet the needs of the most discerning families. With its versatile, multi-level layout and premium location, this residence truly represents an elite opportunity in North Leeds.

MONROE

SELLERS OF THE FINEST HOMES

## Breary Lane East, Bramhope

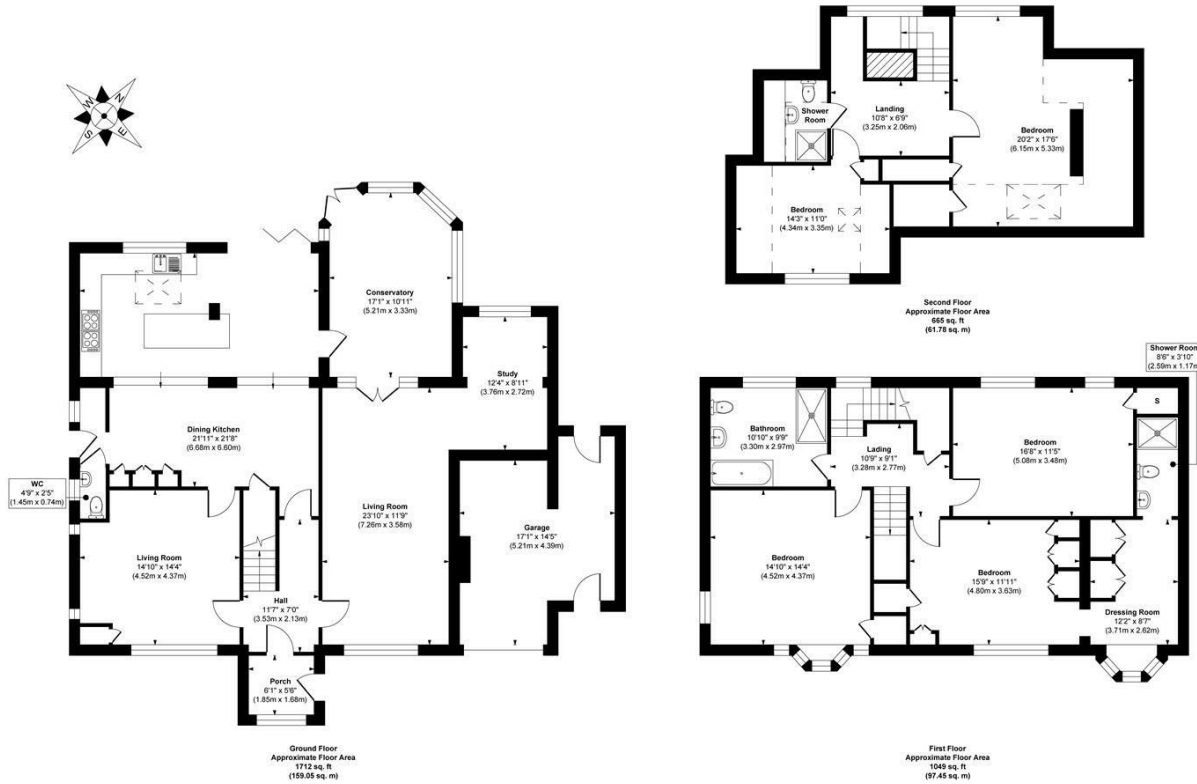

**Approx. Gross Internal Floor Area 3426 sq. ft / 318.28 sq. m (Including Garage)**

Illustration for identification purposes only, measurements are approximate, not to scale.

Copyright © Show Home.

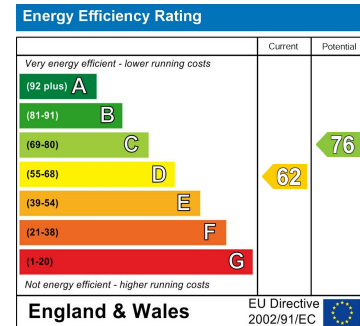
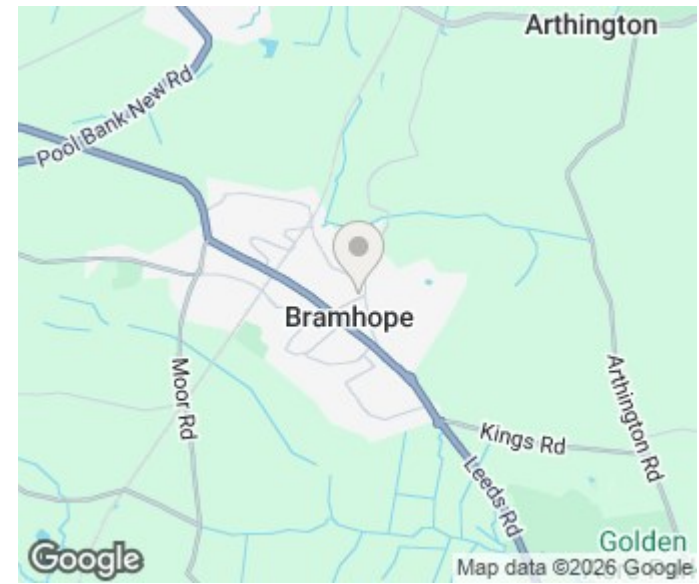

Agents Note: Whilst every care has been taken to prepare these particulars, they are for guidance purposes only. All measurements are approximate and are for general guidance purposes only and whilst every care has been taken to ensure their accuracy, they should not be relied upon and potential buyers/tenants are advised to recheck the measurements

Alwoodley Sales  
716 King Lane Alwoodley  
Leeds  
West Yorkshire  
LS17 7BA

0113 870 4443  
hello@monroestateagents.com  
www.monroestateagents.com

MONROE

SELLERS OF THE FINEST HOMES