



Strode Road, NW10

£550,000

Set within a Victorian conversion is this two double bedroom ground floor flat, with a private garden to the rear. The property has a separate kitchen, has the potential to be extended, has a share in the freehold and is available chain-free.

Strode Road is located next to Roundwood Park, nestled between Kensal Rise and Willesden Green. Transport links include Willesden Green (Jubilee), Willesden Junction (Bakerloo & Overground), along with multiple bus routes.

Features

- Two Double Bedrooms
- Garden Flat
- Separate Kitchen
- Share Of Freehold
- Chain-Free
- Close To Local Amenities

Strode Road, London, NW10

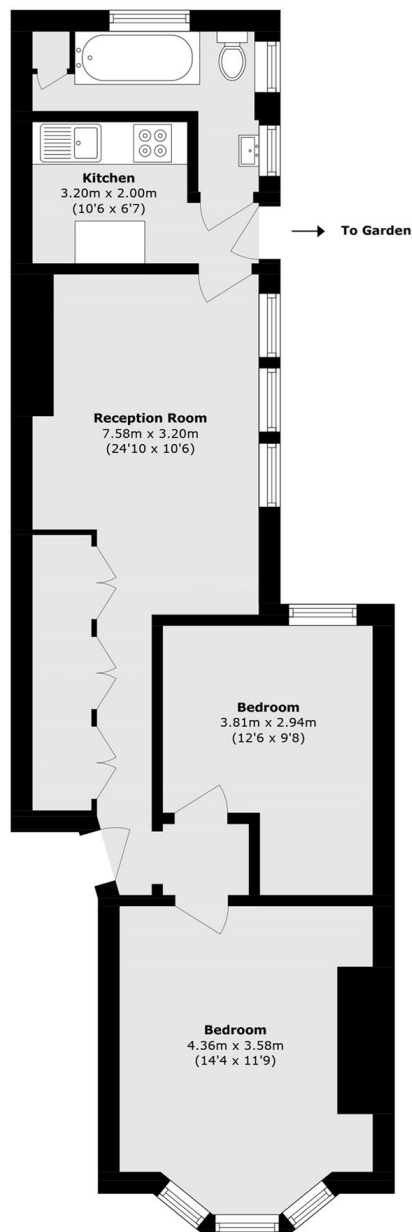

Total area (approx.): 58.9 sq. m (633.9 sq. ft)

Dexters

Kensal Rise & Queen's Park
62 Chamberlayne Road
London
NW10 3JJ

Sales
020 8600 3100

Energy Rating: D. We aim to make our particulars both accurate and reliable. However they are not guaranteed; nor do they form part of an offer or contract. If you require clarification on any points then please contact us, especially if you're traveling some distance to view. Please note that appliances and heating systems have not been tested and therefore no warranties can be given as to their good working order.

 **RICS** | Regulated
Estate Agent
and Letting Agent

[dexters.co.uk](https://www.dexters.co.uk)