



Valetta Drive, Thetford, Norfolk, IP25 6YX

Rent - £1,000 PCM

Deposit - £1,153

Nestled in the charming area of Valetta Drive, Watton, this delightful house presents an excellent opportunity for families and individuals alike. With three well-proportioned bedrooms, this property offers ample space for comfortable living. The inviting reception room serves as a perfect gathering space, ideal for entertaining guests or enjoying quiet evenings at home.

The house features a well-appointed bathroom, ensuring convenience for all residents. The layout is thoughtfully designed to maximise space and functionality, making it a practical choice for modern living.

- 3 SPACIOUS BEDROOM
- LOCATED ON VALETTA DRIVE
- CLOSE TO LOCAL AMENITIES
- IDEAL FOR FAMILIES
- QUIET RESIDENTIAL AREA
- WELL PRESENTED
- 2 OFF ROAD PARKING SPACES
- EASY ACCEES TO TRANSPORT LINKS
- VIEWINGS RECOMMENDED

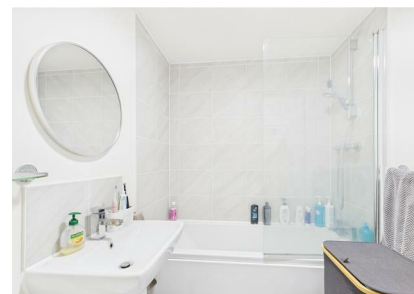

Council Tax Band: B - EPC Rating: B 85

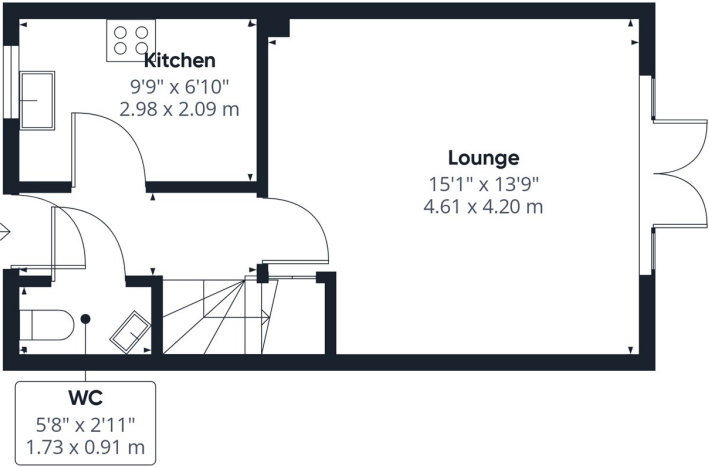

Ground Floor

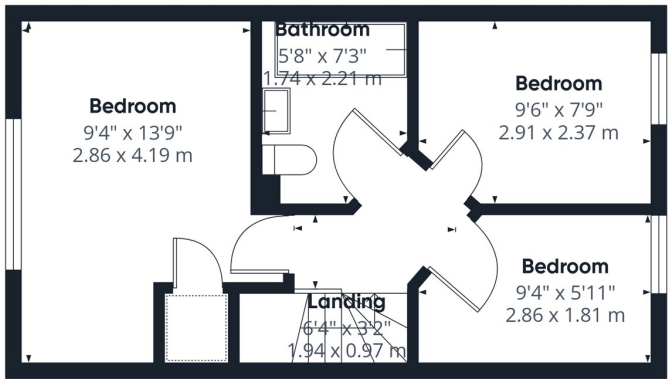

Floor 1

Approximate total area^m
652 ft²
60.5 m²

Reduced headroom
1 ft²
0.1 m²

(1) Excluding balconies and terraces

Reduced headroom
..... Below 5 ft/1.5 m

Calculations reference the RICS IPMS 3C standard. Measurements are approximate and not to scale. This floor plan is intended for illustration only.

GIRAFFE360

