

Beechwood Grove, Acton, W3

Offers Over £275,000

2 1 1



- 2 Bed Apartment
- Offers Over £275,000
- Separate Kitchen
- Onsite Manager on Call
- Private Communal Gardens
- Over 55's Later Living Property
- 2nd Floor with Lift Access
- 2 Parking Permits (Resident & Visitor)
- In need of cosmetic refurbishment
- Communal Common Room

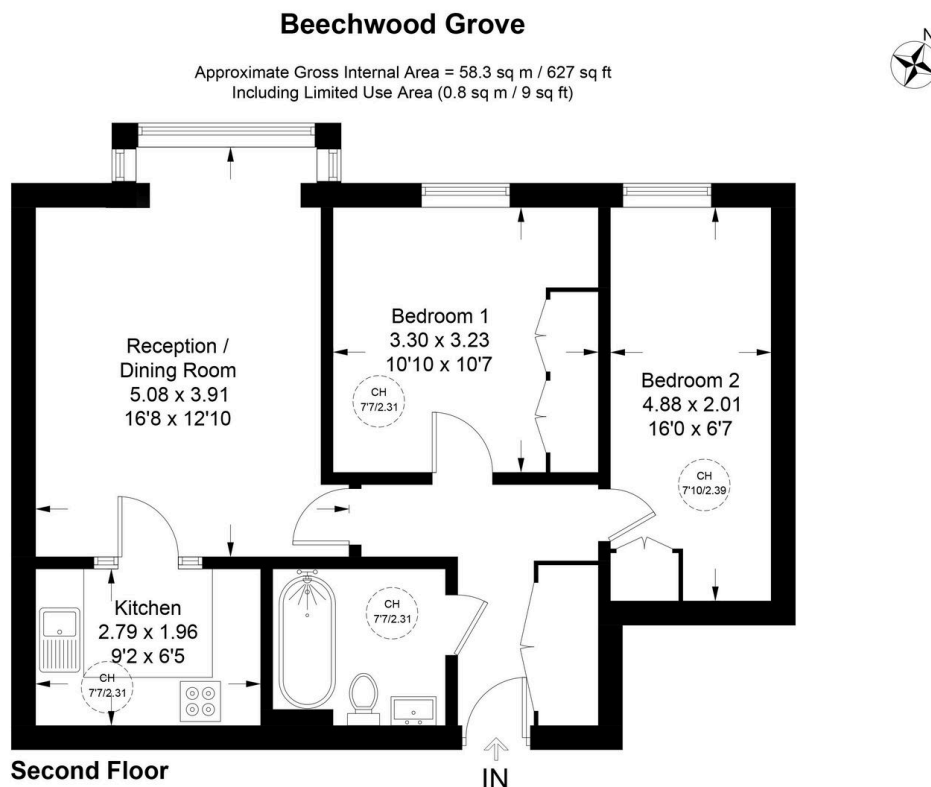

Illustration for identification purposes only, not for valuation purposes, measurements are approximate, not to scale. IPMS2

Located in the highly regarded Beechwood Grove development in Ealing, W3, this bright and spacious two-bedroom apartment offers secure, comfortable, and convenient later living for the over 55s. Positioned on the second floor and serviced by a lift, the property provides easy access throughout and the opportunity for the new owner to refurbish and personalise to their own taste. Inside, the apartment features. They benefit from an inviting shared common room, ideal for socialising and community events, along with on-site parking for residents and visitors.