



## Maltings Place, SW6

£500,000

This recently renovated two-bedroom flat is set within a highly sought-after gated development and benefits from private parking. The property features a spacious, bright, and airy open-plan kitchen and living area, complete with fully integrated kitchen appliances. Both bedrooms are generously proportioned and offer built-in storage. The flat further benefits from two modern bathrooms, including a stylish en-suite to the principal bedroom.

Maltings Place is a gated complex conveniently located within walking distance of the river and has excellent transport links including Fulham Broadway and Imperial Wharf.. There are also plenty of amenities nearby, including the famous Kings Road which offers a wide range of shops, restaurants and boutiques.

### Features

- Two Double Bedrooms
- Open Plan Kitchen Living
- Private Covered Parking Space
- Two Bathrooms
- First Floor Apartment
- Gated Complex

# Maltings Place, London, SW6

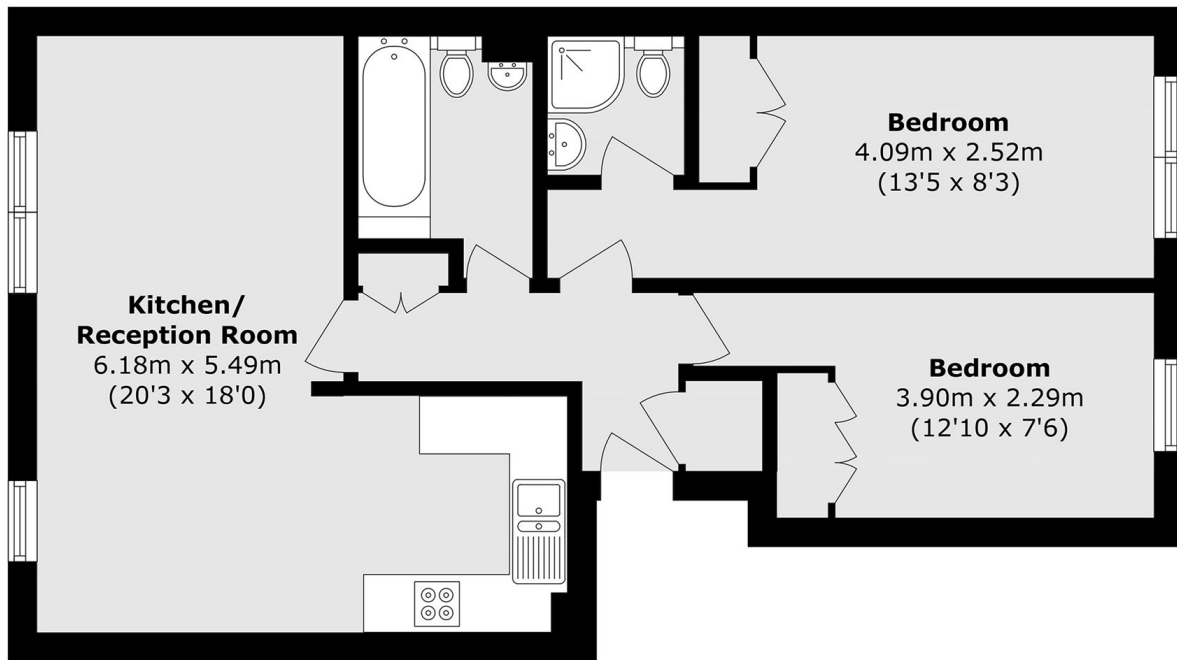

Total area (approx.): 63.0 sq. m (678.1 sq. ft)