



Eastbourne Avenue, W3

£1,003 pw (£3800.00 pcm)

A stunning four bedroom family home located on one of Acton's most desirable roads. Eastbourne Avenue offers three bedrooms and an additional large master bedroom on the top floor. The property also benefits from a large private garden, outbuilding and an en suite in the master bedroom.

Eastbourne Avenue is within 500 metres of the Elizabeth Line and 0.5 mile of Churchfield Road and Acton Central station.

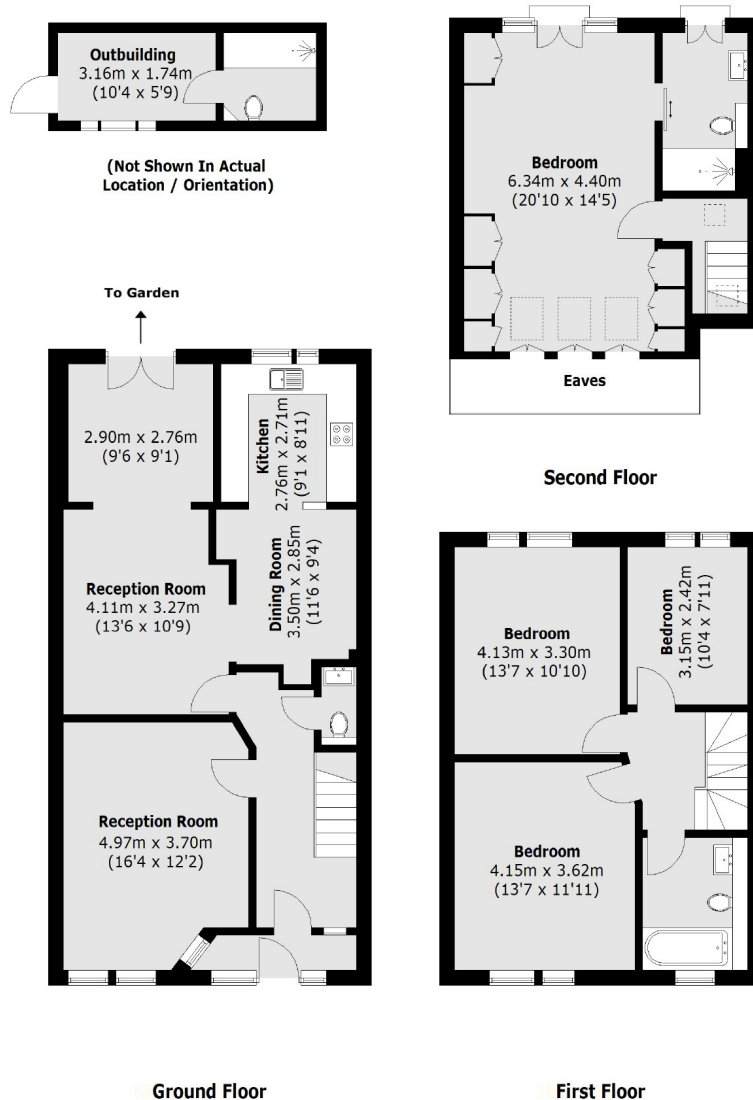

Total area (approx.): 155.4 sq. m (1,672.7 sq. ft)
(Excluding Eaves)
Outbuilding area: 9.0 sq. m (96.9 sq. ft)

Robertson Smith & Kempson Acton Lettings
137 High Street,
Acton, London, W3
020 8896 3967
actonlettings@robertsonsmithandkempson.co.uk

Energy Rating: C. We aim to make our particulars both accurate and reliable. However they are not guaranteed; nor do they form part of an offer or contract. If you require clarification on any points then please contact us, especially if you're traveling some distance to view. Please note that appliances and heating systems have not been tested and therefore no warranties can be given as to their good working order.