



Connells

Galbraith Close
Coseley Bilston



Property Description

Connells Wolverhampton are pleased to present to market this well presented semi detached home being sold with NO UPWARD CHAIN. The ideal choice for first time buyers, whilst being well located to local amenities and transport linking including Coseley train station. Viewing is highly recommended to appreciate this fantastic starter home, please call Connells Wolverhampton today to arrange a viewing.

Internally the property comprises of an entrance hall leading to a spacious 22ft lounge and fitted kitchen. Upstairs there are three well proportioned bedrooms and a modern wet room. Externally the property continues to impress with a generous size rear garden offering fantastic potential to create your idyllic outdoor space. There is also generous driveway to front providing ample off road parking.

Entrance Hall

Double glazed door to front, double glazed window to side, central heating radiator, stairs to first floor landing.

Lounge

22' 8" x 13' 11" max (6.91m x 4.24m max)
Double glazed window to front, two central heating radiators, gas fireplace, double glazed patio doors to rear leading to the rear garden.

Kitchen

11' 6" max x 5' 8" max (3.51m max x 1.73m max)

Two double glazed windows to side, a range of wall and base units with work surfaces, stainless steel sink and drainer, gas oven, gas hob, pantry/store cupboard.

Location & Area

Set to the south of Wolverhampton City Centre in the Coseley Area, the property is ideally situated for access to Birmingham New Road providing commuting links to Wolverhampton and Birmingham. Coseley Rail Station is only a short drive away.



First Floor Landing

Double glazed window to side, loft access, doors to various rooms.

Bedroom One

13' 3" x 9' 9" into wrobe excluding doorway (4.04m x 2.97m into wrobe excluding doorway)

Double glazed window to front, central heating radiator, fitted wardrobe.

Bedroom Two

11' 5" x 9' 2" (3.48m x 2.79m)

Double glazed window to rear, central heating radiator, fitted wardrobe.

Bedroom Three

10' 1" max x 7' 4" max (3.07m max x 2.24m max)

Double glazed window to front, central heating radiator, store cupboard.

Wet Room

Double glazed window to side, wc, wash hand basin, shower, extractor fan, central heating radiator, tiled walls, tiled flooring.

Outside Front

Driveway providing off road parking.

Outside Rear

Patio area, lawn, borders and shrubs, outdoor tap, brick built storage shed, gated side access.







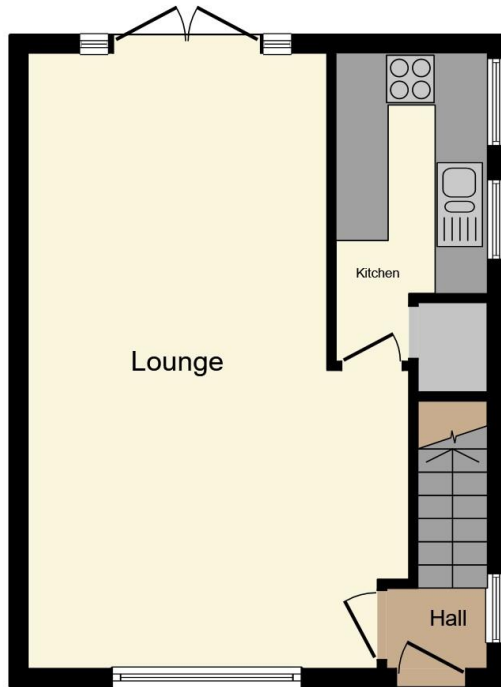

Ground Floor



First Floor

Total floor area 74.7 m² (804 sq.ft.) approx

This floor plan is for illustrative purposes only. It is not drawn to scale. Any measurements, floor areas (including any total floor area), openings and orientation are approximate. No details are guaranteed, they cannot be relied upon for any purpose and they do not form part of any agreement. No liability is taken for any error, omission or misstatement. A party must rely upon its own inspection(s). Powered by www.propertybox.io



To view this property please contact Connells on

T 01902 710 170
E wolverhampton@connells.co.uk

81-83 Darlington Street
WOLVERHAMPTON WV1 4EX

EPC Rating: D Council Tax Band: A

Tenure: Freehold

view this property online connells.co.uk/Property/WVH335144



1. MONEY LAUNDERING REGULATIONS Intending purchasers will be asked to produce identification documentation at a later stage and we would ask for your co-operation in order that there will be no delay in agreeing the sale. 2. These particulars do not constitute part or all of an offer or contract. 3. The measurements indicated are supplied for guidance only and as such must be considered incorrect. Potential buyers are advised to recheck measurements before committing to any expense. 4. We have not tested any apparatus, equipment, fixtures, fittings or services and it is in the buyers interest to check the working condition of any appliances.

Connells Residential is registered in England and Wales under company number 1489613, Registered Office is Cumbria House, 16-20 Hockliffe Street, Leighton Buzzard, Bedfordshire, LU7 1GN. VAT Registration Number is 500 2481 05.

See all our properties at www.connells.co.uk | www.rightmove.co.uk | www.zoopla.co.uk

Property Ref: WVH335144 - 0004