



## 72 Wilsdon Way, Kidlington, Oxon, Oxfordshire, OX5 1TX

£1,500 PCM - 8th July 2026

- Two double bedrooms
- White goods included
- Parking behind property
- Mains gas, electricity and water
- Mid terrace
- Gas CH
- EPC rating C
- Unfurnished
- Rear garden with shed
- Council Tax Band C

## 72 Wilsdon Way, Oxon OX5 1TX

A two bedroom mid terrace house in very good condition throughout and available unfurnished. Two minutes walk to local buses for City Centre, Oxford Parkway station and Headington hospitals. Two double bedrooms - one with fitted wardrobes, Bathroom with shower over, Fully fitted Kitchen with Lamona ceramic hob/electric oven, Fridge/Freezer, Washer/Dryer and LED strip lighting under wall units. Spacious Living/Dining room with wood laminated flooring. Gas CH, Paved rear garden with large shed and access to car park. Parking.



Council Tax Band: C





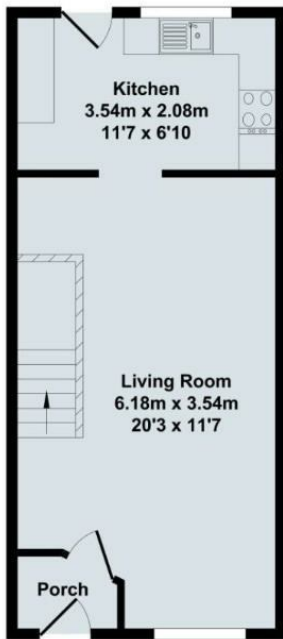

Ground Floor  
Approx. Floor  
Area 29.59 Sq.M.  
(319 Sq.Ft.)

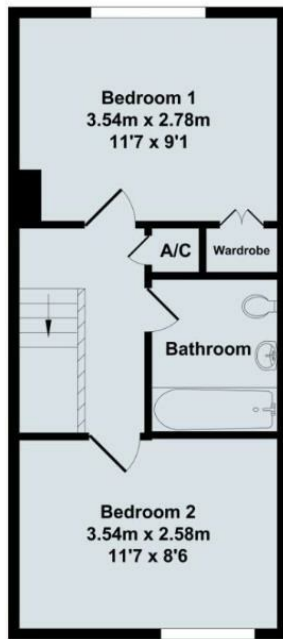

First Floor  
Approx. Floor  
Area 29.59 Sq.M.  
(319 Sq.Ft.)

Total Approx. Floor Area 59.18 Sq.M. (637 Sq.Ft.)

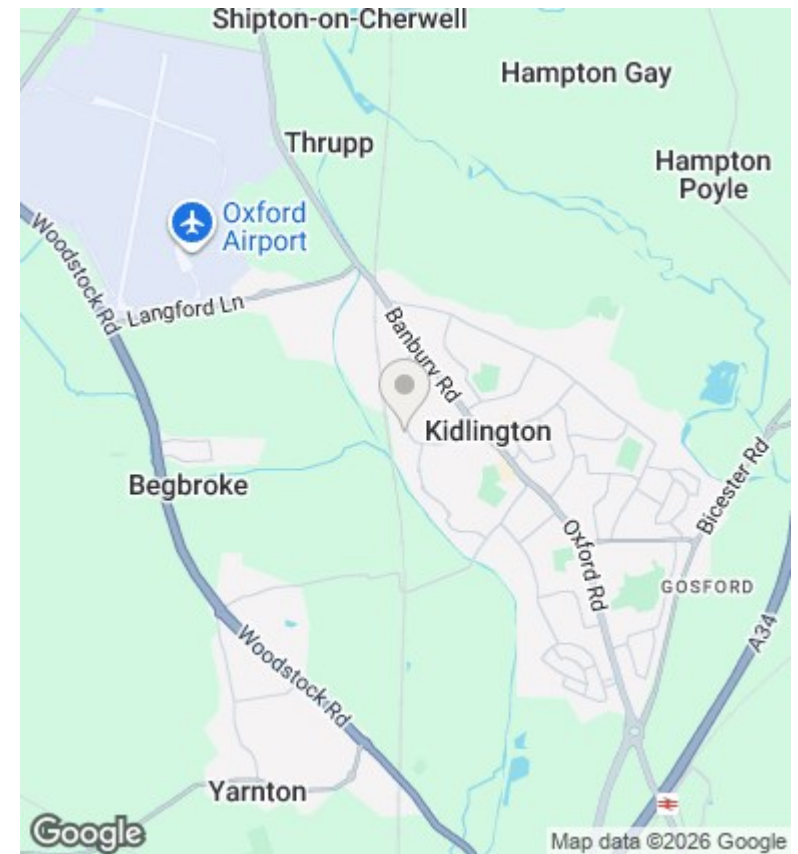

## Directions

## Viewings

Viewings by arrangement only. Call 01865 515900 to make an appointment.

## Council Tax Band

C

Energy Efficiency Rating		Current	Potential
<i>Very energy efficient - lower running costs</i>			
(92 plus)	A		91
(81-91)	B		
(69-80)	C	77	
(55-68)	D		
(39-54)	E		
(21-38)	F		
(1-20)	G		
<i>Not energy efficient - higher running costs</i>			
<b>England &amp; Wales</b>		EU Directive 2002/91/EC	