



Luscombe Maye

Since 1873

# Dart View House, Baltic Way, Totnes

Guide Price £295,000

🛏️ 2 🚿 1 🚗 1



## DESCRIPTION

Luscombe Maye are delighted to bring to market this well presented two double bedroom second floor apartment, in a desired location overlooking the River Dart. The property is located on a highly sought after private road with access to stunning river and woodland walks to Sharpham/Ashprington to the South and a short stroll to Totnes town to the North. This property has a open plan kitchen/dining/ lounge with an integrated fridge/freezer, washing machine, two double bedrooms and a luxury family bathrooms complimented by high ceilings and windows throughout allowing natural light to fill the rooms. The property benefits from a garage. An internal inspection of this beautiful home is highly recommended.

## DIRECTIONS

What3Words - [automate.verbs.necklaces](https://www.what3words.com/automate.verbs.necklaces)



**Dart View House, Baltic Way, Totnes, TQ9**

Approximate Area = 680 sq ft / 63.1 sq m  
 Garage = 826 sq ft / 76.7 sq m  
 Total = 1506 sq ft / 139.8 sq m

For identification only - Not to scale

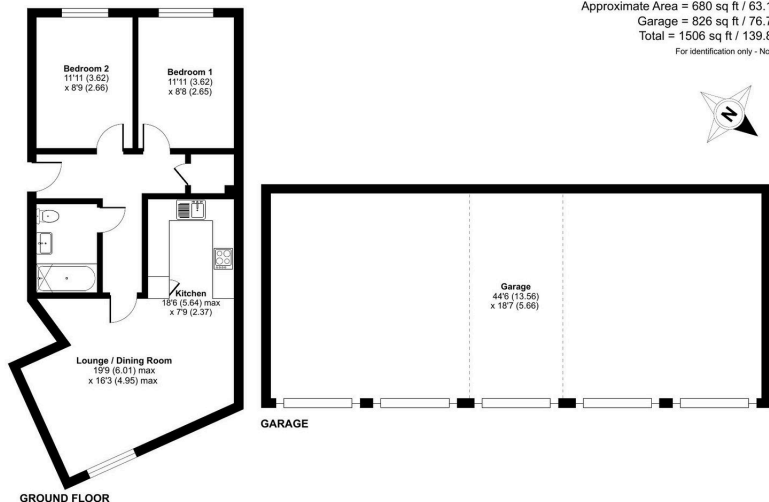

GROUND FLOOR

Floor plan produced in accordance with RICS Property Measurement 2nd Edition, incorporating International Property Measurement Standards (IPMS2 Residential). ©richcom 2025. Produced for Luscombe Maye. REF: 1345263



- No Forward Chain
- River Dart Views
- Open Plan Living/Dining/Kitchen
- Prestigious Development
- Town Centre Location
- High-End Waterside Apartment
- Garage and Parking
- Two Double Bedrooms
- Luxury Bathroom Suite



Use the QR code for further "Material Information" about this home

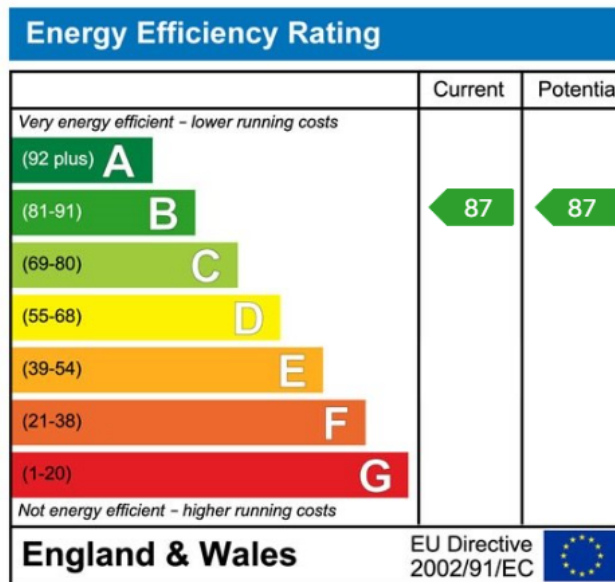

Important Notice: Luscombe Maye gives notice that: 1. These particulars do not constitute an offer or contract or part thereof. 2. All descriptions, photographs and plans are for guidance only and should not be relied upon as statements or representations of fact. All measurements are approximate and not necessarily to scale. Any prospective purchaser must satisfy themselves of the correctness of the information within the particulars by inspection or otherwise. 3. Luscombe Maye does not have any authority to give any representations or warranties whatsoever in relation to this property (including but not limited to planning/building regulations), nor can it enter into any contract on behalf of the Vendor.



**Totnes:**  
 59 Fore Street, Totnes TQ9 5NJ  
 01803 869920  
 totnes@luscombemaye.com  
[www.luscombemaye.com](http://www.luscombemaye.com)