



Portobello Road  
Notting Hill, W10

CHESTERTONS





Welcome to your new home in the heart of this vibrant neighbourhood! This charming first-floor apartment exudes character and style, with a period feel that is sure to impress.

The spacious one-bedroom property is flooded with natural light. The tall 3.17m high ceilings in its south-facing reception room and huge floor to ceiling sash windows, create a bright and airy atmosphere that you'll love coming home to each day.

Step inside and be greeted by a sophisticated interior that seamlessly blends modern convenience with classic charm. The well-equipped kitchen is perfect for whipping up delicious meals, while the peaceful bedroom offers a tranquil retreat at the end of a long day.

Located at the top of the famous Portobello Road, this stylish property is ideal for those looking to immerse themselves in the bustling local scene found at The Golborne Deli and Wine Shop, Strakers and The Fat Badger, while enjoying the comforts of a cosy home. Don't miss out on the opportunity to make this apartment yours book a viewing today.

- Charming first-floor apartment.
- Tall 3.17m high ceilings.
- Bright, south-facing reception room.
- Great location at the top of the famous Portobello Road, W10
- RBK&C Parking Permits available.

Asking Price £630,000

Score	Energy rating	Current	Potential
92+	A		
81-91	B		
69-80	C		
55-68	D	66 D	74 C
39-54	E		
21-38	F		
1-20	G		

**Tenure:** Leasehold. 101 years remaining.

**Service Charge:** £2,890 p.a.

**Ground Rent:** £300 p.a.

**Local Authority:** Kensington and Chelsea

**Council Tax Band:** C

*Chestertons Notting Hill Sales*

30 Ledbury Road

Notting Hill

London

W11 2AB

[nottinghill@chestertons.co.uk](mailto:nottinghill@chestertons.co.uk)

0203 040 8585

chestertons.co.uk

# Portobello Road, W10

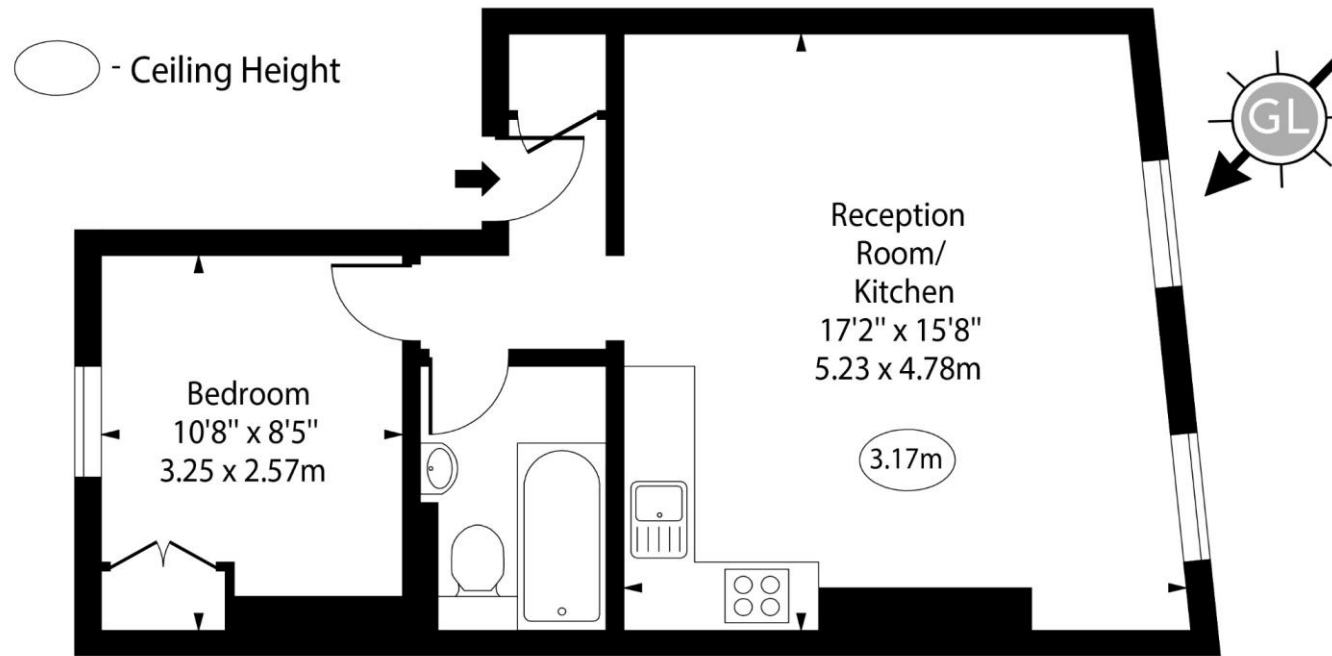

First Floor

Approx Gross Internal Area      448 Sq Ft - 41.62 Sq M

Every attempt has been made to ensure the accuracy of the floor plan shown.  
However, all measurements, fixtures, fittings, and data shown are approximate interpretations and  
for illustrative purposes only.

Measured according to the RICS IPMS 2. Not To Scale.

[www.goldlens.co.uk](http://www.goldlens.co.uk)

Ref. No. 028281E

