



Bethwin Road, SE5

£1,775 Per calendar month

A bright and spacious one-bedroom apartment set on the second floor of this development. The property offers generous living space throughout, featuring a well-proportioned double bedroom, a comfortable reception area, and plenty of natural light.

Ideally located close to Burgess Park, residents can take advantage of beautiful green open spaces, sports facilities, and scenic walking routes. The property is also well connected, with regular bus services to Elephant & Castle and into the City, making it an excellent choice for commuters.

Features

- One Bedroom
- Furnished
- Spacious
- Private Balcony
- Second Floor
- Burgess Park

Bethwin Road, London, SE5

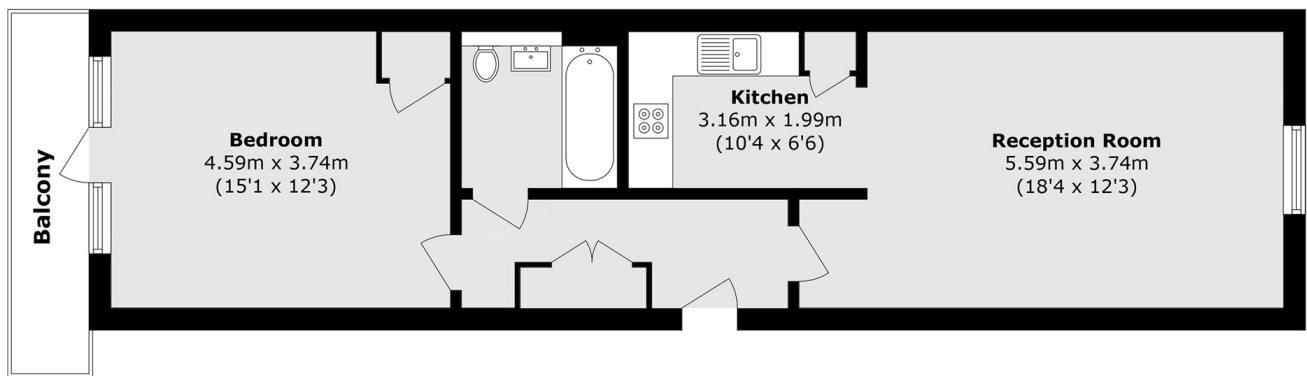

Total area (approx.): 59.3 sq. m (638.3 sq. ft)

Balcony area (approx.): 5.5 sq. m (59.2 sq. ft)