



Gray's Inn Road, Kings  
Cross, WC1X

£1,600 Per Month





# Gray's Inn Road, Kings Cross, WC1X

£1,600 Per Month



## Summary Description

Available now – bedroom flat in prime location!

This beautifully situated one-bedroom flat is just 2 minutes from King's Cross Station, offering incredibly easy access to transport links. The property features high ceilings, an open-plan lounge, double-glazed windows, and a spacious bedroom with ample storage.

Perfectly positioned, the flat is only 10 minutes from Euston Station and close to a wide selection of bars, shops, and restaurants. The property comes fully furnished and ready to move in.

EPC rating C, council tax band C, deposit one week's holding deposit, five weeks' damage deposit

To arrange a viewing, please contact Jorgensen Turner Estate Agents today

## Area Map

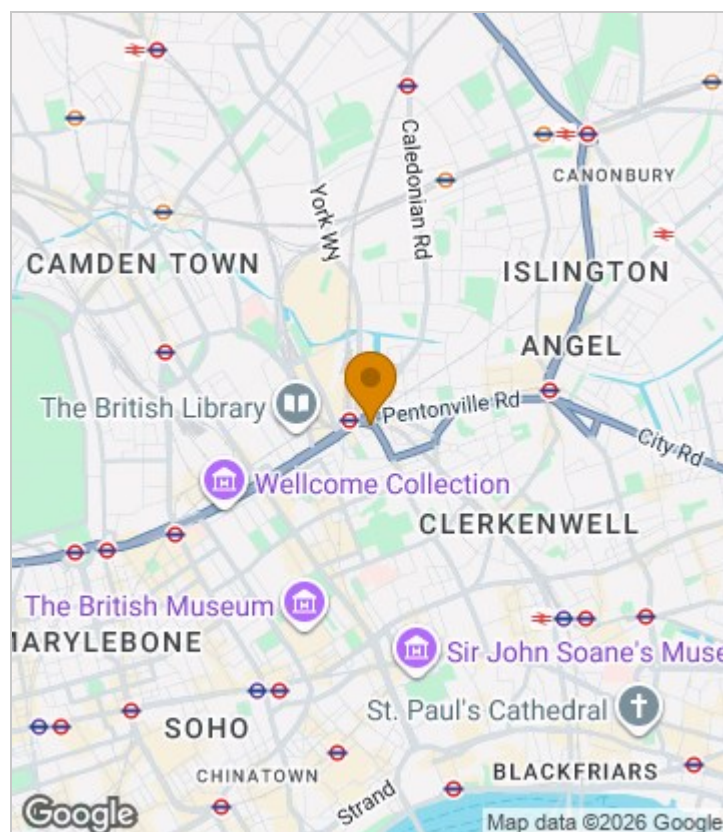





Floor Plan

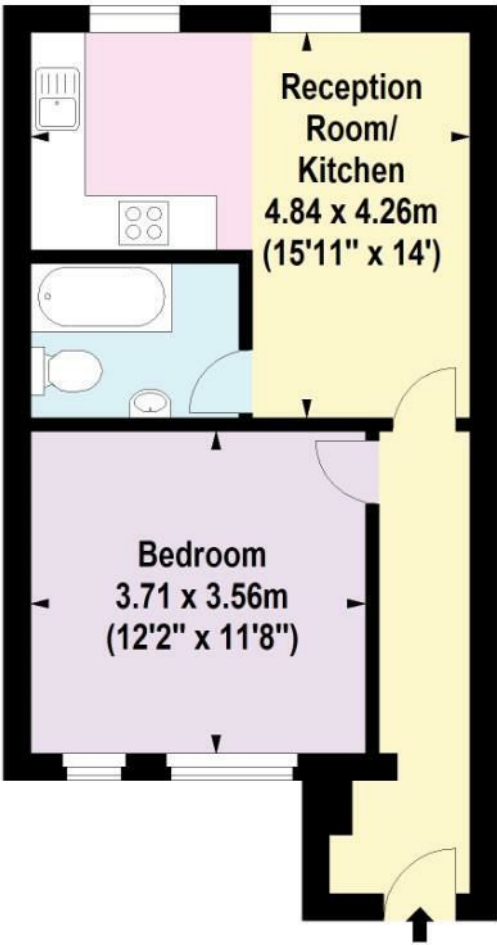

First Floor

For Identification Purposes Only. Not To Scale. © www.totalvista.uk 2026



Gray's Inn Road, WC1

Approx. Gross Internal Area  
40.97 Sq M - 441 Sq Ft



Energy Efficiency Graph

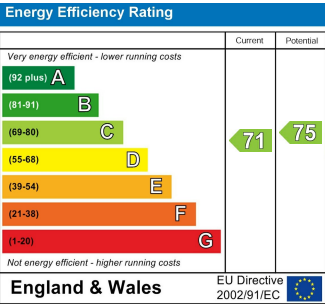

Viewing

Please contact our Lettings QP Office on 0207 604 4040 if you wish to arrange a viewing appointment for this property or require further information.

For further information contact:  
Lettings QP, 2a Brondesbury Road, London, NW6 6AS  
Tel: 0207 604 4040 Email: [info@jorgensenturner.com](mailto:info@jorgensenturner.com) <https://www.jorgensenturner.com/>



**Disclaimer**  
These particulars, whilst believed to be accurate are set out as a general outline only for guidance and do not constitute any part of an offer or contract. Intending purchasers should not rely on them as statements of representation of fact, but must satisfy themselves by inspection or otherwise as to their accuracy. No person in this firm's employment has the authority to make or give any representation or warranty in respect of the property.